

i121 FULL USER MANUAL

verykool

CONTENT

1. Warnings

Not following these simple guidelines may be dangerous or illegal. Read the complete user guide for further information.

TURN ON SAFELY

Do not turn on the phone when wireless phone is prohibited or when it may cause interference or danger.

ROAD SAFETY

Obey all road safety laws. Always use both of your hands to operate the vehicle while driving.

INTERFERENCE

All wireless phones may be sensitive to interference, which may affect performance.

TURN OFF IN HOSPITALS

Follow all restrictions. Turn off the phone near medical equipment.

TURN OFF ON AIRCRAFTS

Follow all restrictions. Wireless devices can cause interference on aircrafts.

TURN OFF WHEN REFUELING

Do not use the phone at/near refueling stations. Do not use near fuel or chemicals.

USE SENSIBLY

Only qualified personnel may install or repair this product.

ENHANCEMENTS AND BATTERIES

Use only appropriate enhancements and batteries. Do not connect incompatible products.

WATER-RESISTANCE

Your phone is not water-resistant. Keep it dry.

BACKUP COPIES

Remember to make back-up copies or keep a written record of all important information stored in your phone.

CONNECTING TO OTHER DEVICES

When connecting to any external device, read its user guide for detailed safety instructions. Do not connect with incompatible products.

2. Getting Started

2.1 Appearance



The Symbols above indicate:

1. Left Soft Key

2. Right Soft Key

5

3. Dial Key

4. End Key/Power Key

5. Navigation Keys

6. OK Key

7. Number Keys

8. Receiver

9. Speaker

10. Torch

11. USB Port

2.2 Keypad Definition

Key	Definitions
Left Soft key/ Right Soft key	<ol style="list-style-type: none"><li data-bbox="443 824 943 943">1. Execute functions that the left-down/right-down corner indicator shows.<li data-bbox="495 966 943 1234">2. In standby mode, press left soft key to access Menu, press right soft key to access Names.<li data-bbox="501 1272 891 1307">3. When keypad is locked,

	<p>press left soft key and right soft key to unlock.</p>
Navigation Keys	<ol style="list-style-type: none"> 1. In other modes, it is used as the navigation/direction key except for some special functions. 2. In the standby mode, press navigation keys to enter shortcuts functions.
OK Key	<ol style="list-style-type: none"> 1. In standby mode, press this key to enter main menu. 2. In the dial panel, after inputting numbers, press this key to do option. 3. In other mode, press this key for confirmation.
End Key/ Power Key	<ol style="list-style-type: none"> 1. Mainly used as power on/off. 2. Press to return to standby screen in any interface.

	<p>3. End calls or reject incoming calls.</p>
Dial Key	<p>1. Press this key to dial or receive an incoming call.</p> <p>2. In standby mode, press this key to access Dialed.</p>
Number Keys	<p>1. Use these keys to input numbers or letters.</p>
Torch Light Key	<p>1. In standby mode, long press OK key to turn on/off torch light.</p>
* Key	<p>1. After inputting phone number, quick press * key thrice, then the symbol “P” appears and input the extension number. You can make an extension call.</p> <p>2. In standby mode, long press * key to lock keypad.</p>
# Key	<p>1. In text editing interface, press # key to switch the text input method.</p> <p>2. Press and hold # key to transfer the profile of General/Silent/Meeting in standby</p>

mode.

2.3 Battery Installation

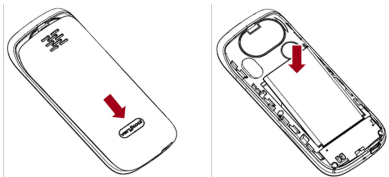

Caution: Install according to the illustration above to avoid breaking the battery connectors.

2.4 SIM Card/T-Flash Card Installation

** For Single SIM handset, you will only see one SIM on the image below. **

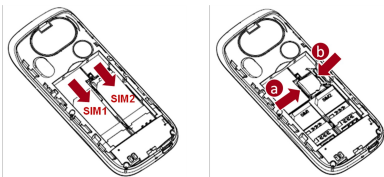

To install a T-flash card, please follow the steps:

Step a: Insert the T-flash card into the slot.

Step b: Put down the cover and slide it toward the left side.

Caution: Do not bend or scratch your SIM card and T-Flash card. Avoid exposing your SIM card and T-Flash card to static electricity, water, or dirt.

Tips: Face the gold color contact point of SIM card towards the cell phone and push the SIM card into the slot.

With the metal contacts facing down, gently slide the T-Flash card into the slot. Press and pull the cover up to lock it.

2.5 Charging the Battery

Insert the charger into USB interface of the phone.

Connect the charger to a standard wall outlet and the battery power icon in the up-right corner of the screen will start scrolling. When the battery bar stops scrolling, the battery charge is complete. Press the two sides of the charger plug and disconnect the charger from the phone.

- When the battery is low, a “low battery” message will display across the screen and the battery icon will seem empty. If the battery level is insufficient, the phone will turn off automatically. Do not use your phone under low battery state for an extended period of time or it may cause battery damage.

2.6 Security Settings

— PIN code

PIN code (Personal Identity Number) prevents unauthor-

ized use of your phone. The **PIN** code is provided by your network operator with the **SIM** card.

If you enter the wrong code three times in a row, the **PIN** code will be blocked. To unblock the **PIN** code, you need to enter your PUK. Your PUK is provided by your network operator.

— **Power on Password**

Activate/Modify/Deactivate power on password (the length of the password is 4-8 digital numbers). If you activate the “Power on pwd”, you need to enter the password each time you turn on the phone. If you want to modify the Startup password or deactivate power on password, enter Modify/Deactivate option to set.

2.7 T-flash Card

Insert the T-Flash card into phone. This will expand the Flash memory of the phone.

2.8 USB Cable

You can transfer and store files, such as MP3, MP4 and pictures from PC, through USB cable, to the mass storage in phone or identified SD card that is inserted.

3. Basic Functions

3.1 Making a Call

In standby mode, press numerical keys to input phone number to dial. If you're making a long distance call, add the area code preceding the telephone number. After inputting phone number, quickly press * key thrice until the symbol "P" appears, then input the extra number. You can also press OK key to access option. During a call, press the navigation keys to adjust the volume.

3.2 Emergency Service

You can dial an emergency call without the SIM card. Contact your service provider to get the emergency call number.

3.3 Answering a Call

When you receive a call, the phone will ring or vibrate and will display an incoming call indicator. Press the Dial key, left soft key, OK key to answer. During the calling, you can press left soft key to access Option: Turn on handfree, Shuttle, Phonebook, Messages, Call history, Start recording, Mute, and DTMF on/off.

3.4 Rejecting a Call

You can press end key to reject or end a call.

4. Guide to Menu Operations

4.1 Call History

In the call history menu, you can check dialed calls, received calls, missed calls, etc.

- Dialed: Display the latest dialed calls list.
- Received: Display the latest received calls list.
- Missed: Display the latest missed calls list.
- Rejected: Display the latest rejected calls list.
- Delete all: Delete all records.
- Call time: Display the call time record of SIM1 and SIM2.

4.2 Phone Book

In the phone book, you can store contacts' personal information and numbers while also search for previously stored contacts. Press left soft key to access Option:

- Add new: To add a new record into phone book
- Search: To search record names in the phone book
- Send SMS: Send SMS to the number.
- Call: Select SIM1/2 to call the number
- Delete: To delete the record
- Mark: Mark the phone number, you can select to mark one or mark all.
- Copy: You can copy the record to SIM cards and phone.
- Move: Move the contacts between SIM cards and phone
- Others: Speed dial setting/ Own number/ Memory query/ Double (Single) line display

4.3 Alarm

The alarm clock feature sounds an alert or makes a vibration alert at a time you specify. There are 3 alarm clocks

can be edit and set.

4.4 Multimedia

4.4.1 Audio Player

This function menu is used to store and play the audio files. Press the left soft key or OK key to enter and then use the left/right navigation keys and OK key to operate audio player. Press * key and # key to adjust volume. Press left soft key you can access Option.

4.4.2 Video Player

Preview the videos. Press * key and # key to adjust volume. Press navigation keys to select and OK key confirm to enter. Press left soft key to access to “List”, then press left soft key again to access Option.

4.4.3 FM Radio

Enter FM radio (insert earphone). Press left/right navigation key to change frequency, press * key and # key to adjust volume. Press the left soft key to access Option. Select “Off” to turn off the radio.

4.4.4 Sound Recorder

You can take a recorder in this function. From the left to the right: Play/Pause, Stop, Record/Recording Pause, Record File list. Use * key and # key to adjust the volume.

Press OK button to record. After record, press left soft key to access Option: Audition, Record again, Delete, Send, and Record file list. After entering the record file list, select one file, press left soft key to access Option.

4.5 Messages

4.5.1 Write Message

This function can begin a new message. After completing

the message, press left soft key to access to option:

- Send: Input number or press left soft key to access to “Name”. Select SIM1 or SIM2 to send the message.
- Writing language: Select writing language.
- Insert template: Select a template to insert to the message.
- Contact info: Insert a number to the message.
- Add phiz: Select a phiz to insert to the message.
- Save: Save the edited message to draftbox.

4.5.2 Inbox

After entering the Inbox, press up/down navigation key to select messages. Press OK key to check the details of message, or press left soft key to access Option.

4.5.3 Outbox

Checks the information of unsuccessfully sent message in outbox. Press left soft key to access to Option.

4.5.4 Draftbox

You can save unsent and edit incomplete messages in draftbox. Press left soft key to access to Option.

4.5.5 Sentbox

Check the message in sentbox. Select one message to open, or press left soft key to access Option.

4.5.6 More

4.5.6.1 Templates

Press up/down navigation key to select a template. You can edit, send, or turn back to upper menu.

4.5.6.2 Voice Mail

This function needs a network supply. Please contact with

your service provider for more information. Select SIM1 or SIM2, you can enter Line 1 number, Line 2 number, Fax number, and Data number.

4.5.6.3 Broadcast

- Read: Read broadcast
- Startup: Select Turnon/Deactivate
- Channel: Check channel list
- Language: all language, English, etc

4.5.6.4 SMS Settings

To set parameters related to SMS.

4.5.6.5 Memory Status

Check the message memory of SIM cards and phone.

4.5.6.6 SMS Count

Check amount number of sent and received SMS.

4.6 Organizer

4.6.1 Calendar

You can use this feature to view the year, date easily. Use navigation keys to navigate other date.

4.6.2 Bluetooth

This mobile phone support Bluetooth wireless connection. You can establish wireless connection between mobile phone and device to realize voice communication, data exchange and synchronization. Press left soft key or OK key to enter: Open/Close bluetooth, Bluetooth visibility, Paired device, My bluetooth name, and Bluetooth file location.

4.6.3 Calculator

This feature can use your phone as a calculator for simple calculations. Press number keys to enter the numbers. Use following keys to calculate :

Navigation keys: +, -, ×, ÷

OK key: Show the calculation result.

* Key: Decimal point

4.7 Pastime

4.7.1 Picture Browser

Enter picture browser, you can choose photos to view or return. Press left soft key to access to Option: Change folder, Send, Slide play, Delete, Rename, Mark, Detail and Slide setting.

4.7.2 E-Book Reader

Read E-Book stored in memory card. Select one txt file to open, and then press left soft key to access Option: Add bookmark, See bookmark, Jump to start, Jump to end, Jump to percent, and Turn on/off backlight. Press right soft key to back to the TXT file list, use up/down navigation keys to select the TXT files. Then press left soft key to access Option.

4.7.3 Snake

Your phone supplies Snake; you can play the game whenever you want.

4.8 File Manager

Enter this menu; you can check the files store on memory card. Select one file and press left soft key, you can do option.

4.9 Settings

4.9.1 Call

- **Dual SIM Setup**

Set the parameters related to dual SIM.

- **Network Select**

This function can let you select the network manually or automatically. Select SIM1/SIM2 and then access:

- **Auto Select:** Press the left soft key and confirm, the mobile phone will search various networks. This operation will let your phone register the most suitable network.
- **Manual Select:** Press the left soft key and confirm, the mobile phone will search various networks. You can select the suitable network from the listed networks.

— **Call Divert**

When the call divert is activated, incoming calls will be diverted to voice mail or other phone numbers according to the call divert settings.

— **Call Barring**

When the call barring is activated, some of the calls will be barred according to the call barring setting condition. Contact your service provider to sign up for call barring.

— **Call Waiting**

Set the mode of call waiting, this function need to be activated.

— **Hide ID**

To set whether hide your ID.

— **Line Switching**

To select Line 1 or Line 2.

— **Flight Mode**

You can do the settings: Active or Select When Power On.

— **More**

• 50 Secs Warning

Set: Activate/ Deactivate.

• Answer/Reject Mode

Set: SMS reply after reject/ anykey answer

• Auto Redial

Set: Activate/ Deactivate.

• Call Limiter

To limit the call duration. When set the function activated,

input time (1-9999s) to set the limiter.

4.9.2 Phone

— **Time & Date**

You can set time, set date, time display type, and date display type.

— **Language**

You can choose several languages under this function.

— **Set Shortcut**

You can select different functions for shortcuts.

— **Schedule Power On/Off**

You can set Auto Power On and Auto Power Off of: Time, Mode (Once/Every Day/ Every Week).

— **Power Management**

To check battery capacity here

— **Restore Factory**

Input default password 1234 to restore factory settings.

— **Torch**

Select Activate or Deactivate to turn on/off torch .

4.9.3 Display

— **Wallpaper**

You can set wallpaper under this function.

— **Idle Display**

You can choose the items list under this function. This can be multiple selected.

— **Contrast**

Press left/right navigation keys to adjust contrast, and then press left soft key or OK key to confirm.

— **Backlight**

Set Backlightness and Time here.

— **Keypad Light**

Set keypad light or deactivate.

— **Animation Effect**

You can set animation effect of power on animation, power off animation.

4.9.4 Security

— **PIN**

- PIN number setting can avoid unauthorized usage of SIM card.
- If PIN number has been wrongly inputted for 3 times, the SIM card will be locked. PUK number is needed to unlock the SIM card. Please contact the network provider if you don't know the PUK number.
- The default setting PIN number is provided by the network operator, please set your own PIN number as soon as you receive the phone.

— **PIN2**

You can modify the PIN2 number here.

— **Privacy Protect**

Set a password for your phone to protect some functions.
The default password is 1234.

— **Auto Key**

You can set the time to lock the keypad automatically.

— **Red Key Locks Keypad**

After setting for activate, by pressing red key in standby mode to turn off the screen and lock keypad.

— **Power on Pwd**

Set the password for power on.

4.9.5 User Profiles

This phone provides several profiles, by pressing left soft key or OK key, you can enter option to set: Active, Settings, and Rename.

5. Entry Mode

You can use several methods for entering text and numbers. By selecting a Text Entry Mode, the phone provides a few Text Entry Mode for new adding, editing contact records, finding contacts, editing SMS and writing memos.

Select Text Entry Mode:

5.1 Letter entry mode

Press a key once to insert the first letter on the key, twice for the second letter, etc. If you pause briefly, the last letter in the display is accepted and the text awaits the next entry. For example, press the "2" key continuously, it will appear "a", "b", "c", "2" one by one.

5.2 Number entry mode

Number Entry Mode can input the number in the text, such as telephone number. Tap the proper number and input it.

6. Care and Maintenance

Battery care

- Your device is powered by a rechargeable battery. When the power is weak, please charge the battery. In order to extend the lifespan of the battery, use all the battery's power before recharging.
- Unplug the charger from the electrical plug and the device when not in use. Do not leave the battery connected to a charger more than a week. Overcharging may shorten its lifespan.
- Extreme temperatures can affect the ability of your battery to charge. Battery needs the fit temperature. If the surrounding temperature is over 40°C, the battery cannot be

charged.

- Use the battery only for its intended purpose. Never use any charger or battery that is damaged.

Do not short-circuit the battery. Accidental short-circuiting can occur when a metallic object such as a coin, clip, or pen causes direct connection of the positive (+) and negative (-) terminals of the battery. (These look like metal strips on the battery.) Short-circuiting the terminals may damage the battery or the connecting object.

- Leaving the battery in hot or cold places, such as in a closed car in summer or a freezer in winter conditions, will reduce the capacity and lifetime of the battery. Always try to keep the battery between 59°F and 77°F (15°C and 25°C). A hot or cold battery may not function temporarily, even when the battery is fully charged.
- Battery performance is particularly limited in temperatures below freezing.

- Do not dispose of batteries in a fire! Dispose of batteries according to local regulations. Please recycle when possible. Cell phones are not considered household waste.

Mobile phone maintenance

- Keep the device dry. Precipitation, humidity, and all types of liquids or moisture can contain minerals that will corrode electronic circuits. If your device does get wet, remove the battery and allow the device to dry completely before replacing it.
- Do not use or store the device in dusty, dirty areas. Its moving parts and electronic components can be damaged.
 - Do not store the device in hot areas. High temperatures can shorten the life of electronic devices, damage batteries, and warp or melt certain plastics.
 - Do not store the device in cold areas. When the device returns to its normal temperature, moisture can form inside the device and damage electronic circuit boards.

- Do not attempt to open the device other than as instructed in this guide.
- Do not drop, knock, or shake the device. Rough handling can break internal circuit boards and fine mechanics.
- Do not use harsh chemicals, cleaning solvents, or strong detergents to clean the device.
- Do not paint the device. Paint can clog the moving parts and prevent proper operation.
- Use only the supplied or an approved replacement antenna. Unauthorized antennas, modifications, or attachments could damage the device and may violate regulations governing radio devices.

All of the above suggestions apply to your device, battery, charger, or any enhancement. If any device is not working properly, take it to the nearest authorized service facility for service.

7. Technical Information

Weight: 105g (with battery)

Size: 109 × 44 × 13.2mm

Battery: 1650mAh

Networks: GSM

Battery work times refer to the list below (Will not announce if the capacity is changed):

The operation time of the battery depends on conditions such as:

- Transmitting power level
- Signal (distance between the phone and the base station)
- Network parameters defined by the operator
- Phone use (WAP, games, SMS)
- Charging procedure used

Exclusions:

Subject to the exclusions contained below:

1. Damage due to the improper use.
2. User does not follow the manual.

Explanation:

The company has the final right of the explanation for this document.

Software upgrades will not be announced.

All the configurations mentioned in this user manual is only for reference; please refer to the actual phone.

FCC RF Exposure Information and Statement

The SAR limit of USA (FCC) is 1.6 W/kg averaged over one gram of tissue. Device types I121 (FCC ID: WA6I121) has also been tested against this SAR limit. The highest SAR value reported under this standard during product certification for use at the ear is 0.296 W/kg and when properly worn on the body is 0.221 W/kg. This device was

tested for typical body-worn operations with the back of the handset kept 1.5cm from the body. To maintain compliance with FCC RF exposure requirements, use accessories that maintain a 1.5cm separation distance between the user's body and the back of the handset. The use of belt clips, holsters and similar accessories should not contain metallic components in its assembly. The use of accessories that do not satisfy these requirements may not comply with FCC RF exposure requirements, and should be avoided.

FCC WARNING

This device complies with Part 15 of the FCC Rules. Operation is subject to the following two conditions:

- (1) This device may not cause harmful interference, and
- (2) This device must accept any interference received, in-

cluding interference that may cause undesired operation.

NOTE 1: This equipment has been tested and found to comply with the limits for a Class B digital device, pursuant to part 15 of the FCC Rules. These limits are designed to provide reasonable protection against harmful interference in a residential installation. This equipment generates, uses and can radiate radio frequency energy and, if not installed and used in accordance with the instructions, may cause harmful interference to radio communications. However, there is no guarantee that interference will not occur in a particular installation. If this equipment does cause harmful interference to radio or television reception, which can be determined by turning the equipment off and on, the user is encouraged to try to correct the interference by one or more of the following measures:

- Reorient or relocate the receiving antenna.

- Increase the separation between the equipment and receiver.
- Connect the equipment into an outlet on a circuit different from that to which the receiver is connected.
- Consult the dealer or an experienced radio/TV technician for help.

NOTE 2: Any changes or modifications to this unit not expressly approved by the party responsible for compliance could void the user's authority to operate the equipment.

NOTE 3: The manufacturer is not responsible for any radio or TV interference caused by unauthorized modifications to this equipment. Such modifications could void the user's authority to operate the equipment.