



User Guide

Thank you for choosing the Pantech Pursuit, our latest touch with QWERTY slide mobile phone.

The Pantech Pursuit has many features designed to enhance your mobile experience. From its unique, stylish design and full touch with QWERTY keypad, we know you will enjoy the entire Pursuit experience. This User Guide contains important and useful information that will maximize your familiarity with all that the Pantech Pursuit has to offer.

Specifications

Design

Touch QWERTY Slider

Displays

- 262k colors TFT LCD with 2.8" display
- 320*240 resolution

Melodies

MP3, MIDI, iMelody, MMF, WAV, SMAF, AAC+

Camera

Integrated 2M CMOS Camera

- Resolution up to 1600 x 1200 (1,920,000 pixels)
- Mpeg4 Video recording/playing up to 15f/s(QVGA size)
- Self-timer function (5 seconds or 10 seconds)
- Photo album and video album

Dimensions & Weight

- Weight: 130g/4.58oz (with standard battery)
- Dimensions: 93.4 mm x 64.0 mm x 14.1 mm
3.67" x 2.51" x 0.58"

Power Management (Performance)

Battery Type	Capacity	Standby Time	Talk Time
Standard Lithium-Ion (Li-ion)	1000 mAh	11days (270hrs)	3(4.8)hours

Operating Frequency





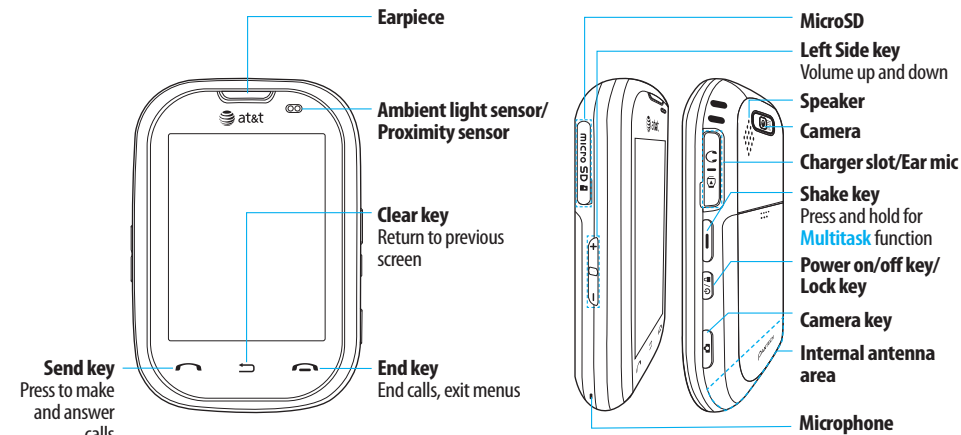

- GSM 850Mhz, GSM 900Mhz, GSM 1800Mhz, GSM 1900Mhz, UMTS 850Mhz and UMTS 1900 Mhz networks in North America, South America, Europe, Africa, and Asia-Pacific where these networks are supported.
- Automatic band switching.

Phone overview

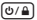
Numeric mode view



note: Holding the device by the internal antenna area might affect the quality of all calls.

Keys	Functions
	Turn on or off the phone if pressed and held. Quickly lock the phone if pressed shortly.
	Delete characters from the display, or return to previous menu.
	Access Recent Calls or dial the last number if tapped and pressed
	Complete the current call. Turn on/off the phone if tapped and held. Cancel user input and return to main screen while in Menu mode.
	Adjust the earpiece volume while making a call. Control the Ringtone volume, vibrate mode and silent all mode in standby. Mute the ringtone of an incoming call.
	Quickly access Multitasking. Access for Music Player , Mobile Web or App Manager if pressed while phone is shaken.





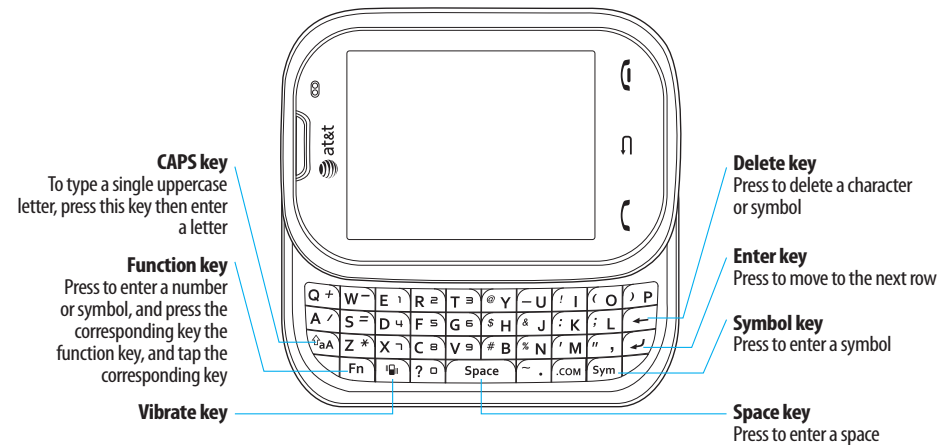



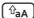

Keys	Functions
	Turn camera capture mode on. Switch cameras if pressed during camera mode. Work as a camera shutter in capture mode.

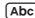

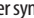

QWERTY mode view

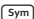

note: To use the QWERTY keypad hold the phone horizontally and slide the screen up.

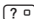
Your phone has a QWERTY keypad which provides a superior typing experience on a small handheld for easy and comfortable texting. You can use all of the phone functions with the QWERTY keypad.

Keys	Functions
	Press to change ab Ab AB at the text editing screen    (lower caps / first letter caps / all caps)
	Press to enter a special character or number. To enter symbols and numbers continually, tap until  displays
	Enter the space character in text input mode
	Insert an enter in text input mode
	Delete a character to the left of the text cursor in text editing screen
	Press to type a special character that is not placed on the keypad
	Quickly connect to the voice mail server if pressed while in standby mode.

Keys	Functions
  ~ 	Enter numbers, letters or special characters. Go to the dial screen if pressed in standby mode.
	Enter or exit from vibrate mode if pressed and held in standby mode. Show the symbol input screen if pressed in text input mode.
	Enter an international dialing prefix if pressed in standby mode.

Menu overview



AT&T Navigator



YPmobile



Mobile Web



Messaging

Inbox
Create Message
Mobile Email
IM
Outbox
Drafts
Voice Mail
Settings
Templates
Used Space



Mobile Email



AT&T Social Net



Address Book

My Settings
All contacts
Favorites
Groups



AppCenter



IM



Games

Shop Games
Tetris
Diner Dash Flo on the Go
Bubble Bash2
TextTwist 2
Rolling with Katamari by
Namco



Apps

Shop Applications
Shop GPS
MobiTV
AllSport GPS
My-Cast Weather
AT&T Social Net
Mobile Banking
FunScreenz
PicDial
Mobile Web
Hip Hop Official by GoTV
Movies Powered by IMDb
Browser



AT&T Music

Music Player
Shop Music
AT&T Radio
Shazam
Music Videos
Community
Music Apps



Shop GPS



Where



AT&T FamilyMap



Mobile Video



Facebook



MySpace



My Stuff

Applications
Audio
Games
Picture
Video
Tools
Other Files
Used Space



Tools

Recent Calls
Drawing Commander
Camera
Video Camera
Media Player
Alarm Clock
Calendar
Notepad
Sketch Pad
Voice Memo
World Time
Calculator
Tip Calculator
Converter
Stop Watch
Timer



Settings

Profiles
Display
Call
Phone
Touch
Connectivity
Security^s
AT&T Software Update
Reset
TTY
Phone Information



Camera



Picture

Shop Wallpapers
Images
Camera
Sketch Pad
Face Tagging



Video

Shop Videos



Bluetooth

Settings
Search
My Info



Alarm



My Account

^s SIM dependent ⁿ Network dependent

Contents

Specifications.....	2
Phone overview	3
Menu overview	7

1. Getting Started

SIM card and battery	18
Turning the phone on/off.....	19
Screen unlock	20
Language.....	20
Essential display indications.....	20
Screen navigation.....	21
Missed events	23
Memory card	23
Drawing commander	24
Shake function.....	25
Using the multitask menu	25
Updating software	26

2. Calls and address book

Making, receiving and ending calls	30
Using video share	31
Options during a call	32
Call settings	34

Checking all calls	34
Speed dialing.....	35
Using the address book.....	35
Address book settings	36
Caller identification	37
Using your headset.....	37
Service numbers and fixed dialing.....	37

3. Messaging

Entering text.....	40
Messaging	41
Receiving messages	42
Creating and sending text messages.....	43
Creating multimedia messages ...	43
Message templates	45
Message settings	46
Email	47
Using instant messenger.....	47

4. Multimedia

Camera.....	50
Photo album.....	53
Video album	54
Audio album.....	55
Music Player.....	56
Music player settings.....	58
Media player	59
Other files	60
Managing memory	60
Playing games	61

5. Useful Features

Alarm	64
Calendar.....	64
Notepad and voice memo.....	65
World time.....	66
Calculator, tip calculator and converter	66
Stop watch and timer.....	67

Sketch pad	67
Memory information.....	68

6. Connectivity

Bluetooth.....	72
Accessing the web	73
Using the web browser	74
Profile settings	75

7. Settings

Phone	78
Ring tones	78
Display	78
Touch	79
Locks	80
Reset	80
TTY	81

8. Appendix

Alert message.....	84
--------------------	----

Troubleshooting checklist	84
Safety information	85
Safety precautions.....	86
About the battery usage	86
FCC Hearing-Aid Compatibility (HAC) Regulations for Wireless Devices.....	87
FCC Regulatory Compliance	89
Warranty.....	90

1

Getting Started

- SIM card and battery
- Turning the phone on/off
- Screen unlock
- Language
- Essential display indications
- Screen navigation
- Missed events
- Memory card
- Drawing commander
- Shake function
- Using the multitask menu
- Updating software



pursuit™

SIM card and battery

About your SIM card

When you subscribe to your network operator, you receive a SIM (Subscriber Identity Module) card containing your registration information, PIN code, etc.

Like a credit card, it should be kept secure and handled carefully. Do not bend, scratch or expose it to moisture. Avoid static electricity.

To avoid corrupting your SIM card's memory, always switch off your phone before removing or inserting your SIM card.

About your battery

Your phone uses a Li-Ion battery. Make sure to use an authorized battery and charger only. For more details, please inquire at your nearest dealer.

note: Your phone is powered by a Lithium Ion (Li-Ion) battery. Unlike other forms of battery technology, you can recharge your battery while some charge remains without reducing your phone's autonomy due to the "battery memory effect" inherent in those technologies.

Installing/removing SIM card and battery

1. Remove the battery cover from the unit.

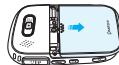

2. To fit the battery cover, put it on the guide rail and push up.

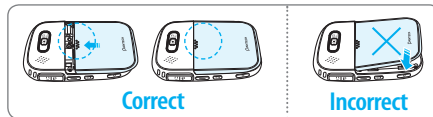

3. Insert the SIM card into the slot. The gold contacts of the SIM card should go against the metal contacts of the phone. Put the connector of the battery into the hole located at the top of the unit and then insert and press the lower side of the battery until you hear the light click. Make sure you align the gold contacts at the battery end with contacts on the phone. If the contacts at the battery are not properly aligned, damage could occur to the phone and the battery.

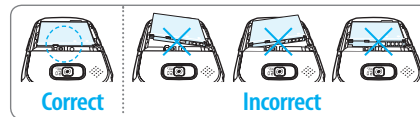
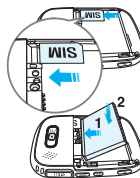

4. To remove the battery push the bottom of the battery upwards (1) and remove (2) the battery. Push the SIM card in the direction of the arrow as shown.



To charge your battery

1. To charge, open the protective cover on the top right side and connect the charger adapter. Make sure you align the connector as the image. If not, it will damage the charging connector on the phone and will not charge.

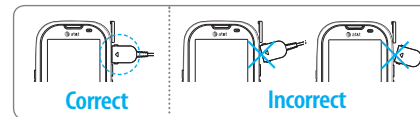
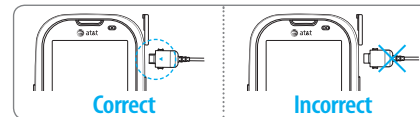

2. To remove the adapter connection press the adapter's side buttons (1) and pull the adapter away (2).

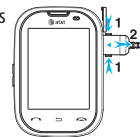

Turning the phone on/off

To turn on

1. Press and hold .

To turn off

1. Press and hold .

Screen unlock

Unlocking the screen





1. Press any hard keys to turn on the display.
2. Tap and hold  to unlock the screen.

















Language





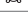











Setting up



1. Tap **Menu**  > **Settings** > **Phone** > **Language**.
2. Select **Screen Text** or **Predictive**.
3. Select the language > **Save**.

Essential display indications

	Signal strength. The greater the number of bars, the stronger the signal. When network is in searching mode  is displayed
	A call is being made. When you are in no service area  is displayed

	Call forwarding ^a is active
	Incoming calls set to ring only (Normal)
	Incoming calls set to Outdoor
	Incoming calls set to Vibrate Only
	Incoming calls set to Silent
	Flight Mode is active
	Received one or more text messages
	Received one or more multimedia messages
	Received one or more WAP push messages
	Received one or more configuration messages
	Received one or more voice messages
	A message is being sent
	A message is being received
	An alarm is set
	Schedule Alarm is set
	Browser is Active, Secured and being downloaded
	Bluetooth is active

	Bluetooth hands-free headset is connected
	Bluetooth A2DP headset is connected
	Bluetooth hands-free + A2DP headset is connected
	Data transfer via Bluetooth
	Headset is connected
	USB is connected
	TTY is active
	A GPRS signal is available. It is displayed when there is an active GPRS session
	An EDGE signal is available. It is displayed when there is an active EDGE session
	A 3G signal is available. It displayed when there is an active 3G session. ^a
	microSD card is inserted
	Battery strength When the battery charge is low,  is displayed
	Available, Away, Invisible Status of AIM
	Online, Away, Busy, Offline Status of MSN
	Available, Busy, Invisible Status of YAHOO

	You have received one or more IM messages
	BGM is play, pause and being stopped

^a Network dependent

Screen navigation

The home screen is your starting point for using the applications on your phone.

You can customize the home screen to display application icons, shortcuts, folders, and widgets according to your preference.

About your home screen

- **Main screen:** The phone's main home screen.
- **Apps screen:** Provide operators and users apps menu that you want to register. Max 24 icons can be added.
- **FAVs screen:** Widget content is stored on the screen as items. Max 15 icons can be added.

01

02

03

04

05

06

07

08

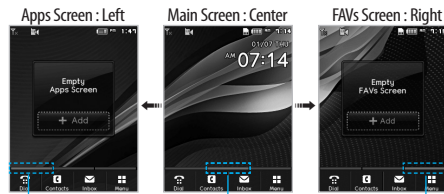

Position indicators

note: You can access 3 different types of home screens by flicking one way. However, the position indicators are always displayed for the corresponding home screen (i.e. Left – Apps, Center – Main, Right – FAVs).

Adding a home screen item

Apps and FAVs screens allow you to assign items to the screen.

1. Tap **Add** +.
2. Tap a desired menu.
3. Once you have added one or more items to the screen, **▶** or **◀** is displayed to customize the home screen.



Deleting a home screen item

1. Tap the **◀** or **▶**.
2. Select and hold an item, until the + appears.
3. Drag to the trash can.

note: This action is only applied to the home screen. To delete all the items on the screen, tap **◀** or **▶** > **Delete All** X.

Repositioning a home screen item

Once the items are assigned to the home screen, you can reposition the items for your convenience.

1. Select an item.
2. Drag to the desired position.
3. Position the item, then release it.



Mini Map

Navigating through menus

Pursuit has 3 different menu screens to provide quick access to menus.

1. Tap **Menu** .
2. Flick the screen from left to right or right to left to navigate.

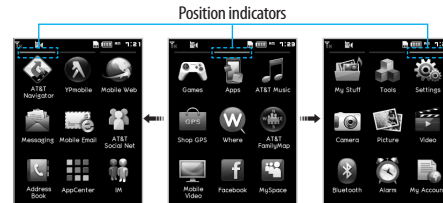

Extended Menu: Left Extended Menu: Center Extended Menu: Right

note: The position indicators are always displayed for the corresponding menu screen.

Missed events

When you missed calls, messages, email, instant messages, JAVA or voice messages, the icons will pop up and let you know you have missed events.

The icon will show at the Missed Events Area, tap the each icon to check the details. To make it disappear even you didn't check the events, simply tap .



Memory card

You can use a microSD card as a memory card. It gives you more space to save pictures, videos, music, etc.

Inserting and removing a memory card

1. Open the memory card slot.
2. Insert the card. The icon will be displayed.
3. Press the card to remove.

note: Supported up to 32 GB.

Using a memory card

You can save, move and delete the files between your phone and

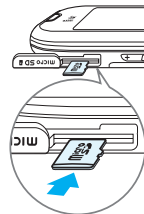



external memory card. You can also move and copy the files to computer from your phone.

Resetting a memory card



1. Tap **Menu**  > **Settings** > **Reset**.
2. Enter the password > **External Memory Reset**.

note: The default password is '1234'.

To copy or move a file to the card

1. Tap **Menu**  > **My Stuff** > **Audio, Picture, Video** or **Other Files**.
2. Tap to select the folder or file.
3. Tap  of selected file > **Copy** or **Move**.
4. Tap  > **Memory Card**.
5. Tap **MoveHere**.

To copy or move a file back to phone

1. Tap **Menu**  > **My Stuff**.
2. Tap  > **Memory Card**.
3. Tap to select the folder or file.
4. Tap  of selected file > **Copy** or **Move**.
5. Select a folder > **MoveHere**.

To delete the file from the card

1. Select the file from the card > **Options** > **Delete**.

To move the file from the card to the computer

Connect the data cable with mobile and the computer.

1. Tap **Menu**  > **Settings** > **Connectivity**.
2. Tap **Select USB Mode**.
3. Select **Music Player**, **Mass Storage** or **Ask on Connection**.
4. Follow the instructions on your computer screen.

note: Select **Music Player** when you want to add music to the playlist in your device. When you select **Ask on Connection**, it will ask you to select either the **Music Player** or **Mass Storage** every time you connect your device with your computer.

Drawing commander

You can set drawing commands to easily access dialing, contacts and menus.

Setting commands

1. Tap **Menu**  > **Tools** > **Drawing Commander**.
2. Tap **Setting** > **Add**.
3. Tap to select **Dial** or **Shortcuts**.
4. If you select **Dial**, scroll and tap to select the contact. If you select **Shortcuts**, scroll and tap to select the menu.

5. Scroll and tap to select the command > **Save**.

note: To set the drawing commands, tap **Menu**  > **Tools** > **Drawing Commander** > **Setting**. Check the **Show Icon on Home screen** option box by tapping.

Using commands

1. Tap **Menu**  > **Tools** > **Drawing Commander**.
2. Draw the command on the panel.

Shake function

The phone has a shake function. You can call, access the play music menu, access web, and more by shaking the phone.

Activating shake function

1. Tap **Menu**  > **Settings** > **Phone**.
2. Tap **Shake Key Activation**.
3. Drag the bar to **On** > **Save**.

Assigning the shake menu

1. Press  > **Settings**.
2. Select **Music Player**, **Mobile Web** or **App Manager** to change the menu.
3. Select the desired menu to change > **OK**.
4. Tap **Save**.

Using shake function

1. Press .
2. Shake once to play music, shake twice to access web menu and shake three times to access app manager.

Using the multitask menu

Press and hold  to launch the Multitask menu that can be accessed from any active window or page on the phone.

There is no need to stop what you are doing if you want to jump out and activate another common feature.

This function allows you to temporarily exit your current location to access a group of common functions such as: **Music**, **App Manager**, **Mobile Web**, **Call** and **Messaging**.

With the multitask key, you can quickly navigate to other menus without quitting current task or active window such as creating a message, making a call, or browsing a web page.

Multitask functions

To use multitask function, tap and hold . You can choose



01

02

03

04

05

06

07

08

from one of the following functions:

- **Music:** Launch the Music Player while using the handset for other tasks. If an incoming call is received or you try to make a call, the Music Player is muted.
- **App Manager:** Access Games and Applications while using the handset for other tasks.
- **Mobile Web:** Launch the browser while using the handset for other tasks.
- **Call:** Make a voice call while using the handset for other tasks. If Music Player is active, it is muted during the call.
- **Messaging:** Send a text or multimedia message while using the handset for other tasks.

Updating software

You can update your software without visiting your nearest dealer.

To update the software

1. Tap **Menu**  > **Settings** > **AT&T Software Update**.
2. Tap **Check for Update** > **Yes** to check whether or not you need to update the software.

note: After downloading the software, the device will ask you whether

to update the software now or later. If you choose to update the software now, it will restart the handset. If you postpone updating the software, you can select between 30 mins, 1 hour or 4 hours in the **Options**. After selecting the updating time, you will be sent back to standby mode. If you go to **Software Update** while you are in postponing, tap **Continue Update**.

To view the version of software

1. Tap **Menu**  > **Settings** > **Phone Information**.
2. Scroll down to **Software Version**.



pursuit™

2

Calls and address book

- Making, receiving and ending calls
- Using video share
- Options during a call
- Call settings
- Checking all calls
- Speed dialing
- Using the address book
- Address book settings
- Caller identification
- Using your headset
- Service numbers and fixed dialing

Making, receiving and ending calls

Making a call

1. Enter the area code and phone number.
2. Tap .

Answering a call

1. Drag the **Accept** bar to right.

Ending a call



1. Tap .

Once the call is complete, a call summary is displayed.

Rejecting a call

1. Drag the **Ignore** bar to right.

Making a call using the call list

1. Your phone logs up to 20 dialed, received and missed call numbers.
2. Tap  to display the **Recent Calls list**.
3. Tap to select **All Calls**, **Missed Calls**, **Received Calls**, or **Dialed Calls**.
4. Select a number.
5. Tap  to dial the selected number.

note: To redial the last number in the **Recent Calls** list, tap .





Making a call during a call

1. Enter the phone number or look it up in **Address Book**.
2. Tap  to dial the second call. The first call is automatically put on hold.

Switching between two calls

1. Tap **Swap**.



Making an international call

1. [] Tap **Dial**  and press and hold **0 +** for the international prefix until the '+' character appears.
[] Press **0 +** for the international prefix until the '+' character appears.
2. Type the country code, area code, and phone number.
3. Tap .



Making an emergency call

1. You can make emergency calls even if your phone does not have a SIM card.
2. Tap Emergency Number, or tap **SOS** if your phone does not have a SIM card.
3. Tap .

Replying to a missed call

1. Tap  to display the list of missed calls.
2. Select a number to call by scrolling the screen.
3. Tap .

Answering a second call^a

1. Tap . The first call is automatically put on hold.
2. Tap  to end the second call.

The call on hold is automatically reconnected.

Using video share

You can share live or recorded video while on a call. You can send or receive video.

note: Video Share is not available in all markets. Both parties must be in a 3G service area—a 3G icon must appear by the signal bars prior to a call being placed, and both parties must remain in the 3G coverage area for the duration of the Video Share.

<Call mode>

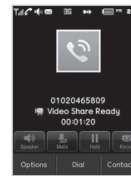

<Video Share Mode>



Making video share call

1. Enter the area code and phone number > .
2. Tap **Options** > **Video Share**.
3. Select **Live** or **Recorded**.

note: To use video share in the **Recent Calls**, tap **Options** > **Video Share**.

Turning off the speakerphone

1. Tap **Speaker**  during video share mode.
2. Tap **Mute**  to mute the sound.

Increasing or decreasing the brightness

1. Tap **Brightness** .
2. Adjust the brightness by scrolling left or right.

Zoom in and out

1. Tap **Zoom** . It ranges from 1x to 3x.

Stopping the recording

1. Tap **Record** .

Stopping or ending video share

1. Tap **Stop** to end the video share.
2. It will ask you whether you will stop video share > **Yes** to stop.

note: Even you end video share or close the folder, the call will not be ended. Tap to end the call. The recorded video will be saved in **My Stuff > Video**.

Receiving video share

1. After receiving video share, it will ask you whether to accept or reject the video share > **Yes** to accept and **No** for reject.
2. Tap **Options** > **Full Screen** to enlarge the video to fill the entire screen.

note: When the flip is closed, open the flip to accept or tap **Reject** to reject video share.

Options during a call

Microphone off and on

Switching your phone's microphone off

1. Tap **Mute** .

Switching your phone's microphone back on

1. Tap **Mute** .

Talking on speaker

1. Tap **Speaker** .

Putting a call on hold and returningⁿ

Putting a call on hold

1. Tap **Hold** or tap .

Returning to a held call

1. Tap **Unhold** or tap again.

Multi-party callsⁿ

You can talk with more than one person or have conference call.

Making a multi-party call

1. Call the first participant.
2. Call the second participant. The first call is automatically put on hold.
3. Tap the second participant phone number > **Join**.



Having a private conversation with one participant

1. Tap the participant to hold.
2. Tap **Member**.
3. Tap .

All of the multi-party call participants can now hear each other.

Removing one participant from a multi-party call

1. Tap the participant to end.
2. Tap **Members**.
3. Tap .

The call ends with that participant, but you can continue to talk to the other participants.

Searching for a number in the address book during a call

1. Tap **Contacts**.
2. Select a number by scrolling up or down.

Searching for a name or group in the address book
Enter the first letters of the name for Name Search. The entries are displayed starting with the first entry matching your input.

Finding a name manually in the address book

1. Scroll the screen up or down.

Viewing the details of the highlighted entry in the address book

1. Tap .

For details on address book, see page 35.

Reading a message during a call

1. Press and hold and tap **Messaging**.
2. Select a message > **OK**.

Sending a message during a call

1. Press and hold and tap **Messaging**.

For details on creating a text message, see page 43.

Voice recording

1. Tap **Record** .

Call settings

Setting auto redial



1. Tap **Menu**  > **Settings** > **Call** > **Auto Redial**.
2. Drag the bar **On** or **Off** > **Save**.

Checking all calls

You can view information about all **Recent Calls**. For more options for all, missed, received and dialed calls, tap **Options**.

You can also view the call history simply by tapping .



Viewing missed calls

1. Tap  > **Missed Calls**  or tap **Menu**  > **My Stuff** > **Tools**.
2. Tap **Recent Calls** > **Missed Calls**.



Viewing received calls

1. Tap  > **Received Calls**  or tap **Menu**  > **My Stuff** > **Tools**.
2. Tap **Recent Calls** > **Received Calls**.

Viewing dialed calls

1. Tap  > **Dialed Calls**  or tap **Menu**  > **My Stuff** > **Tools**.
2. Tap **Recent Calls** > **Dialed Calls**.



Viewing call rankings

1. Tap  > **Call Ranking**  or tap **Menu**  > **My Stuff** > **Tools**.
2. Tap **Recent Calls** > **Call Ranking**.

Deleting call logs

1. Tap **Menu**  > **My Stuff** > **Tools**.
2. Tap **Recent Calls** > **Delete Call Logs**.
3. Select **All Calls**, **Missed Calls**, **Received Calls** or **Dialed Calls** > **Yes**.

Viewing call time

1. Tap  > **Call Time** or tap **Menu**  > **My Stuff** > **Tools**.
2. Tap **Recent Calls** > **Call Time**.
3. You can view **Last Call**, **Received Calls**, **Dialed Calls** and **Total Calls**.



Resetting all call times

1. Tap  > **Call Time** or tap **Menu**  > **My Stuff** > **Tools**.

2. Tap **Recent Calls** > **Call Time**.
3. Tap **Reset** > **Yes**.
4. Enter password > **OK**.

note: The default password is '1234'.

Viewing data transmitted information

1. Tap  > **Packet Counter** or tap **Menu**  > **My Stuff** > **Tools** or tap **Recent Calls** > **Packet Counter**.
 - **Total:** You can view all the **Sent**, **Received**, **Total** and **Duration** transmitted data in Kilobytes.
 - **Current:** You can view transmitted data in the current session, in Kilobytes. **Sent**, **Received** and **Total** information are also available.
 - **Last:** You can view **Sent**, **Received**, **Total** and **Duration** information of the previous session's transmitted in Kilobytes.
2. Tap **Clear** to clear the information.

Speed dialing

You can dial quickly using speed dialing. Up to 8 phone numbers can be programmed using numbers 2 to 9.

Setting speed dial

1. Tap **Contacts**  > **My Settings**  > **Speed Dial**.
2. Tap an empty entry.
3. Select a person and tap.

Changing speed dial contact

1. Tap **Contacts**  > **My Settings**  > **Speed Dial**.
2. Select a number > **Change**.
3. Select a person and tap.

Removing from speed dial

1. Tap **Contacts**  > **My Settings**  > **Speed Dial**.
2. Select a number > **Remove** > **Yes**.

Using the address book



You can save names, phone numbers, and information on the SIM or phone. Number of entries can depend on the capacity of the SIM card.

Viewing the contact list





1. Tap **Contacts**  > **All Contacts** .

Searching for a phone number





1. Tap **Contacts**  > **All Contacts** .

2. Scroll the screen up or down or tap  and enter the name to find the contact.
3. Tap the contact >  to view the detailed information.
4. To update information, tap **Edit**.





Calling from the contact list

1. Tap **Contacts**  > **All Contacts** .
2. Scroll the screen up or down to select a person or tap  and input the first letter or two of the person's name.
3. Tap .

Forwarding contact details

1. Tap **Contacts**  > **All Contacts** .
2. Scroll the screen up or down or tap  and enter the name to find the contact.
3. Tap the contact >  > **Options** > **Send Contact**.
4. You can send the information using **Multimedia Message** or **Bluetooth**.



Deleting a contact

1. Tap **Contacts**  > **All Contacts** .
2. Scroll the screen up or down or tap  and enter the name to find the contact.
3. Tap the contact >  > **Delete** > **Yes**.



Adding a contact

1. Tap **Contacts**  > **Add**.
2. Input the fields by tapping the desired field.
3. Tap **Save**.

Making groups

1. Tap **Contacts**  > **Groups** .
2. To add new group, tap **Add**.
3. Input the group name > **OK**.
4. To add members to group, tap **Yes**.
5. Select the members > **Add**.

Editing groups

1. Tap **Contacts**  > **Groups** .
2. To edit group, tap the group > **Edit** > **Rename Group**, **Add Members**, **Remove Members** or **Edit Members**.
3. To send message to group members, tap **Send Message**.
4. To delete group, tap **Delete**.

Address book settings

Managing my info

1. Tap **Contacts**  > **My Settings**  > **My Info**.

Setting the sort order

1. Tap **Contacts**  > **My Settings**  > **Sort by**.
2. Select **First Name** or **Last Name** > **Save**.

Setting address book

1. Tap **Contacts**  > **My Settings**  > **AT&T Address Book**.

Setting SIM management

1. Tap **Contacts**  > **My Settings**  > **SIM Management**.

Caller identification

Caller identificationⁿ

1. Tap **Menu**  > **Settings** > **Call** > **Display My Number**.
2. Select **Network Default**, **Show** or **Hide**.

Using your headset

You can make or receive a call using your headset.

When you connect your headset to the jack the button on the headset works as follows.

note: You must to use the headset designed for this device. It is an optional accessory. Not all headsets will have a button.

While in standby mode

1. Tap the button once to list recent calls.
2. Tap the button twice to redial the last call.

Service numbers and fixed dialing

Calling your service numbers^d

You can see the service number to reach the service provider.

1. Tap **Contacts**  > **My Settings**  > **Service Numbers**.
2. Select a number.

Viewing the fixed dialing list

Fixed dialing is a service that limits your access to specific numbers in the address book list recorded on the SIM. Input the PIN2 to set up or cancel this service.

1. Tap **Contacts**  > **My Settings**  > **FDN List**.
2. Select a number.

note: PIN2 must be correctly entered within 3 attempts. If you input the incorrect code three times in a row the PIN2 code will be blocked. If the PIN2 code is blocked please contact your service provider. Your PIN2 code is supplied with the SIM card.



pursuit™

3

Messaging

- Entering text
- Messaging
- Receiving messages
- Creating and sending text messages
- Creating multimedia messages
- Message templates
- Message settings
- Email
- Using instant messenger

Entering text

You can enter text with multi-tap, predictive, numeric or symbol.

Useful keys

Touch	QWERTY	Function
		Display symbols
		Delete the letter
		Adding space
		Tap to change capital mode Tap to change ab Ab AB Multi-tap (lower caps / first letter caps / all caps) Predictive (lower caps / first letter caps / all caps)

For details on using QWERTY keypad, see page 6.

Key characters by language

Each of the following keys will scroll through these sequential options listed by language.

Key	English	French	Spanish
1		. , - ? ! / ' @ :	
2	a b c	ç à ä	á ã ç
3	d e f	é è	é
4	g h i		í
5	j k l		
6	m n o	ö ñ	ó ñ
7	p q r s	ß	
8	t u v	ù ü	ú ü
9	w x y z		

Predictive mode

The predictive mode automatically compares your keystrokes with an internal linguistic dictionary to determine the correct word. It will display the most commonly used word first. To save a word not listed in phone's dictionary,

1. Tap to change the mode to predictive.
2. [] Tap to to input text. To enter 'hello' in touch keypad, tap .

[] Press to to input text. To enter 'hello' in

QWERTY keyboard, press .

Alphabet input mode

Tap the key labeled with the target letter once for the first letter; tap it twice for the second letter, and so on.

1. Tap to change the mode as multi-tap.
2. [] Tap to to input text repeatedly. To enter the letter "C", Tap 3 times. To enter number 2, tap 4 times.
[] Press to to input text repeatedly.

Numeric mode

You can input numbers in this mode.

1. Tap to change the mode to 123.
Press to change the mode to 123.
2. [] Tap to and to input numbers.
[] Press to and to input numbers.

Symbol mode

You can input symbols.

1. Tap to view the symbols.
2. Tap to select symbol.

Messaging

You can send, receive and save text messages and multimedia messages.

Managing memory

Up to 200 messages can be stored in the phone memory, additional messages will be saved to the SIM card. When the message box is full, the messages full icon will appear.

All messages share memory.

When	It means
	Text message is full (SIM and Phone messages)

Moving a message to SIM

1. Tap **Inbox** .
2. Select a message > **Options** > **Move to SIM**.

Deleting a message in the inbox

1. Tap **Inbox** .
2. Tap **Delete** or tap to select a message > **Options** > **Delete**.

Deleting multiple messages



1. Tap **Inbox** .
2. Tap **Delete**.

3. Select the message to delete by tapping.
4. Tap **Delete** > **Yes**.
5. To select all messages, tap **All**.
6. To cancel deleting action tap .

Replying to a message

1. Select a message > **Reply**.

Viewing memory space information

1. Tap **Menu**  > **Messaging** > **Used Space**.
2. Tap  > **USIM**.

Receiving messages

Viewing a new message

1. Tap **View**.

Reading a message from the inbox

1. Tap **Inbox** .
2. Select a received message > **View**.

Saving the contact information from a received message

1. Select a received message > **View**.
2. Tap **Options** > **Add to Contacts**.

3. Select **New Contact** or **Update Contact**.





























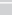









Saving the object in a received multimedia message

1. Open the multimedia message.
2. Select an object.
3. Tap **Use** > **Save to Internal**.

It will be saved in one of the categories in the **My Stuff** folder.

For details on photo album, see page 53.

Listening to voice message

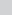
1. [, , , , , , , , , , , , , , , , , , ,] Tap **Dial**  and press and hold **1** or tap **Menu**  > **Messaging** > **Voice Mail**.
[, , , , , , , , , , , , , , , , , , , ,

7. To edit the text message, tap the text box.
8. Tap the recipient filed to add a recipient(s) and select the contact > **OK**.
9. Tap **Send**.

For the taking a picture, see page 51.

Adding a saved video to the message

1. Tap **Menu**  > **Messaging** > **Create Message**.
2. Enter a message > **OK**.
3. Tap **Insert** > **Video** > **Existing Video** > **Video**.
4. Tap the desired video clip to insert and tap **Select**.
5. To preview the current page, tap **More** > **Preview** > **Current**.
6. To preview the whole message, tap **More** > **Preview** > **Whole Message**. To go back to text editor page, tap **Stop**.
7. To edit the text message, tap the text box.
8. Tap the recipient filed to add a recipient(s) and select the contact > **OK**.
9. Tap **Send**.

Adding a new video to the message

1. Tap **Menu**  > **Messaging** > **Create Message**.
2. Enter a message > **OK**.

3. Tap **Insert** > **Video** > **Record New Video**.
4. Focus on the object and tap .
5. To stop recording and save tap **Stop**.
6. To edit the text message, tap the text box.
7. To preview the current page, tap **More** > **Preview** > **Current**.
8. To preview the whole message, tap **More** > **Preview** > **Whole Message**. To go back to text editor page, tap **Stop**.
9. Tap the recipient filed to add a recipient(s) and select the contact > **OK**.
10. Tap **Send**.



For the recording a video, see page 53.

Adding a recorded voice memo to the message

1. Tap **Menu**  > **Messaging** > **Create Message**.
2. Enter a message > **OK**.
3. Tap **Insert** > **Sound** > **Existing Sound**.
4. Select **Audio** > **My Voice**.
5. Tap the desired audio clip to insert and tap **Select**.
6. To edit the text message, tap the text box.
7. To preview the current page, tap **More** > **Preview** > **Current**.
8. Tap **Pause** to stop listening.

9. To preview the whole message, tap **More** > **Preview** > **Whole Message**. To go back to text editor page, tap **Stop**.
10. Tap the recipient filed to add a recipient(s) and select the contact > **OK**.
11. Tap **Send**.

Adding a new voice memo to the message

1. Tap **Menu**  > **Messaging** > **Create Message**.
2. Enter a message > **OK**.
3. Tap **Insert** > **Sound** > **Record New Sound**.
4. Tap  to record the sound.
5. To stop and save tap **Stop**.
6. To edit the text message, tap the text box.
7. To preview the current page, tap **More** > **Preview** > **Current**.
8. Tap **Pause** to stop listening.
9. To preview the whole message, tap **More** > **Preview** > **Whole Message**. To go back to text editor page, tap **Stop**.
10. Tap the recipient filed to add a recipient(s) and select the contact > **OK**.
11. Tap **Send**.

For the recording voice memo, see page 45.

Adding other file to the message

1. Tap **Menu**  > **Messaging** > **Create Message**.
2. Enter a message > **OK**.
3. Tap **Insert** > **Other** > **Files**.
4. Select **Other Files**.
5. Tap to select desired file to insert.
6. To edit the text message, tap the text box.
7. To preview the current page, tap **More** > **Preview** > **Current**.
8. To preview the whole message, tap **More** > **Preview** > **Whole Message**. To go back to text editor page, tap **Stop**.
9. Tap the recipient filed to add a recipient(s) and select the contact > **OK**.
10. Tap **Send**.

Message templates

When you often use the same phrases, you can save the message under message templates.

Adding the message as a template

1. Tap **Menu**  > **Messaging** > **Templates**.
2. Tap **Add**.

3. Enter the frequently used message > **OK** > **More** > **Save**.

Sending a message with template

1. Tap **Menu**  > **Messaging** > **Templates**.
2. Select the message to send.
3. Tap the text box and add more messages.
4. Tap the recipient filed to add a recipient(s) and select the contact > **OK**.
5. Tap **Send**.

Message settings

Setting message center

1. Tap **Menu**  > **Messaging** > **Settings**.
2. Tap **Text Message**.
3. Enter new **Center Address**.
4. Tap **Save**.

Setting e-mail gateway

1. Tap **Menu**  > **Messaging** > **Settings**.
2. Tap **Text Message**.
3. Enter new **Email Gateway** for sending text message by email address.
4. Tap **Save**.

Setting profiles for multimedia message

1. Tap **Menu**  > **Messaging** > **Settings**.
2. Tap **Multimedia Message** > **MMS Profiles**.
3. Select a profile.
4. To add a profile, tap **Create** > set the options > **Save**.

Setting for sending multimedia message

1. Tap **Menu**  > **Messaging** > **Settings**.
2. Tap **Multimedia Message** > **Sending Settings**.
3. You can set the **Validity Period**, **Delivery Time**, **Priority**, **Creation Mode** and **Max Message Size**.
4. Tap **Save**.

Setting for receiving multimedia message

1. Tap **Menu**  > **Messaging** > **Settings**.
2. Tap **Multimedia Message** > **Receiving Settings**.
3. You can set the **Automatic Download**, **Allow Delivery Reply** and **Allow Read Reply**.
4. Tap **Save**.

Setting for receiving voice message

1. Tap **Menu**  > **Messaging** > **Settings**.
2. Tap **Voice Mail**.
3. Enter the number of the voice mail center > **Save**.

note: This number may be pre-configured by the service provider upon activation.

Setting for auto delete oldest message

1. Tap **Menu**  > **Messaging** > **Settings**.
2. Tap **Auto Delete**.
3. Drag the bar to **On** or **Off**.
4. Tap **Save**.

Email

You can receive emails from your service provider.

Receiving an email

1. Tap **Menu**  > **Messaging** > **Mobile Email**.
2. Select an email > **OK**.

Using instant messenger

Use Instant Messenger (IM) to send and receive short, simple messages that are delivered immediately.

Starting an instant messenger

1. Tap **Menu**  > **Messaging** > **IM**.
2. Select the IM application > **Select**.
3. Enter login and password > **Sign In**.

Viewing the conversation log

You can view the conversations log in the Instant Messenger Saved History.

01

02

03

04

05

06

07

08



pursuit™

4

Multimedia

- Camera
- Photo album
- Video album
- Audio album
- Music Player
- Music player settings
- Media player
- Other files
- Managing memory
- Playing games

Camera

You can take pictures and record movies using the built-in camera. The photos and video clips can be saved and sent via multimedia messages.

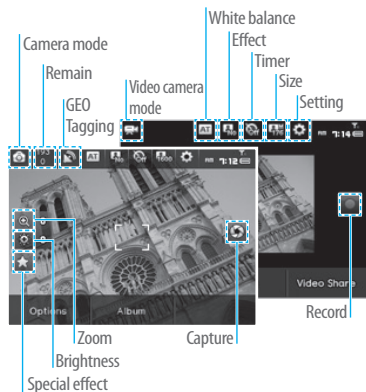

Setting camera settings

1. Press in standby mode or tap **Menu** > **Camera**.
2. Tap **Options** > **Settings** to change settings prior to taking a picture.

In the options menu for camera

Icons	Name	Description
	GEO Tagging	On, Off
	White Balance	Auto(), Day Light(), Tungsten(), Fluorescent()
	Effect	Normal(), Sepia(), Negative(), B&W()
	Self Timer	Off(), 5 secs(), 10 secs()
	Picture Size	1600x1200() , 1280x1024() , 640x480() , 320x240()
	Advanced Settings	Picture Quality, Save Location, Shutter Sound, Timer Sound, Default File Name

note: GEO Tagging will work only outside. When GEO Tagging activates, it will search for the GPS for 1 minute and will ask whether to proceed or not.

In the options menu for video camera

Icons	Name	Description
	White Balance	Auto(), Day Light(), Tungsten(), Fluorescent()
	Effect	Normal(), Sepia(), Negative(), B&W()
	Self Timer	Off(), 5 secs(), 10 secs()
	Resolution	176x144 (MMS) () , 176x144 () , 320x240 () , Video Share()
	Advanced Settings	Video Quality, Save Location, Sound Recording, Timer Sound, Default File Name

Zoom in and out

1. Tap then tap or . It ranges from 1x to 7x.

Increasing or decreasing the brightness

1. Tap then tap or . It ranges from -3 to +3.

Taking a picture

1. Press in standby mode or tap **Menu** > **Camera**.
2. Focus on the object and tap .

note: Your photo will be saved automatically to **Menu** > **My Stuff** > **Picture** > **Camera** or **Menu** > **Picture** > **Camera**.

Changing to video camera mode

1. Press in standby mode or tap **Menu** > **Camera**.
2. Tap **Options** while camera mode is activated or simply just tap .
3. Tap **Video Camera Mode**.
4. Focus on the object and tap .
5. Record the motion > **Stop**.

note: Your video will be saved automatically to **Menu** > **My Stuff** > **Video**.

Viewing the taken picture

1. Press in standby mode or tap **Menu** > **Camera**.
2. Tap **Album**.
3. Select the picture by tapping.

After taking pictures

To	Press
Send a multimedia message	Send > as Multimedia Message
Send using Bluetooth	Send > via Bluetooth
Upload photos on the web	Send > to Online Locker

To	Press
Set as wallpaper	Set as > Wallpaper
Set as address book	Set as > Caller ID
Rename	Rename
Save to face tagging	Face Recognition
Delete	Delete
View the information	Properties

Using special effects

Smile effect

1. Press in standby mode or tap [Menu](#) > [Camera](#).
2. Tap > [Smile](#) .
3. Tap and focus on person's face. When the person smiles, it will capture the person automatically.

Self effect

1. Press in standby mode or tap [Menu](#) > [Camera](#).
2. Tap > [Self](#) .
3. Focus on myself and press to capture.

note: You will hear the beep sound when you try to focus on person.

The beep sound will depend on number of people. If focus on one person, it will beep one time and if there are two people, it will beep twice and so on.

Wink effect

1. Press in standby mode or tap [Menu](#) > [Camera](#).
2. Tap > [Wink](#) .
3. Tap and focus on person's face. When the person winks it will capture the person automatically after 3 seconds.

Face effect

With this function, you can put visual effects on the face.

1. Press in standby mode or tap [Menu](#) > [Camera](#).
2. Tap > [Face Effect](#) .
3. Tap to select the effect > [Save](#).
4. Focus on the object or person and tap .

note: The [Face effect](#) will only support on size 320x240 and 640x480.

Panorama effect

1. Press in standby mode or tap [Menu](#) > [Camera](#).
2. Tap > [Panorama](#) .
3. Focus on the object or person and tap . After the beep, move the phone to left or right to capture. It will capture 4 picture automatically.

note: The [Panorama effect](#) will only support on size 320x240.

Recording a video

1. Tap [Menu](#) > [Tools](#) > [Video Camera](#).
2. Focus on the object and tap .
3. Tap [Stop](#) to stop.
4. Tap [Play](#) to play the video clip.
5. Tap to go back to preview mode.

Changing to camera mode

1. Tap [Menu](#) > [Tools](#) > [Video Camera](#).
2. Tap [Options](#) while video camera mode is activated or simply just tap .
3. Tap [Camera Mode](#).

For details on taking a picture, see page 51.

Viewing the recorded video clip

1. Tap [Menu](#) > [Tools](#) > [Video Camera](#).
2. Tap [Album](#).
3. Select the video clip by tapping.

After saving recorded video clips

To	Press
Send a multimedia message	Send > as Multimedia Message

To	Press
Send using Bluetooth	Send > via Bluetooth
Upload photos on the web	Send > to Online Locker
View recorded video clip	Play
Rename	Rename
Delete	Delete
View the information	Properties

During recording a video

To	Press
Receive an incoming call	
Stop recording	Stop
Pause the recording	Pause

Photo album

You can save photos to your phone or an external memory card and view, send or delete them in the photo album. JPEG format is supported, and other formats are saved in the [Picture](#) folder.

note: To access [Picture](#), tap [Menu](#) > [Picture](#).

Viewing the saved pictures

1. Tap **Menu**  > **Picture** > **Camera**.
2. Select a picture.

Setting as wallpaper in the display

1. Tap **Menu**  > **Picture** > **Camera**.
2. Tap  of the picture > **Set as** > **Wallpaper**.

Setting as caller identification



1. Tap **Menu**  > **Picture** > **Camera**.
2. Tap  of the selected picture > **Set as** > **Caller ID**.

Sending pictures using multimedia message



1. Tap **Menu**  > **Picture** > **Camera**.
2. Tap  of the selected picture > **Send** > **as Multimedia Message**.

For details on creating a multimedia message, see page 43.

Deleting multiple pictures

1. Tap **Menu**  > **Picture** > **Camera**.
2. Tap **Options** > **Delete**.
3. Tap to mark desired files or tap **All** to mark all files.
4. Tap **Delete** > **Yes**.
5. To cancel deleting action tap .

Recognizing face

1. Tap **Menu**  > **Picture** > **Camera**.
2. Tap  of the selected picture > **Face Recognition**.
3. Tap **OK** and input the name and phone number.
4. Tap **Save**.

note: To view the information, tap **Menu**  > **Picture** > **Face Tagging**.

Viewing file information

1. Tap **Menu**  > **Picture** > **Camera**.
2. Tap  of the selected picture > **Properties**.

Video album







You can view, send, save and delete videos. The supported formats are MP4, WMA, 3GP and 3G2.

Playing the saved video clips

1. Tap **Menu**  > **Video**.
2. Tap the video clip to play.

Using video player controls

To	Press
Pause	



To	Press
Play	
Previous	
Next	
Fast rewind	Hold 
Fast forward	Hold 
Control volume	 or press side volume keys

Sending video clip using multimedia message

1. Tap **Menu**  > **Video**.
2. Tap  of the selected picture > **Send** > **as Multimedia Message**.

For details on creating a multimedia message, see page 43.

Deleting multiple video clips

1. Tap **Menu**  > **Video**.
2. Tap **Options** > **Delete**.
3. Tap to mark desired files or tap **All** to mark all files.
4. Tap **Delete** > **Yes**.
5. To cancel deleting action tap .







Audio album

You can play, send, delete, move or copy saved sounds to the external memory or to the phone. The supported formats are MP3, AAC, AAC+, and WMA.

Listening to the recorded sound

1. Tap **Menu**  > **My Stuff** > **Audio**.
2. Tap **My Voice**.
3. Tap the file to play.

Using sound controls

To	Press
Pause	
Play	
Previous	
Next	
Fast rewind	Hold 
Fast forward	Hold 
Control volume	 or press side volume keys

Setting as a ring tone

1. Tap **Menu**  > **My Stuff** > **Audio**.
2. Tap  of the selected file > **Set as Ring Tone**.

note: The maximum ringtone file size is 300KB.

Moving or copying multiple sound to external memory

1. Tap **Menu**  > **My Stuff** > **Audio**.
2. Tap **Options** > **Copy** or **Move**.
3. Select the file to move > **Copy** or **Move**.
4. Select the folder > **CopyHere** or **MoveHere**.

The selected sound will be copied or moved to **Audio** folder in external memory card.

Sending sound file using multimedia message

1. Tap **Menu**  > **My Stuff** > **Audio**.
2. Tap  of the selected file > **Send** > **as Multimedia Message**.

Music Player

You can listen to music on your phone through the Music Player. The Music Player is only compatible with and can play the following audio types saved in MP3, .AAC, .AAC+, and .WMA.

note: microSD card must be inserted to transfer music to your device.

Adding music from Windows Media Player™

1. Connect the USB cable to the device and the computer.
2. Select **Music Player** > **Yes**.
3. Open the Sync Tap in Windows Media Player™ in your computer.
4. Select the music from the list and drag and drop to your device.



note: Windows Media Player™ 10, 11 and Window XP version is required.









Playing the music

1. Tap **Menu**  > **AT&T Music** > **Music Player**.
2. Scroll to select a category to play the music.
3. Scroll to select the file and tap.

note: Music will pause when you receive an incoming call and Music will resume when the call ends.

Icons for player





Icon	Name	Description
	Volume	
	Pause	
	Play	

Icon	Name	Description
	Rewind	
	Fast Forward	Tap and hold : Fast Rewind, Fast Forward
	Previous Track	
	Next Track	Tap: Previous, Next
	Repeat all	
	Repeat off	
	Repeat Single Track	
	Shuffle On / Off	ON: the current list of songs are randomly shuffled for playback OFF: songs play in order and are not shuffled



Making playlist

1. Tap **Menu**  > **AT&T Music** > **Music Player**.
2. Tap **Playlists** > **New Playlist**.
3. Enter playlist name > **Save**.
4. Tap **All Music**, **Albums**, **Artists** or **Genres**.
5. Scroll and tap to select the music file and tap **Done** to add to playlist.

Add music to playlist

1. Tap **Menu**  > **AT&T Music** > **Music Player**.
2. Tap **Playlists**.
3. Tap  of the selected playlist > **Add Tracks**.
4. Tap **All Music**, **Albums**, **Artists** or **Genres**.
5. Tap to mark desired files or tap **Select All** > **Done**.
6. To remove tracks tap  > **Remove Tracks** > scroll and tap to select the music and tap **Done**.
7. To rename the playlist tap  > **Rename Playlist**.
8. To delete the playlist tap  > **Delete**.

Viewing the information

1. Tap **Menu**  > **AT&T Music** > **Music Player**.
2. Scroll and tap to select a category to play the music.
3. Scroll and tap to select the file.
4. Tap  of the selected file > **Properties**.
5. Scrolling up or down to view **Track Number**, **Title**, **Artist**, **Album**, **Genre**, **Duration**, **File Name**, **File Size**, **Location**, **Format**, **Bit Rate**, **Created**, **License** and **Sharing**.



Setting as ringtone

1. Tap **Menu**  > **AT&T Music** > **Music Player**.
2. Scroll and tap to select a category.

3. Scroll and tap to select the file.
4. Tap the selected file.
5. Tap  > **Set as Ring Tone**.

note: You cannot set the music file while it is playing. If a music file is larger than 300Kb, the file will be deactivated for setting ring tone.

Deleting music

1. Tap **Menu**  > **AT&T Music** > **Music Player**.
2. Scroll and tap to select category.
3. Scroll and tap to select the file.
4. Tap  > **Delete**. Or tap **Delete** and tap to mark desired files or tap **Select All** to mark all files.
5. Tap **Delete**.

note: If the music is playing you cannot delete.

Shopping the music

1. Tap **Menu**  > **AT&T Music**.
2. Tap **Shop Music**.
3. To go to previous page tap .

Listening the radio

1. Tap **Menu**  > **AT&T Music**.
2. Tap **AT&T Radio**.

Using music identification

1. Tap **Menu**  > **AT&T Music**.
2. Tap **Shazam**.
3. Hold the phone close to the music. Your phone will analyze the music and display the artist, title and album.

note: For the cost plan contact your nearest service provider.

Watching the music video

1. Tap **Menu**  > **AT&T Music**.
2. Tap **Music Videos**.

Launching to community

1. Tap **Menu**  > **AT&T Music**.
2. Tap **Community**.

Launching more applications

1. Tap **Menu**  > **AT&T Music**.
2. Tap **Music Apps**.

Music player settings

Shuffling music



1. Tap **Menu**  > **AT&T Music** > **Music Player**.
2. Tap **Settings** > **Shuffle**.

3. Tap **Shuffle On** or **Shuffle Off**.
4. Tap **Save**.



Repeating the music

1. Tap **Menu**  > **AT&T Music** > **Music Player**.
2. Tap **Settings** > **Repeat**.
3. Tap **Repeat All Tracks**, **Repeat Single Track** or **Repeat Off**.
4. Tap **Save**.

Setting equalizer

1. Tap **Menu**  > **AT&T Music** > **Music Player**.
2. Tap **Settings** > **Equalizer**.
3. Tap  to select **Normal**, **Pop**, **Jazz**, **Classic**, **Rock**, **Dance**, **User Configured1**, **User Configured2** or **User Configured3**.
4. Tap **Save**.

Gesture setting

1. Tap **Menu**  > **AT&T Music** > **Music Player**.
2. Tap **Settings** > **Gesture Setting**.
3. Drag the commander bar to **On** or **Off**.
4. Tap  to select the gesture for **Play&Stop**, **Next Play**, **Previous Play**, **Volume Up** and **Volume Down**.
5. Tap the each gesture to set each function > **Save**.

Removing

1. Tap **Menu**  > **AT&T Music** > **Music Player**.
2. Tap **Settings** > **Remove** > **Yes**.

Media player

You can play video clips with the media player.

note: Do not use this feature illegally. Sound and video can be protected by copyright. It is illegal to copy such sound / video tracks for the purpose of selling or distribution. Pantech does not in any way support the unauthorized use of content on your phone media player.



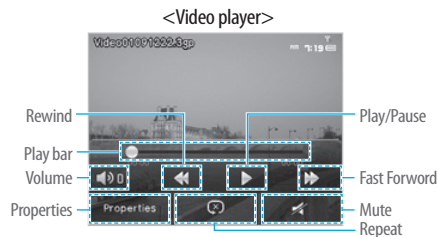

Icons for player

Icon	Name	Description
	Volume	
	Previous	Long Tap : Fast Rewind, Fast Forward
	Next	
	Pause	
	Play	
	Repeat all	
	Repeat off	

Playing the video clip

1. Tap **Menu** > **Tools** > **Media Player**.
2. Tap **Video**.
3. Scroll and tap to select a file.

Playing the audio file

1. Tap **Menu** > **Tools** > **Media Player**.
2. Tap **Audio**.
3. Tap the folder and file.

For the audio player control see page 54.

Other files

You can manage unsupported files formats that are saved on your phone. It also lists files received via Bluetooth from other devices.

Viewing the list of the files

1. Tap **Menu** > **My Stuff**.
2. Tap **Other Files**.

Managing memory

Viewing memory status

1. Tap **Menu** > **My Stuff**.
2. Tap **Used Space**.
3. Scroll to view the information.
4. To view external memory card memory status, tap and select the **Memory Card**.

Playing games

You can play pre-installed demo games or download games. It is easy to download and you can preview them beforehand. You will only be able to view games that are available on your mobile.

Play games

1. Tap **Menu** > **Games**.
2. Scroll and tap to play pre-installed games.

Shop games

1. Tap **Menu** > **Games**.
2. Tap **Shop Games**.



pursuit™

5

Useful Features

- Alarm
- Calendar
- Notepad and voice memo
- World time
- Calculator, tip calculator and converter
- Stop watch and timer
- Sketch pad
- Memory information

Alarm

Setting an alarm

1. Tap **Menu**  > **Tools** > **Alarm Clock**.
2. Tap **Create**.
3. Set the **Cycle**, **Time**, **Alarm Sound**, **Alert Type**, **Volume**, **Snooze** and **Power Alarm**.
4. Tap **Save**.

note: The alarm will not ring if you set the phone to **Vibrate Only**. To set the alarm to ring even though the phone is turned off, activate the **Power Alarm** by dragging the bar to on.

Viewing the saved alarms

1. Tap **Menu**  > **Tools** > **Alarm Clock**.
2. Scroll and tap an alarm to view the detail.

Editing existing alarms

1. Tap **Menu**  > **Tools** > **Alarm Clock**.
2. Scroll and tap to select an alarm.
3. Edit the alarm as you create an alarm.
4. Tap **Save**.
5. Tap **Create** to add new alarm.

Setting simply alarm

1. Tap **Menu**  > **Tools** > **Alarm Clock**.
2. Tap **Simply Alarm**.
3. Scroll and set the time.
4. Tap **Save**.

Calendar

Calendar helps you manage your schedule including your time for calls or special days. You can set a reminder on any given date with this function.

Viewing calendar

1. Tap **Menu**  > **Tools** > **Calendar**.

note: Monthly view is displayed as default.

In the monthly view

To	Press
Move to another month	◀ for Previous ▶ for Next



Creating a new event and edit



1. Tap **Menu**  > **Tools** > **Calendar**.

2. Tap to select a day > **Create**.
3. Tap to select **Schedule**, **Task** or **Note**.
4. Input the events > **Save**.



note: You can create events for dates from 01/01/2000 to 12/31/2099

Notepad and voice memo

Using notepad

1. Tap **Menu**  > **Tools** > **Notepad**.
2. Tap **Create New**.
3. Enter the memo > **OK**.
4. To edit memo, scroll and tap  of the memo > **Edit**.
5. To delete memo, tap **Delete** and tap to select the memo > **Delete**.
6. To send memo via message, scroll and tap  of the memo > **Send via Message**.

Recording voice memo

1. Tap **Menu**  > **Tools** > **Voice Memo**.
2. Tap **New Record**.
3. Tap .
4. Tap **Stop** to stop recording. It will automatically save on **My Voice**.

5. Tap **Play** to listen.



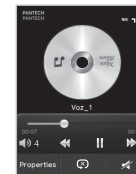



note: To access **My Voice**, tap **Menu**  > **My Stuff** > **Audio** > **My Voice**.





Listening the recorded sound

1. Tap **Menu**  > **My Stuff** > **Audio** > **My Voice**.
2. Scroll and tap to select play.

Icons for player

Icon	Name	Description
	Volume	
	Pause	
	Play	
	Rewind	Tap and hold: Fast Rewind,
	Fast Forward	Fast Forward
	Previous Track	Tap: Previous, Next
	Next Track	

Icon	Name	Description
	Repeat all	
	Repeat off	

World time

Using world time

1. Tap **Menu**  > **Tools** > **World Time**.
2. Scroll and tap to select the city > **OK**.
3. To add new city, tap **Add New City** and flick left or right to select new city. Tap **Add**.

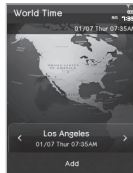

note: If you want to set dual time in idle mode, tap **Menu**  > **Settings** > **Display** > **Home Screen** > **Clock Type** > **Clock 5**.

Calculator, tip calculator and converter

Using the calculator

1. Tap **Menu**  > **Tools** > **Calculator**.
2. Tap the numbers and **+**/**-**/**×**/**÷** to calculate.
3. Tap **C** to erase one digit.
4. Tap **AC** to reset.



5. Tap  to use the decimal point.

Using tip calculator

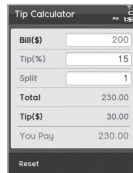

1. Tap **Menu**  > **Tools** > **Tip Calculator**.
2. Tap to enter values for all variable fields (**Bill(\$)**, **Tip(%)**, **Split**) and the corresponding calculation fields (**Total**, **Tip(\$)**, **You Pay**) are updated automatically.



3. Tap **Reset** to reset.
4. Tap  to use the decimal point.



Using the converter

1. Tap **Menu**  > **Tools** > **Converter**.

2. Tap / to select the categories.
3. Tap the field to enter figure and scroll left or right to select the unit. Then other unit fields are updated automatically.
4. Tap **Reset** to reset.

Stop watch and timer

Using stop watch

1. Tap **Menu**  > **Tools** > **Stop Watch**.
2. Tap / to select **Basic**, **Split** or **Lap**.
3. Tap **Start** to start.
4. Tap **Stop** to stop.
5. Tap **Continue** to restart.
6. Tap **Reset** to clear.

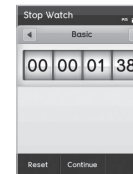

note: In Basic Mode, when you exit the stopwatch menu, or become idle, the stopwatch will continue running and will be indicated by a clock icon.  appears on the idle screen and indicates that stop watch continues to work. To return to the **Stop Watch** menu, tap the clock icon.

Using timer

1. Tap **Menu**  > **Tools** > **Timer**.





2. Tap **Set** to input the time
3. Scroll to set the hour, minute and second > **Save**.
4. Tap **Start** to start.
5. Tap **Pause** to stop.
6. Tap **Restart** to restart.

note: When you go idle while timer is working, you can see the timer icon  on idle screen that means timer is still working. To return to the **Timer** menu, tap the timer icon.

Sketch pad

You can draw memos or drawings and set as wallpaper or share via multimedia message, mobile share or Bluetooth.

Draw sketch

1. Tap **Menu**  > **Tools** > **Sketch Pad**.
2. Tap  to select pencil thickness, color, eraser and undo.
3. Select each options and tap  for more space to draw.
4. Draw on the sketch pad.
5. Tap  to save what you draw and tap **Save**.
6. To draw new drawing, tap  > **Options** > **Create New**.

Setting the background

1. Tap **Menu**  > **Tools** > **Sketch Pad**.

2. Tap  > [Options](#) > [Background](#).
3. Tap the desired background.
4. To import an image, tap  > [Options](#) > [Import Image](#).

note: Importing an image will import an image from the photo album.

Setting as wallpaper

1. Tap [Menu](#)  > [Tools](#) > [Sketch Pad](#).
2. After saving drawing, tap  > [Options](#) > [Set as Wallpaper](#).



Sending the drawing

1. Tap [Menu](#)  > [Tools](#) > [Sketch Pad](#).
2. After saving drawing, tap  > [Options](#) > [Send](#).
3. Tap to select as [Multimedia Message](#) or via [Bluetooth](#).

Memory information

You can view the information of your phone for [Available](#), [Audio](#), [Games](#), [Applications](#), [Picture](#), [Video](#), [Other Files](#) and [System](#).

Viewing the information

1. Tap [Menu](#)  > [My Stuff](#) > [Used Space](#).
2. To view external memory card memory status, tap  and select the [Memory Card](#).

01

02

03

04

05

06

07

08



6

Connectivity

Bluetooth
Accessing the web
Using the web browser
Profile settings





Bluetooth

Bluetooth technology enables free wireless connections between electronic devices within a maximum range of 33 feet (10 meters). Bluetooth connections can be used to send images, text, business cards, calendar events and notes or to connect to computers using Bluetooth technology.

Your mobile phone supports:

- Connect to PC to access internet.
- Connect to Hands-Free.
- Connect to electronic devices.

Icons for Bluetooth

	Bluetooth is active.
	Bluetooth hands-free headset is connected.
	Bluetooth A2DP headset is connected.
	Bluetooth hands-free + A2DP headset is connected.
	Data transfer via Bluetooth.

note: Advance Audio Distribution Profile (A2DP) is a Bluetooth profile (mode) which is designed to transfer a uni-directional 2-channel stereo audio stream to a headset or car audio.

Activating Bluetooth



1. Tap **Menu**  > **Bluetooth** > **Settings**.
2. Drag the **Activation** bar to **On**.
3. Tap **Save**.

Adding a device

1. Tap **Menu**  > **Bluetooth** > **Search**.
2. The available device will display.
3. Tap to select the device.
4. Tap **Pair** to pair the device.
5. Enter password > **OK**.
6. Tap **View Detail** to view the details of the device.

note: The other device must be in pairing mode.

Sending an object

1. Select the file from **Menu**  > **My Stuff** > **Picture, Video, Audio** or **Other Files**.
2. Tap  > **Send** > **via Bluetooth**.
3. Tap to select already paired device.

note: If the other Bluetooth device requests pairing, the object is sent after pairing is completed. Locked object or ones containing original rights may not be forwarded.

Receiving an object

The receiving of an object starts only when the receipt has been approved.

The received file will be saved in each phone. For example, if you received contacts information from the sender, it will be saved in your phone's memory.

Setting the visibility

1. Tap **Menu**  > **Bluetooth** > **Settings**.
2. Drag the **Visibility** bar to **On** or **Off**.
3. Tap **Save**.

Naming the phone

1. Tap **Menu**  > **Bluetooth** > **My Info**.
2. Tap Name field to edit the name > **OK**.

note: The device name is what identifies your phone to Bluetooth network.

Accessing the web

Accessing AT&T navigator

1. Tap **Menu**  > **AT&T Navigator**.

Accessing YPmobile

1. Tap **Menu**  > **YPmobile**.

Accessing Mobile Web

1. Tap **Menu**  > **Mobile Web**.

Accessing AT&T social net

1. Tap **Menu**  > **AT&T Social Net**.

Accessing AppCenter

1. Tap **Menu**  > **AppCenter**.

Accessing Apps

1. Tap **Menu**  > **Apps**.

Accessing Where

1. Tap **Menu**  > **Where**.

Accessing AT&T family map

1. Tap **Menu**  > **AT&T FamilyMap**.

Accessing mobile video

1. Tap **Menu**  > **Mobile Video**.

Accessing facebook

1. Tap **Menu**  > **Facebook**.

Accessing my space

1. Tap **Menu**  > **MySpace**.

Using the web browser

Accessing browser

1. Tap **Menu**  > **My Stuff** > **Applications**.
2. Tap **Browser** > **Home**.

note: It will access your service provider's homepage.

Viewing bookmarks

1. Tap **Menu**  > **My Stuff** > **Applications**.
2. Tap **Browser** > **Bookmarks**.
3. Scroll left or right to select the site and tap to open.
4. To send via text message, tap **Options** > **Send By MSG**.

Setting new bookmarks

1. Tap **Add**.
2. Tap the field to enter **Title** and **URL** > **OK**.
3. Tap **Save**.

Viewing as list

1. Tap **List**.
2. To view as visual, tap **Visual**.

Using feed

RSS (Really Simply Syndication) feeds are used to publish frequently updated contents in web browsers such as blog entries, new headlines, audio and video.

1. Tap **Menu**  > **My Stuff** > **Applications**.
2. Tap **Browser** > **Feed**.

Entering web address

1. Tap **Menu**  > **My Stuff** > **Applications**.
2. Tap **Browser** > **Enter Address**.
3. Tap the field to enter the web address > **OK**.
4. Tap **Go**.

Viewing history

1. Tap **Menu**  > **My Stuff** > **Applications**.
2. Tap **Browser** > **History**.

Setting advanced options

1. Tap **Menu**  > **My Stuff** > **Applications**.
2. Tap **Browser** > **Manage** > **Options**.
3. Change the **Rendering Mode**, **Cache**, **Cookies**, **Warning**, **Image Display** and **Script**.
4. Tap **Save**.

Using memory operations

1. Tap **Menu**  > **My Stuff** > **Applications**.
2. Tap **Browser** > **Manage** > **Private Data**.
3. To clear the cache, tap **Clear Cache** > **Yes**.
4. To clear the cookies, tap **Clear Cookies** > **Yes**.
5. To clear the history, tap **Clear History** > **Yes**.

Viewing certificates

1. Tap **Menu**  > **My Stuff** > **Applications**.
2. Tap **Browser** > **Manage** > **Security**.
3. Tap **Certificates**.
4. Scroll and tap to select to view the certificate.
5. To clear sessions, tap **Clear Sessions**.
6. To view the certificates, tap **Current certificate**.



Viewing download status

1. Tap **Menu**  > **My Stuff** > **Applications**.
2. Tap **Browser** > **Manage** > **Download Manager**.

Profile settings

You can set profile and view **Profile Name**, **Home URL**, **Connection Type**, **Proxy Address** and **Proxy Port**.

Viewing default profile

1. Tap **Menu**  > **My Stuff** > **Applications**.
2. Tap **Browser** > **Manage** > **Profiles**.
3. Tap  to view the detail.

Adding new profile

1. Tap **Create**.
2. Tap each field to enter the field > **OK**.
3. Tap **Save**.

Editing profile

1. Scroll and tap  beside the default profile.
2. Tap the field to edit > **OK**.
3. Tap **Save**.

Deleting profile

1. Tap **Delete**.
2. Tap to mark desired profiles to delete beside the default profile.
3. Tap **All** to mark all profiles.
4. Tap **Delete**.

01

02

03

04

05

06

07

08



pursuit™

7

Settings

Phone
Ring tones
Display
Touch
Locks
Reset
TTY

Phone

Setting time & date

1. Tap **Menu** > **Settings** > **Phone**.
2. Tap **Time & Date**.
3. Change **Time Format**, **Date Format** or **Auto Update** > **Save**.

Setting shake actions

1. Tap **Menu** > **Settings** > **Phone**.
2. Tap **Shake Actions**.
3. Drag the **Music Auto Play**, **Music Next Play**, **Incoming Call Vibration**, **Alarm Snooze**, **Calculator Clear**, **Tip Calculator Reset** and **Random World Time** bar to **On** or **Off**.
4. Tap **Save**.

Ring tones

Setting ring tones

1. Tap **Menu** > **My Stuff** > **Audio**.
2. Scroll and tap to select the folder.
3. Tap of file > **Set as Ring Tone**.

note: The maximum ringtone file size is 300KB.

Setting sound profile

1. Tap **Menu** > **Settings** > **Profiles**.
2. Select **Normal**, **Outdoor**, **Vibrate only**, **Silent** or **Flight Mode**.

note: Tap to change **Call**, **Message** and **Phone**. Each category has options to change. Change the options and tap **Save**.

Display

Shopping home screen

1. Tap **Menu** > **Settings** > **Display**.
2. Tap **Shop Wallpapers**.

Setting the home screen

Setting wallpaper

1. Tap **Menu** > **Settings** > **Display**.
2. Tap **Home Screen**.
3. Tap **Wallpaper**.
4. To set a pre-installed wallpaper, tap **Special Wallpaper**.
To set other images, tap **User Wallpaper**.
5. In **Special Wallpaper**, scroll left or right to view > **Select**.
In **User Wallpaper**, tap the folder.
6. Scroll and tap to select the file > **Select**.

Setting clock

1. Tap **Menu** > **Settings** > **Display**.
2. Tap **Home Screen**.
3. Tap **Clock Type**.
4. Flick to view the clock types > **Select**.

Setting the font

1. Tap **Menu** > **Settings** > **Display**.
2. Tap **Font Style**.
3. Scroll and tap to select the font type > **Save**.

Setting the brightness

1. Tap **Menu** > **Settings** > **Display**.
2. Tap **Brightness**.
3. Drag the bar left or right > **Save**.

note: Modifying brightness may affect battery life.

Setting time for backlight

1. Tap **Menu** > **Settings** > **Display**.
2. Tap **Backlight Timer**.
3. Tap to set the time of **Main LCD** and **Keypad** > **Save**.

note: Modifying backlight time may affect battery life.

Touch

Setting touch feedback

1. Tap **Menu** > **Settings** > **Touch**.
2. Tap **Touch Feedback**.
3. Change the **Touch Feedback Type** and **Touch Volume** or **Vibration Intensity** > **Save**.

note: The **Touch Volume** and **Vibration Intensity** availability depends on the phone's setting.

Setting touch calibration

1. Tap **Menu** > **Settings** > **Touch**.
2. Tap **Calibration**.
3. Tap the on the screen.

Setting touch lock automatically

1. Tap **Menu** > **Settings** > **Touch**.
2. Tap **Auto Screen Lock**.
3. Drag the bar to **On** or **Off** > **Save**.

note: It will lock automatically after the backlight is turned off.

Locks

Locking the phone

1. Tap **Menu**  > **Settings** > **Security**.
2. Drag the **Phone Lock** bar to **On** or **Off**.
3. Enter password.

note: The default password is '1234'. To change the password tap **Menu**  > **Settings** > **Security** > **Change Password**.

Locking the PIN

The Personal Identification Number is the security code that protects the phone or SIM against unauthorized use.

1. Tap **Menu**  > **Settings** > **Security**.
2. Drag the **PIN** bar to **On** or **Off**.
3. Tap **Yes** for enable unlock.

note: To change the PIN code tap **Menu**  > **Settings** > **Security** > **Change PIN**.

Locking the FDN

1. Tap **Menu**  > **Settings** > **Security**.
2. Drag the **FDN** bar to **On** or **Off**.
3. Enter PIN2 code.

note: You have only 3 trials. If you enter the wrong code 3 times, the phone will be locked. If the phone locks, please contact the service center. For details on fixed dialing, see page 37.

Changing PIN 2

1. Tap **Menu**  > **Settings** > **Security**.
2. Tap **Change PIN2**.
3. Enter the PIN2 code > **OK**.
4. Enter the new PIN2 code > **OK**.

Changing hidden key

The hidden key is a security code for USIM Contact. You can lock the person's information in the USIM Contacts with the hidden key.

1. Tap **Menu**  > **Settings** > **Security**.
2. Tap **Change Hidden Key**.

note: The default password is dependent on the SIM card (either depends on the SIM card or determined by the SIM card).

Reset

Resetting the phone

1. Tap **Menu**  > **Settings** > **Reset**.
2. Enter password > **Master Reset**.
3. Tap **Yes** or **No**.

note: It will return configuration settings to default. The default password is '1234'.

Clearing the phone

1. Tap **Menu**  > **Settings** > **Reset**.
2. Enter password > **Master Clear**.
3. Tap **Yes** or **No**.

note: It will change the setting as default and erase all personal data. The default password is '1234'.

TTY

The teletypewriter (TTY) is a telecommunications device that allows people who are deaf or hard of hearing, or who have speech or language disabilities, to communicate via a telephone.

Setting teletypewriter

1. Tap **Menu**  > **Settings** > **TTY**.
2. Select **Disable**, **TTY Full**, **TTY Talk** or **TTY Hear**.
 - **Disable:** TTY mode is disabled.
 - **TTY Full:** Users who cannot talk and hear, can send and receive a text messages.
 - **TTY Talk:** Users who can talk but cannot hear, can receive text messages and reply with voice message.
 - **TTY Hear:** Users who can hear but cannot talk, can send a text message and receive a voice message.



pursuit

8

Appendix

Alert message
Troubleshooting checklist
Safety information
Safety precautions
About the battery usage
FCC Hearing-Aid Compatibility (HAC) Regulations for Wireless Devices
FCC Regulatory Compliance
Warranty

Alert message

If you experience any problem while using your mobile phone, please refer to the following checklist. If the problem still persists, contact your dealer or nearest carrier.

When the “Insert SIM Card” message appears:

Make sure the SIM card is correctly installed. Check to see if the SIM card is working properly. If it does not work, try to clean the contact points of the card with a dry cloth. If it is out of order, take it to your service provider.

When the “Messages full” message appears:

The received or saved messages are full in your phone memory. You need to delete some messages.

When the “Phone and SIM messages is full. Delete Messages” message appears:

The received or saved messages are full in your phone and SIM card memory. You need to delete some messages.

When the “Password” message appears in Phone locked state:

Enter the phone password. The default password is “1234”. If you cannot remember the password, contact the nearest carrier.

When the “Enter PIN1” message appears:

Input PIN1. If you cannot remember it, contact your service provider. You

can still receive calls even if your mobile phone becomes locked after entering the incorrect PIN1 on three consecutive attempts.

When the “No Service” or “Network Search” appears:

If you cannot make/receive a call when you are indoors or underground where the signal strength is poor, move toward a window or go out to an open area. If you still cannot make a connection, contact your service provider.

Troubleshooting checklist

When audio quality is poor:

End a call and try again.

When the other party cannot hear you speaking:

Your phone may be set to MUTE. Disable the MUTE function. Or your hand may be covering the microphone located below the .

When battery lifetime is shorter than usual:

This may happen when you are in an area with low signal strength. Turn off your phone when it is not in use. Change the battery when battery energy is exhausted.

When your mobile phone does not turn on:

Make sure your battery is charged. Check to see if your phone works while recharging the battery.

When you are unable to send a message:

Either you are not registered to receive an SMS service, or you may be in an area where your network service provider cannot provide such a service.

When you are unable to make a call:

Your phone may be set to “fixed dial.” Cancel the “fixed dial” function.

When you are unable to charge the battery:

This may be the result of one of the following three cases.

1. Your charger may be out of order. Contact your nearest dealer.
2. You may be attempting to use the phone in an overly hot/cold temperature. Try changing the charging environment.
3. Your battery may have not been connected to the charger properly. Check the connector.

When you are unable to input data into your Address Book:

Your Address Book memory may be full. Try deleting some entries from your Address Book.

When you are unable to select a certain function:

You may not have subscribed to that function, or your network service provider may be in an area where such service cannot be provided. Contact your local service provider.



Safety information

The following list shows how to maintain your mobile phone, together with precautions to take.

- Keep your mobile phone and its accessories out of the reach of children and pets.
- Maintain your mobile phone in dry conditions and keep it within normal operating temperatures. Temperatures higher than 55°C (131°F) or lower than -20°C (-4°F) may damage your phone.
- Do not try to dry your phone in a microwave oven. If not, sparks can occur and cause an explosion or fire.
- Do not use or store your mobile phone in dusty, dirty areas.
- Do not attempt to disassemble your mobile phone.
- Do not drop or cause severe impact to your mobile phone.
- Do not use chemical products, cleaning solvents or detergents to clean your mobile phone.
- If your mobile phone does not work properly, contact your dealer immediately.
- Use only authorized batteries, battery chargers and accessories. Any malfunction or damage caused by the use of unauthorized batteries, battery chargers and accessories will void the limited product warranty.
- Ensure that the battery and battery charger do not come in contact with conductive objects.

Safety precautions

Using a mobile phone while driving may be prohibited.

Please check local laws and regulations with regard to the prohibition of mobile phone use while driving, and comply with them.

Use of your phone while you are driving may disturb your concentration and so cause an accident. Always switch your phone off to drive safely. You should use your phone in an emergency, either use a hands free device built into your car or pull over in a safe place first.



Switch off in restricted areas

Always switch your phone off in areas where mobile phone use is restricted.



Switch off in explosive or dangerous areas

Always switch your phone off in areas with explosive or dangerous materials (such as fuels, fuel stations or areas containing chemical goods) and obey any instructions or signals. Do not remove your mobile phone's battery in such areas.



Switch off in aircraft

Always switch your phone off or select **Flight Mode** (Tap the **Menu**  > **Settings** > **Profiles** > **Flight Mode**) when you are in an aircraft. The electromagnetic waves emitted by your phone may affect the electronic navigation equipment in the aircraft.



Switch off in hospitals and near medical equipment

Always switch your phone off in hospitals, and obey the regulations or rules of the hospital.

Switch your phone off when using medical equipment for private purposes, if possible. Always consult with the medical equipment's manufacturer or an expert regarding phone use near the medical equipment.



Installing a hands free device in your vehicle

Install vehicle hands free devices away from the steering wheel and airbag expansion area, otherwise injury may result.



Mobile phones and other electronic devices

Mobile phones emit electromagnetic waves that may affect nearby electronic devices. When it is switched on, do not place your phone close to delicate electronic equipment.



About the battery usage

Your phone is powered by a Lithium Ion (Li-Ion) battery. This means that, unlike other forms of battery technology, you can recharge your battery while some charge remains without reducing your phone's autonomy due to the "battery memory effect" inherent in those technologies.

- Do not use a damaged battery or charger.
- Do not disassemble or open crush, bend or deform, puncture or shred.

- Do not modify or remanufacture, attempt to insert foreign objects into the battery, immerse or expose to water or other liquids, expose to fire, explosion or other hazard.
- Do not put your battery into contact with conductive objects.
- Dispose of and recycle used batteries in accordance with local regulations. Do not dispose of batteries by burning; they may explode.
- Do not use an unauthorized charger.
- Only use the battery for the device for which it is specified.
- Only use the battery with a charging device that has been qualified with the device per this standard. Use of an unqualified battery or charger may present a risk of fire, explosion, leakage, or other hazard.
- Do not short circuit a battery or allow metallic conductive objects to contact battery terminals.
- Replace the battery only with another battery that has been qualified with the device per this standard, IEEE-Std-1725-2006. Use of an unqualified battery may present a risk of fire, explosion, leakage or other hazard.
- Promptly dispose of used batteries in accordance with local regulations
- Battery usage by children should be supervised.
- Avoid dropping the phone or battery. If the phone or battery is dropped, especially on a hard surface, and the user suspects damage, take it to a service center for inspection.
- Use your battery for the specified purpose only.

- The closer you are to your network's base station, the longer your phone usage time because less battery power is consumed for the connection.
- The battery recharging time varies depending on the remaining battery capacity and the battery and charger type you use.
- Battery life inevitably shortens over time.
- Use an authorized battery and charger only.
- Since overcharging may shorten battery life, remove the phone from its charger once it is fully charged. Unplug the charger, once charging is complete. Leaving the battery in hot or cold places, especially inside a car in summer or winter, may reduce the capacity and life of the battery. Always keep the battery within normal temperatures.
- To prevent injury or burns, ensure that no metal objects come into contact with the + and – terminals of the battery.

FCC Hearing-Aid Compatibility (HAC) Regulations for Wireless Devices

On July 10, 2003, the U.S. Federal Communications Commission (FCC) Report and Order in WT Docket 01-309 modified the exception of wireless phones under the Hearing Aid Compatibility Act of 1988 (HAC Act) to require digital wireless phones be compatible with hearing-aids. The intent of the HAC Act is to ensure reasonable access to telecommunications services for persons with hearing disabilities.

01

02

03

04

05

06

07

08

While some wireless phones are used near some hearing devices (hearing aids and cochlear implants), users may detect a buzzing, humming, or whining noise. Some hearing devices are more immune than others to this interference noise, and phones also vary in the amount of interference they generate.

The wireless telephone industry has developed a rating system for wireless phones, to assist hearing device users find phones that may be compatible with their hearing devices. Not all phones have been rated. Phones that are rated have the rating on their box or a label located on the box.

The ratings are not guarantees. Results will vary depending on the user's hearing device and hearing loss. If your hearing device happens to be vulnerable to interference, you may not be able to use a rated phone successfully. Trying out the phone with your hearing device is the best way to evaluate it for your personal needs.

- **M-Ratings:** Phones rated M3 or M4 meet FCC requirements and are likely to generate less interference to hearing devices than phones that are not labeled. M4 is the better/higher of the two ratings.
- **T-Ratings:** Phones rated T3 or T4 meet FCC requirements and are likely to generate less interference to hearing devices than phones that are not labeled. T4 is the better/higher of the two ratings.

Hearing devices may also be rated. Your hearing device manufacturer or hearing health professional may help you find this rating. Higher ratings mean that the hearing device is relatively immune to interference

noise. The hearing aid and wireless phone rating values are then added together. A sum of 5 is considered acceptable for normal use. A sum of 6 is considered for best use.



In the above example, if a hearing aid meets the M2 level rating and the wireless phone meets the M3 level rating, the sum of the two values equal M5. This is synonymous for T ratings. This should provide the hearing aid user with "normal usage" while using their hearing aid with the particular wireless phone. "Normal usage" in this context is defined as a signal quality that is acceptable for normal operation.

The M mark is intended to be synonymous with the U mark. The T mark is intended to be synonymous with the UT mark. The M and T marks are recommended by the Alliance for Telecommunications Industries Solutions (ATIS). The U and UT marks are referenced in Section 20.19 of the FCC Rules. The HAC rating and measurement procedure are described in the American National Standards Institute (ANSI) C63.19 standard.

To ensure that the Hearing Aid Compatibility rating for your phone is maintained, secondary transmitters such as Bluetooth and WLAN components must be disabled during a call. See Page 72 for instructions to disable these components.

FCC Regulatory Compliance

FCC Regulatory Compliance

This device complies with Part 15 of the FCC Rules. Operation is subject to the following two conditions: (1) this device may not cause harmful interference, and (2) this device must accept any interference received, including interference that may cause undesired operation.

Your mobile device is a low power radio transmitter and receiver. When it is ON, it receives and also sends out radio frequency (RF) signals. In August 1996, the Federal Communications Commission (FCC) adopted RF exposure guidelines with safety levels for mobile devices. Those guidelines are consistent with safety standards previously set by both U.S. and international standards bodies: American National Standard Institute (ANSI), National Council of Radiation Protection and Measurements (NCRP), and International Commission on Non-Ionizing Radiation Protection (ICNRP). Those standards were based on comprehensive and periodic evaluations of the relevant scientific literature. The design of your phone complies with the FCC guidelines and applicable.

Statement according to FCC part 15.105

note: This equipment has been tested and found to comply with the limits for a Class B digital device, pursuant to Part 15 of the FCC Rules. These limits are designed to provide reasonable protection against harmful interference in a residential installation. This equipment generates uses and can radiate radio frequency energy and, if not installed and used in

accordance with the instructions, may cause harmful interference to radio communications. However, there is no guarantee that interference will not occur in a particular installation. If this equipment does cause harmful interference to radio or television reception, which can be determined by turning the equipment off and on, the user is encouraged to try to correct the interference by one or more of the following measures:

- Reorient or relocate the receiving antenna.
- Increase the separation between the equipment and receiver.
- Connect the equipment into an outlet on a circuit different from that to which the receiver is connected.
- Consult the dealer or an experienced radio/TV technician for help.

Statement according to FCC part 15.21

Modifications not expressly approved by this company could void the user's authority to operate the equipment.

RF exposure FCC

For body worn operation, to maintain compliance with FCC RF exposure guidelines, use only accessories that contain no metallic components and provide a separation distance of 20 mm (0.6 inches) to the body. Use of other accessories may violate FCC RF exposure guidelines and should be avoided.

This device and its antenna must not be co-located or operating in conjunction with any other antenna or transmitter.

Health and Safety Information FCC

This EUT has been shown to be capable of compliance for localized specific absorption rate (SAR) for uncontrolled environment/general population exposure limits specified in ANSI/IEEE Std. C95.1-1992 and had been tested in accordance with the measurement procedures specified in FCC/OET Bulletin 65 Supplement C (2001) and IEEE Std. 1528-2003 Ministry of Health (Canada), Safety Code 6. The standards include a substantial safety margin designed to assure the safety of all persons, regardless of age and health. The exposure standard for wireless mobile phones employs a unit of measurement known as the Specific Absorption Rate, or SAR. The SAR limit set by the FCC is 1.6W/kg *.

* In the U.S. and Canada, the SAR limit for mobile phones used by the public is 1.6 watts/kg (W/kg) averaged over one gram of tissue. The standard incorporates a substantial margin of safety to give additional protection for the public and to account for any variations in.

**This device contains 1800 MHz GSM functions that are not operational in U.S. Territories; this filing is applicable only for 850 MHz GSM and 1900 MHz PCS operations.

Warranty

Protect Your Warranty

Read your Warranty carefully, with the special consideration to paragraph seven of the Limited Warranty for your unit.

"Warranty does not apply to... or to any product or part thereof which has suffered through alteration... mishandling, misuse, neglect or accident".

Many companies are making look alike accessories and in some cases, promoting that their product is equal to or better than the Pantech product. Be careful. Some of these products may not be compatible to use with your Pantech product and may damage the unit or cause it to malfunction.

If service is required on your unit and it is determined that a non-Pantech accessory has created the problem with your unit, the Warranty will not apply. In addition, if the unit has already suffered irreversible damage by reason of a non-compatible accessory, the Warranty will be voided. To protect your Warranty, use only compatible accessories which cannot damage or interfere with the functioning of your Pantech product.

12 Month Limited Warranty

Pantech Wireless, Inc. (the Company) warrants to the original retail purchaser of this Pantech handheld portable cellular telephone, that should this product or any part thereof during normal consumer usage and conditions, be proven defective in material or workmanship that results in product failure within the first twelve (12) months period from the date of purchase, such defect(s) will be repaired or replaced (with new or rebuilt parts) at the Company's option, without charge for parts or labor directly related to the defect(s).

The antenna, key pad, display, rechargeable battery and battery charger, if included, are similarly warranted for twelve (12) months from date of purchase. This Warranty extends only to consumers who purchase the product in the United States or Canada and it is not transferable or assignable.

This Warranty does not apply to:

- Product subjected to abnormal use or conditions, accident, mishandling, neglect, unauthorized alteration, misuse, improper installation or repair or improper storage;
- Product whose mechanical serial number or electronic serial number has been removed, altered or defaced.
- Damage from exposure to moisture, humidity, excessive temperatures or extreme environmental conditions;
- Damage resulting from connection to, or use of any accessory or other product not approved or authorized by the Company;
- Defects in appearance, cosmetic, decorative or structural items such as framing and non-operative parts;
- Product damaged from external causes such as fire, flooding, dirt, sand, weather conditions, battery leakage, blown fuse, theft or improper usage of any electrical source.

The Company disclaims liability for removal or reinstallation of the product, for geographic coverage, for inadequate signal reception by the antenna or for communications range or operation of the cellular system as a whole.

To obtain repairs or replacement within the terms of this Warranty, the product should be delivered with proof of Warranty coverage (e.g. dated bill of sale), the consumer's return address, daytime phone number and/or fax number and complete description of the problem, transportation prepaid, to the Company by calling the number listed below or to the place of purchase for repair or replacement processing.

To locate Pantech Authorized Service Center, call: (800) 962-8622 or email HandsetHelp@Pantech.com.

Please have the following information available when you send the phone in for repair:

- A valid original Proof of Purchase
- Return address
- Daytime phone number or fax number
- Model #
- IMEI # (Look for the 15 digit IMEI # behind the battery of the device.)
- Complete description of the problem
- Transportation prepaid

Other Warranty Program

You may have other warranty program with your purchase, such as warranty exchange. If so, please refer to equipment package or the original point of sale.

THE EXTENT OF THE COMPANY'S LIABILITY UNDER THIS WARRANTY IS LIMITED TO THE REPAIR OR REPLACEMENT PROVIDED ABOVE AND, IN NO EVENT, SHALL THE COMPANY'S LIABILITY EXCEED THE PURCHASE PRICE PAID BY PURCHASER FOR THE PRODUCT.

ANY IMPLIED WARRANTIES, INCLUDING ANY IMPLIED WARRANTY OF MERCHANTABILITY OR FITNESS FOR A PARTICULAR PURPOSE, SHALL BE LIMITED TO THE DURATION OF THIS WRITTEN WARRANTY. ANY ACTION FOR BREACH OF ANY WARRANTY MUST BE BROUGHT WITHIN A PERIOD OF 18 MONTHS FROM DATE OF ORIGINAL PURCHASE. IN NO CASE SHALL THE COMPANY BE LIABLE FOR ANY SPECIAL CONSEQUENTIAL OR INCIDENTAL DAMAGES FOR BREACH OF THIS OR ANY OTHER WARRANTY, EXPRESS OR IMPLIED, WHATSOEVER. THE COMPANY SHALL NOT BE LIABLE FOR THE DELAY IN RENDERING SERVICE UNDER THIS WARRANTY OR LOSS OF USE DURING THE TIME THE PRODUCT IS BEING REPAIRED OR REPLACED.

No person or representative is authorized to assume for the Company any liability other than expressed herein in connection with the sale of this product.

Some states or provinces do not allow limitations on how long an implied warranty lasts or the exclusion or limitation of incidental or consequential damage so the above limitation or exclusions may not apply to you. This Warranty gives you specific legal rights, and you may also have other rights which vary from state to state or province to province.

For technical support in the U.S. & Canada, call (800) 962-8622.

Or email: HandsetHelp@Pantech.com.
Or visit the web site: www.pantechusa.com

For all other inquiry, write to:

PANTECH WIRELESS, INC.
5607 Glenridge Dr. Suite 500 Atlanta, GA 30342

01

02

03

04

05

06

07

08