



ENGLISH

User Guide

**LG-P990**



**CE 0168** 

P/N : MFL67121832 (1.2) 

[www.lg.com](http://www.lg.com)

Bluetooth QD ID B017628



# LG-P990 User Guide - English

- Some of contents of this manual may not apply to your phone depending on your phone's software or your service provider.
- This handset is not recommended for the visually impaired because of its touch-screen keypad.
- Copyright © LG Electronics, Inc. All rights reserved. LG and the LG logo are registered trademarks of LG Group and its related entities. All other trademarks are the property of their respective owners.
- Google Search™, Maps, Gmail™, YouTube™, Talk™ and Market™ are trademarks of Google, Inc.



# Contents

<b>Guidelines for safe and efficient use.....</b>	<b>5</b>	<b>Your Home screen.....</b>	<b>28</b>
<b>Important notice.....</b>	<b>12</b>	Touch-screen tips.....	28
1. Phone memory.....	12	Lock your phone .....	28
2. Optimising battery life.....	12	Unlock screen .....	29
3. Installing an open source OS.....	13	Home .....	29
4. Using unlock pattern.....	14	Setting the number of home screens .....	29
5. Using hard reset.....	15	Adding widgets to your home screen .....	30
6. Connecting to Wi-Fi networks.....	15	Getting back to a recently used application .....	31
7. Opening and switching applications.....	16	Home preview function .....	31
8. Installing the LG PC suite on your PC.....	17	Capturing the screen.....	31
9. Connecting your phone to a computer via USB.....	19	Notification drawer .....	31
10. Unlock screen when using data connection .....	20	Viewing the status bar .....	32
11. Do not connect your phone when you power on/off your PC .....	20	Onscreen keyboard .....	34
12. Hold your phone upright .....	20	<b>Google Account Set-up .....</b>	<b>35</b>
13. If the screen freezes.....	21	Creating your Google account... ..	35
<b>Getting to know your phone.....</b>	<b>22</b>	Signing in to your Google account.....	35
Installing the SIM card and battery .....	24	<b>Calls/Contacts .....</b>	<b>37</b>
Charging your phone .....	25	Making a voice call.....	37
Installing the memory card .....	26	Making a video call .....	37
Formatting the memory card.....	27	Calling your contacts.....	38
		Answering and rejecting a call .....	38
		Adjusting call volume.....	38
		Viewing your call logs .....	38
		Call settings.....	39

Searching for a contact .....	39	<b>Multimedia .....</b>	<b>55</b>
Adding a new contact.....	39	Gallery .....	55
Favourite contacts .....	40	To change how the contents	
<b>Messaging/E-mail .....</b>	<b>41</b>	of an album are displayed.....	55
Messaging.....	41	Using SmartShare .....	55
Sending a message.....	41	Music .....	56
Changing your message settings.....	42	Playing a song .....	56
Opening your email and email		Using the radio.....	57
accounts screen.....	42	Searching for stations.....	58
Composing and sending email ..	43	Listening to the radio.....	58
Adding and editing email accounts ..	44	Transferring files using	
<b>Social networking .....</b>	<b>45</b>	USB mass storage devices .....	58
Adding your account to your		How to save music/video files	
phone .....	45	to your phone.....	59
<b>Camera .....</b>	<b>46</b>	How to move contacts from your	
Getting to know the viewfinder ..	46	old phone to your current phone	60
Taking a quick photo .....	47	How to send data from your	
Once you've taken the photo ....	47	phone via Bluetooth.....	60
Using the advanced settings .....	48	<b>Google applications.....</b>	<b>63</b>
Using the focus mode.....	50	Maps.....	63
<b>Video camera .....</b>	<b>51</b>	Market.....	63
Getting to know the viewfinder ..	51	Gmail.....	63
Shooting a quick video .....	52	Talk .....	63
After shooting a video.....	52	Google Search .....	64
Using the advanced settings .....	52	YouTube.....	64
Watching your saved videos.....	54	<b>Utilities .....</b>	<b>65</b>
Adjusting the volume when		Setting your alarm.....	65
viewing a video .....	54	Using your calculator .....	65

# Contents

Adding an event to your calendar	65	Sharing your phone's data connection	78
<b>Utilities</b>	<b>66</b>	USB tethering & portable	
Home Time Zone	66	Wi-Fi hotspot settings	79
Recording a sound or voice	66	USB tethering and data sharing	79
<b>The Web</b>	<b>68</b>	To share your phone's data connection as a portable Wi-Fi hotspot	80
Browser	68	How to use On-Screen Phone	81
Using options	68	On-Screen Phone icons	81
<b>Settings</b>	<b>69</b>	On-Screen Phone features	81
Wireless & networks	69	How to install On-Screen Phone on your PC	82
Call settings	70	How to connect your mobile phone to your PC	82
Sound	71	To check the phone to PC connection	83
Display	72	To disconnect your phone from your PC	84
Gesture	73	Phone Software update	84
Location & security	73	F-Secure Mobile Security	85
Applications	74	Remote Call	85
Accounts & sync	74	<b>Copyrights and trademarks</b>	<b>86</b>
Privacy	75	<b>Accessories</b>	<b>88</b>
SD card & phone storage	75	<b>Technical data</b>	<b>89</b>
Language & keyboard	76	<b>Troubleshooting</b>	<b>90</b>
Voice input & output	76		
Accessibility	76		
HDMI	76		
Date & time	77		
About phone	77		
Wi-Fi	77		
Turn on Wi-Fi	77		
To connect to Wi-Fi	78		

## Guidelines for safe and efficient use

Please read these simple guidelines. Not following these guidelines may be dangerous or illegal.

### Exposure to radio frequency energy

Radio wave exposure and Specific Absorption Rate (SAR) information. This mobile phone model LG-P990 has been designed to comply with applicable safety requirements for exposure to radio waves. These requirements are based on scientific guidelines that include safety margins designed to assure the safety of all persons, regardless of age and health.

- The radio wave exposure guidelines employ a unit of measurement known as the Specific Absorption Rate, or SAR. Tests for SAR are conducted using standardised methods

with the phone transmitting at its highest certified power level in all used frequency bands.

- While there may be differences between the SAR levels of various LG phone models, they are all designed to meet the relevant guidelines for exposure to radio waves.
- The SAR limit recommended by the International Commission on Non-Ionizing Radiation Protection (ICNIRP) is 2W/kg averaged over 10g of tissue.
- The highest SAR value for this model phone tested by DASY4 for use at the ear is 0.545 W/kg (10 g) and when worn on the body is 0.897 W/kg(10 g).

## Guidelines for safe and efficient use

- SAR data information for residents in countries/regions that have adopted the SAR limit recommended by the Institute of Electrical and Electronics Engineers (IEEE), which is 1.6 W/kg averaged over 1g of tissue.
- Repairs under warranty, at LG's discretion, may include replacement parts or boards that are either new or reconditioned, provided that they have functionality equal to that of the parts being replaced.

### Product care and maintenance



#### **WARNING**

Only use batteries, chargers and accessories approved for use with this particular phone model. The use of any other types may invalidate any approval or warranty applying to the phone and may be dangerous.

- Do not disassemble this unit. Take it to a qualified service technician when repair work is required.
- Keep away from electrical appliances such as TVs, radios, and personal computers.
- The unit should be kept away from heat sources such as radiators or cookers.
- Do not drop.
- Do not subject this unit to mechanical vibration or shock.
- Switch off the phone in any area where you are required to by special regulations. For example, do not use your phone in hospitals as it may affect sensitive medical equipment.
- Do not handle the phone with wet hands while it is being



charged. It may cause an electric shock and can seriously damage your phone.

- Do not charge a handset near flammable material as the handset can become hot and create a fire hazard.
- Use a dry cloth to clean the exterior of the unit (do not use solvents such as benzene, thinner or alcohol).
- Do not charge the phone when it is on soft furnishings.
- The phone should be charged in a well ventilated area.
- Do not subject this unit to excessive smoke or dust.
- Do not keep the phone next to credit cards or transport tickets; it can affect the information on the magnetic strips.
- Do not tap the screen with a sharp object as it may damage the phone.

- Do not expose the phone to liquid or moisture.
- Use the accessories like earphones cautiously. Do not touch the antenna unnecessarily.
- Your phone is an electronic device that generates heat during normal operation. Extremely prolonged, direct skin contact in the absence of adequate ventilation may result in discomfort or minor burns. Therefore, use care when handling your phone during or immediately after operation.

## **Efficient phone operation**

### **Electronic devices**

All mobile phones may receive interference, which could affect performance.

- Do not use your mobile phone near medical equipment without requesting permission.

## Guidelines for safe and efficient use

Avoid placing the phone over pacemakers, for example, in your breast pocket.

- Some hearing aids might be disturbed by mobile phones.
- Minor interference may affect TVs, radios, PCs, etc.

### Road safety

Check the laws and regulations on the use of mobile phones in the area when you drive.

- Do not use a hand-held phone while driving.
- Give full attention to driving.
- Use a hands-free kit, if available.
- Pull off the road and park before making or answering a call if driving conditions require you to do so.

- RF energy may affect some electronic systems in your vehicle such as car stereos and safety equipment.
- If your vehicle is equipped with an air bag, do not obstruct with installed or portable wireless equipment. It can cause the air bag to fail or cause serious injury due to improper performance.
- If you are listening to music whilst out and about, please ensure that the volume is at a reasonable level so that you are aware of your surroundings. This is of particular importance when near roads.

### Avoid damage to your hearing

Damage to your hearing can occur if you are exposed to loud sounds for long periods of time.

We therefore recommend that you do not turn the handset on or off close to your ear. We also recommend that music and call volumes are set to a reasonable level.

**NOTE:** Excessive sound pressure from earphones can cause hearing loss.

## Glass Parts

Some parts of your mobile device are made of glass. This glass could break if your mobile device is dropped on a hard surface or receives a substantial impact. If the glass breaks, do not touch or attempt to remove. Stop using your mobile device until the glass is replaced by an authorised service provider.

## Blasting area

Do not use the phone where blasting is in progress. Observe restrictions, and follow any regulations or rules.

## Potentially explosive atmospheres

- Do not use your phone at a refuelling point.
- Do not use near fuel or chemicals.
- Do not transport or store flammable gas, liquid or explosives in the same compartment of your vehicle as your mobile phone or accessories.

## Guidelines for safe and efficient use

### In aircraft

Wireless devices can cause interference in aircraft.

- Turn your mobile phone off before boarding any aircraft.
- Do not use it on the ground without permission from the crew.

### Children

Keep the phone in a safe place out of the reach of small children. It includes small parts which may cause a choking hazard if detached.

### Emergency calls

Emergency calls may not be available on all mobile networks. Therefore you should never depend solely on your phone for emergency calls. Check with your local service provider.

### Battery information and care

- You do not need to completely discharge the battery before recharging. Unlike other battery systems, there is no memory effect that could compromise the battery's performance.
- Use only LG batteries and chargers. LG chargers are designed to maximise battery life.
- Do not disassemble or short-circuit the battery pack.
- Keep the metal contacts of the battery pack clean.
- Replace the battery when it no longer provides acceptable performance. The battery pack may be recharged hundreds of times before it needs replacing.
- Recharge the battery if it has not been used for a long time to maximise usability.

- Do not expose the battery charger to direct sunlight or use it in high humidity, such as in the bathroom.
- Do not leave the battery in hot or cold places, as this may deteriorate battery performance.
- There is risk of explosion if the battery is replaced with an incorrect type.
- Dispose of used batteries according to the manufacturer's instructions. Please recycle when possible. Do not dispose as household waste.
- If you need to replace the battery, take it to your nearest authorised LG Electronics service point or dealer for assistance.
- Always unplug the charger from the wall socket after the phone is fully charged to save unnecessary power consumption of the charger.
- Actual battery life will depend on network configuration, product settings, usage patterns, battery and environmental conditions.

## Important notice

Please check to see if any problems you have encountered with your phone are described in this section, before taking the phone in for service or calling a service representative.

### 1. Phone memory

When available space on your phone memory is less than 2%, your phone can not receive new messages. You will need to check your phone memory and delete some data, such as applications or messages to make more memory available.

#### To manage the application:

- 1 On the home screen, touch **Applications** tab  and select **Settings > Applications > Manage applications**.
- 2 When all applications appear, scroll and select the application you want to uninstall.

- 3 Tap **Uninstall** and touch OK to uninstall application you desired.

### 2. Optimising battery life

You can extend your battery's life between charges by turning off features that you don't need constantly running in the background. You can also monitor how applications and system resources consume battery power.

#### To extend the life of your battery:

- Turn off radio communications that you aren't using. If you aren't using Wi-Fi, Bluetooth, or GPS, turn them off.
- Turn down screen brightness and set a shorter screen timeout.
- Turn off automatic syncing for Gmail, Calendar, Contacts, and other applications.

- Some applications you have downloaded may cause your battery's life to be reduced.

#### **To check the battery charge level:**

- 1 On the home screen, touch **Applications** tab  and select **Settings > About phone > Status**.
- 2 The battery status (charging, discharging) and level (as a percentage of fully charged) are displayed at the top of the screen.

#### **To monitor and control what uses the battery:**

- 1 On the home screen, touch **Applications** tab  and select **Settings > About phone > Battery use**.
- 2 The top of the screen displays battery usage time. This is either how long since your

phone was last connected to a power source or if connected to a power source, how long since your phone was last run on battery power. The body of the screen lists applications or services using battery power from greatest amount to least.

### **3. Installing an open source OS**

If you install an open source OS on your phone, and you do not use the OS provided by the manufacturer, this may cause your phone to malfunction.



#### **WARNING**

If you install and use an OS other than the one provided by the manufacturer, your phone is no longer covered by the warranty.

## Important notice

### **WARNING**

To protect your phone and personal data, only download applications from trusted sources, such as Market. If some applications are not properly installed on your phone, your phone may not work properly or serious error may occurred. You will need to uninstall these applications and all of their data and settings from the phone.

## 4. Using unlock pattern

Set unlock pattern to secure your phone. Opens a set of screens that guide you through drawing a screen unlock pattern.

You can draw your own unlock pattern by connecting four or more dots.

If you set a pattern, the phone screen will lock. To unlock the phone, draw the pattern you have set on the screen.

**Caution:** When you set an unlock pattern, you need to create your Google account first.

### **WARNING**

#### **Precautions to take when using the Pattern Lock**

It is very important that you remember the unlock pattern you set. You have five chances to enter your unlock pattern, PIN or password. If you have used all five chances, you can try again after 30 seconds.

#### **If you can't recall your unlock pattern, PIN or password:**

If you have tried to log on to your Google account on the phone and failed to use correct pattern five times, tap the Forgot pattern button. You will then be required to sign in with your Google account to unlock your phone.



If you haven't created a Google account on the phone or you forgot it, you need to perform a factory reset.

## 5. Using hard reset

If it does not restore to the original condition, use **Hard Reset (Factory Reset)** to initialise your phone.

When the phone is turned off, press and hold the **Power + Volume down** keys at the same time (for over ten seconds), the phone will turn on and perform factory reset immediately. Please note, after you perform **Hard Reset**, all your data and applications on your phone will be erased. This cannot be reversed.



### **WARNING**

If you perform **Hard Reset**, all user applications and user data will be deleted. Please remember to back up any important data before performing a **Hard Reset**.

## 6. Connecting to Wi-Fi networks

To use Wi-Fi on your phone, you need to access a wireless access point or “hotspot.” Some access points are open and you can simply connect to them. Others are hidden or implement other security features, so you must configure your phone to connect to them.

Turn off Wi-Fi when you're not using it to extend the life of your battery.

## Important notice

### To turn Wi-Fi on and connect to a Wi-Fi network:

- 1 On the home screen, touch **Applications** tab  and select **Settings > Wireless & networks > Wi-Fi settings**.
- 2 Touch **Wi-Fi** to turn it on and begin scanning for available Wi-Fi networks.
  - List of available Wi-Fi networks is displayed. Secured networks are indicated by a lock icon.
- 3 Touch a network to connect to it.
  - If the network is open, you are prompted to confirm that you want to connect to that network by touching **Connect**.
  - If the network is secured, you are prompted to enter a password or other credentials. (Ask your network administrator for details.)

- 4 The status bar displays icons that indicate Wi-Fi status.

## 7. Opening and switching applications

Multi-tasking is easy with Android because open applications keep running even when you open another application. There's no need to quit an application before opening another. Use and switch among several open applications. Android manages each application, stopping and starting them as needed, to ensure that idle applications don't consume resources unnecessarily.

### To stop the application you use:

- 1 On the home screen, touch **Applications** tab  and select **Settings> Applications> Manage applications**.

- 2 Scroll to the desired application and touch **Force stop** to stop using it.

**TIP!**

**Getting back to a recent application**

Touch and hold the **Home** key. A screen will appear listing the applications you have recently used.

## 8. Installing the LG PC suite on your PC

To synchronise your phone with your PC via a USB cable, you need to install the LG PC suite program on your PC.

You can download this program from the LG website. Go to <http://www.lg.com> and select your region, country & language. Visit the LG website for more information on installing and using the program.

### LG PC SUITE

The LG PC Suite IV is a program that helps you connect your mobile phone to a PC using a USB data communication cable, so that you can use the functions of your mobile phone on your PC.

#### Major functions of the LG PC Suite IV

- Create, edit and delete phone data conveniently
- Synchronise data from a PC or phone (contacts, calendar, message (SMS), bookmark)
- Transfer multimedia files (photo, video, music) conveniently with a simple drag & drop between your PC and your phone
- Transfer messages from your phone to your PC

## Important notice

- S/W update without losing your data

### **LG-P990 does not support:**

- PC Connection via Bluetooth
- To-do in Calendar
- Java Application

For more information, please refer to the user's guide for LG PC Suite IV. This can be found in the Help menu after installing LG PC Suite IV.

### **To Install the LG PC Suite to your PC**

- 1 Before connecting the USB data cable, make sure that the **Mass storage only** mode is enabled on your phone. (On the **Applications** tab, choose **Settings > SD card & phone storage**, then select the **Mass storage only** tick box.)
- 2 Connect your phone to your PC using the USB data cable.

- (1) In the status bar, drag the USB icon.
- (2) Choose **USB Connected** and **Turn on USB storage**.
- (3) You can view the mass storage content on your PC and transfer the files.
- (4) Copy the 'LGPCSuiteIV' folder on your mass storage device to your PC.
- (5) Run 'LGInstaller.exe' file on your PC and follow the instructions.

\* When LG PCSuite IV installation is completed, disable **Mass storage only** mode to run LG PCSuite IV.

**NOTE:** Please do not remove or delete other program file installed on your memory card as this may cause damage to the pre-installed applications on your phone.

## 9. Connecting your phone to a computer via USB

To transfer files in your microSD card using USB devices:

- 1 Install your microSD card on your phone. (It may already be inserted on your phone.)
- 2 Before connecting the USB data cable, make sure that the **Mass storage only** mode is enabled on your phone. (On the **Applications** tab, choose **Settings > SD card & phone storage**, then select the **Mass storage only** tick box.)
- 3 Use the USB cable with your phone to connect the phone to a USB port on your computer. You will receive notification that the USB is connected.
- 4 Open the notification drawer and touch **USB connected**.
- 5 Touch **Turn on USB storage**

to confirm that you want to transfer files between your phone's microSD card and the computer.

When the phone is connected as USB storage, you will receive a notification. Your phone's microSD card is mounted as a drive on your computer. You can now copy files to and from the microSD card.

**NOTE:** When uninstalling PC Suite IV, USB and Bluetooth Drivers are not automatically removed. Therefore, they must be uninstalled manually.

**TIP!** To use the microSD card on your phone again, you need to open the notification drawer and touch **Turn off USB storage**.

During this time, you can't access the microSD card from your phone, so you can't use applications that rely on the microSD card, such as camera, gallery and music functions.

## Important notice

To disconnect your phone from the computer, carefully follow your computer's instructions for correctly disconnecting USB devices, to avoid losing information on the card.

- 1 Open the notification drawer and touch **Turn off USB storage**.
- 2 Safely disconnect the USB device on your computer.

### 10. Unlock screen when using data connection

Your display will go dark if untouched for a period of time when using data connection. To turn on your LCD screen, just press the power key.

### 11. Do not connect your phone when you power on/off your PC

Make sure you disconnect your phone and PC via data cable as it might cause errors on your PC.

### 12. Hold your phone upright

Please hold your phone straight and upright, as with a normal phone. The LG-P990 has an internal antenna. Be careful not to scratch or damage the back of the phone, as this will cause loss of performance. While making/receiving calls or sending/receiving data, try to avoid holding the lower part of the phone where the antenna is located. This may affect call quality.

### **13. If the screen freezes**

If the phone does not respond to user input or the screen freezes:

Remove the battery, insert it again and switch on the phone. If it still does not work, please contact the service centre.

## Getting to know your phone

To turn off the phone, press and hold the **Power key** for three seconds, touch Power off and press Ok

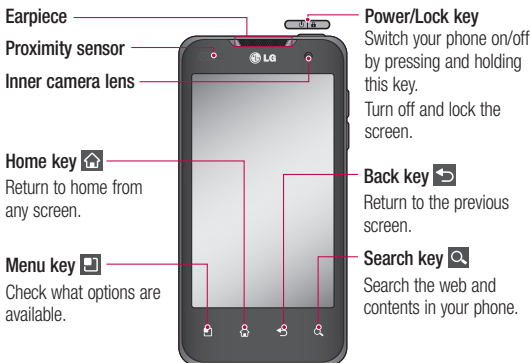

### **NOTE: Proximity sensor**

When receiving and making calls, the proximity sensor automatically turns the backlight off and locks the touch keypad by sensing when the phone is near your ear. This extends battery life and prevents the touch keypad from activating unintentionally during calls.

### **WARNING**

Placing a heavy object on the phone or sitting on it can damage its LCD and touch screen functions. Do not cover the protective film on the LCD's proximity sensor. This may cause the sensor to malfunction.



**Stereo earphone connector**



**HDMI cable connector**

**Power/Lock key**

**Microphone Speaker**



**Charger, micro USB cable connector**



**Volume keys**

On the home screen:  
control ringer volume.

- During a call: control your In-Call volume.
- When playing a track: control volume continuously.

**Camera lens**

**Flash**

**microSD  
memory card  
slot**

**SIM card slot**

**Internal antenna**



**Back cover**

**Battery**

## Getting to know your phone

### Installing the SIM card and battery

Before you can start exploring your new phone, you'll need to set it up. To insert the SIM card and battery:

- 1 To remove the back cover, hold the phone firmly in your hand. With your other hand, firmly press your thumb on the back cover. Lift off the battery cover with your forefinger.

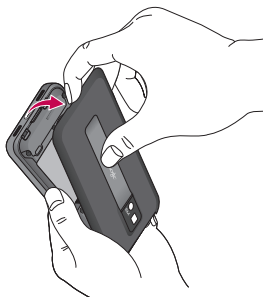
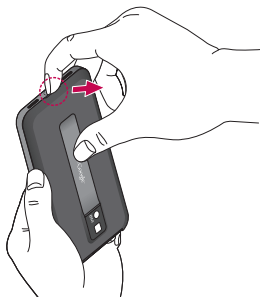

- 2 Slide the SIM card into the SIM card holder. Make sure the gold contact area on the card is facing downwards.

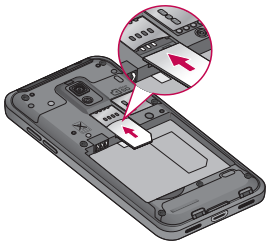

- 3 Insert the battery into place by aligning the gold contacts on the phone and the battery.

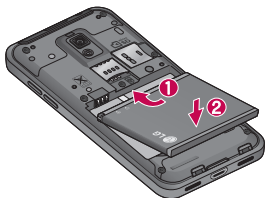

- 4 Replace the back cover of the phone.

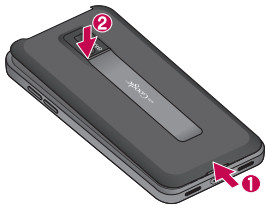

## Charging your phone

Insert the charger and plug it into an electrical socket. Your LG-P990 must be charged until you can see .



**NOTE:** The battery must be fully charged initially to extend battery lifetime.

### Notice!

Use only LG-approved battery, charger (1A) and data cable (1A) specific to your phone model since they are designed to maximise battery life. Using other chargers and data cables will not guarantee full battery charge and normal charging time.

## Getting to know your phone

### Installing the memory card

**NOTE:** The LG-P990 supports up to a 32 GB memory card.

#### To insert a memory card:

Slide the memory card into the slot until it clicks into place. Make sure the gold contact area on the card is facing downwards.

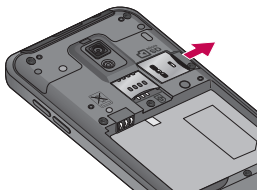
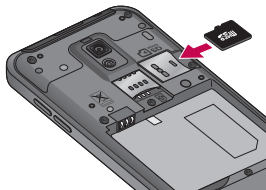

#### **WARNING**

Do not insert or remove the memory card when the phone is on. Otherwise, it may damage the memory card as well as your phone and the data stored on the memory card may be corrupted.

#### Removing a memory card

Carefully remove the memory card by gently pushing it into the phone and quickly releasing it.

## Formatting the memory card

Your memory card may already be formatted. If it isn't, you must format it before you can use it.

**NOTE:** All files on your memory card are deleted when you format it.

- 1 On the home screen, touch the **Applications** tab  to open the applications menu.
- 2 Scroll and touch **Settings**.
- 3 Scroll and touch **SD card & phone storage**.
- 4 Touch **Unmount External SD card**.
- 5 Touch **Erase SD card**, then confirm your choice.
- 6 If you set the pattern lock, input the pattern lock and select **Erase Everything**. The card will then be formatted and ready to use.

**NOTE:** If there is content on your memory card, the folder structure may be different after formatting, as all the files will have been deleted.

### TIP!

If your memory card is already unmounted, you can use the following steps to format it. Touch **Applications > Settings > SD card & phone storage > >Erase SD card**.

### WARNING

To remove the memory card safely, please select **Applications > Settings > SD card & phone storage > Unmount SD card**.

## Your Home screen

### Touch-screen tips

Here are some tips on how to navigate around your phone.

**Touch** - To choose a menu/option or open an application, touch it.

**Touch and hold** - To open an options menu or grab an object you want to move, touch and hold it.

**Drag** - To scroll through a list or move slowly, drag across the touch screen.

**Flick** - To scroll through a list or move quickly, flick across the touch screen (drag quickly and release).

### NOTE:

- To select an item, touch the centre of the icon.
- Do not press too hard; the touch screen is sensitive enough to pick up a light, firm touch.

- Use the tip of your finger to touch the option you want. Be careful not to touch any other keys.

### Lock your phone

When you are not using LG-P990, press the **Power** key to lock your phone. This helps to prevent accidental touching of the keys and saves battery power.

If you do not use the phone for a while the home screen or other screen you are viewing is replaced by the lock screen to conserve the battery.

**NOTE:** If there are any programs running when you set the pattern, they may be still running in lock mode. It is recommended that you exit all programs before entering lock mode to avoid unnecessary charges. (e.g. phone call, web access and data communications)

## Unlock screen

To wake up your phone, press the **Power** key. The lock screen will appear. Touch and slide up the lock screen to unlock your home screen. The last screen you were working on will open.

## Home

Simply swipe your finger to the left or right to view them.

You can also customise each panel with widgets, LG widgets, shortcuts to your favourite applications, folders and wallpapers.

**NOTE:** Some screen images may be different depending on your phone provider.

In your home screen, you can view quick keys on the bottom of the screen. The quick keys provide easy, one-touch access to the functions you use the most.

 Touch the **Phone** icon to bring up the touch-dialling pad to make a call.

 Touch the **Contacts** icon to open your contacts.

 Touch the **Messaging** icon to access the messaging menu. Here, you can create a new message.

 Touch the **Applications** tab at the bottom of the screen. You can then view all your installed applications. Just touch to scroll through your applications.

To open the desired application, simply touch the icon in the applications list.

**NOTE:** Preloaded applications may be different depending on your phone's software or your service provider.

## Setting the number of home screens

Touch the **Menu** key from the

## Your Home screen

home screen and select **Home settings**. Select the desired number of home screens and press **OK**.

### Adding widgets to your home screen

You can customise your home screen by adding shortcuts, widgets, or folders to it. For more convenience when using your phone, add your favourite widgets to the home screen.

#### To add a desired icon to your home screen:

- 1 On the home screen, touch the **Menu** key and select **Add**. Or long touch the empty part of the home screen.
- 2 On the **Add to Home screen** menu, touch the type of item you want to add.
- 3 For example, select **Folders** from the list and tap it. Select **Contacts with phone**

**numbers** from the list and tap it.

- 4 You will see a new folder's icon on the home screen. Drag it to the desired location on the desired panel and release your finger from the screen.

**TIP!** To add an application icon to the home screen on the **Applications** menu, touch and hold the application you want to add.

#### To remove an application icon from the home screen:

- 1 Touch and hold the icon you want to remove.
- 2 Drag and drop an application icon to the bin icon .

**NOTE:** You cannot delete the preloaded applications. (Only their icons can be deleted from the screen.)



## Getting back to a recently used application

- 1 Touch and hold the **Home** key. The screen will show you a pop up with icons of applications that you have used recently.
- 2 Touch an icon to open its application. Or touch the **Back** key to return to the current application.

## Home preview function

You can move to the home preview screen by placing two fingers on the home screen and bringing them closer together. You can move back to the home screen by placing two fingers on home preview screen and spreading them farther apart.

## Capturing the screen

If you touch and hold the **Home** key and press **Power/Lock** key at the same time, the current image

on the screen is captured with a camera shutter sound effect. You can find the captured image in the Gallery. (Note that you cannot capture an image from a video.)

## Notification drawer

The notification drawer runs across the top of your screen.

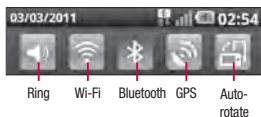

Touch and slide the notification drawer down with your finger.



Here you can check and manage sound, Wi-Fi, Bluetooth, GPS and

## Your Home screen

Auto-rotate status as well as other notifications.

### Viewing the status bar

The status bar uses different icons to display phone information, such as signal strength, new messages, battery life, and active Bluetooth and data connections.













Below is a table explaining the meaning of icons you are likely to see in the status bar.



[Status bar]

Icon	Description
	No SIM card
	No signal
	Airplane mode
	Connected to a Wi-Fi network

Icon	Description
	Wired headset
	Call in progress
	Call hold
	Speakerphone
	Phone microphone is muted
	Missed call
	Bluetooth is on
	Connected to a Bluetooth device
	System warning
	Alarm is set
	New voicemail
	Ringer is silenced
	Vibrate mode

Icon	Description
	Battery fully charged
	Battery is charging
	Data in and out
	Phone is connected to PC via USB cable
	Downloading data
	Uploading data
	GPS is acquiring
	Receiving location data from GPS
	On-Screen Phone connected
	3 more notifications not displayed
	Data is syncing
	Download finished

Icon	Description
	New Gmail
	New Google Talk message
	New message
	Song is playing
	Upcoming event
	FM radio turned on in the background
	USB tethering is active
	Portable Wi-Fi hotspot is active
	Both USB tethering and portable hotspot are active



## Your Home screen

### Onscreen keyboard

You can enter text using the onscreen keyboard. The onscreen keyboard appears automatically on the screen when you need to enter text. To manually display the keyboard, simply touch a text field where you want to enter text.

### Using the keypad & entering text

 Tap once to capitalise the next letter you type. Double-tap for all caps.

  Tap to switch to the numeric and symbol keyboard. You can also touch and hold this tab to view the settings menu.

 Tap to view or long press to change the writing language.

 Tap to insert the emoticon you prefer while writing a message.

 Tap to enter a space.

 Tap to create a new line in the message field.

 Tap to delete the previous character.

 Tap to hide the onscreen keyboard.

## Google Account Set-up

The first time you open the Google application on your phone, you will be required to sign in with your existing Google account. If you do not have a Google account, you will be prompted to create one.

### Creating your Google account

- 1 On the home screen, touch **Applications** tab  to open the applications menu.
- 2 Tap **Gmail** and tap **Next >** **Create** to start the Gmail set up wizard.
- 3 Touch a text field to open the touch keyboard, and enter your name and username for your Google account. When entering text, you can move to the next text field by touching **Next** on the keyboard.
- 4 When you have finished inputting your name and

username, tap **Next**. Your phone is communicating with Google servers and checking username availability.

- 5 Enter and re-enter your password. Then follow the instructions and enter the required and optional information about the account. Wait while the server creates your account.

### Signing in to your Google account

- 1 Enter your e-mail address and password, then tap **Sign in**. Wait for signing in.
- 2 After sign in, you can use Gmail and take advantages of Google services on your phone.
- 3 Once you have set up your Google account on your phone, it will be automatically synchronised with your Google account on the

## Google Account Set-up

web. (depending on your synchronisation settings).

After sign in, you can use Gmail, Google Calendar, and Android Market; download applications from Android Market; and take advantage of other Google services on your phone.

### **IMPORTANT!**





- Some applications, such as Calendar, only work with the first Google account you add. If you plan to use more than one Google account with your phone, be sure to sign into the one you want to use with these applications first. Once you login to Google account, no option to sign out, but user can add different accounts. User has option to remove the account. When you sign in, your contacts, Gmail

messages, calendar events and other information from these applications and services on the web are synchronised with your phone. The first time you open the Google application on your phone, you will be required to sign in with your existing Google account. If you do not have a Google account, you will be prompted to create one.

- If you have an enterprise account through your company or other organisation, your IT department may have special instructions on how to sign into that account.

## Calls/Contacts



### Making a voice call

- 1 Touch  to open the keypad.
- 2 Enter the number on the keypad. To delete a digit, touch **Clear** icon .
- 3 Touch **Call** icon  to make a call.
- 4 To end a call, touch **End** icon .

**TIP!** To enter “+” to make international calls, touch and hold down .

**TIP!** To bring up the keypad during a call, touch **Dialpad**.

### Making a video call

- 1 Touch  to open the keypad.
- 2 Enter the phone number, as before.
- 3 Touch **Video call** icon  to make a video call.

- 4 If you do not want to use the speaker phone, touch **Speaker** icon and ensure you have the headset plugged in.
- 5 While the video call is connecting, you will see your own image; after the other party has answered, their image will be displayed on the screen. Adjust the inner camera position if necessary.
- 6 To end a video call, touch **End** icon.

#### NOTE:

- If you set **Use private image** in the **Video call settings**, the person on the video call sees the image you set, not a live image.
- You can show your image through either the front or rear camera.
- The quality of the video call (image and sound) may vary depending on the base station.

## Calls/Contacts

### Calling your contacts

- 1 Touch  to open your contacts.
- 2 Scroll through the contact list or enter the first letter(s) of the contact you want to call by touching **Search**.
- 3 In the list, touch the contact you want to call.

### Answering and rejecting a call

#### When screen locked:

When your phone rings, drag **Accept** icon  to the right for accepting an incoming call.

Drag **Reject** icon  to the left to reject an incoming call.

#### When screen is unlocked:

When your phone rings, touch **Accept** icon  to Accept an incoming call. Touch **Reject** icon  to reject an incoming call.

#### **TIP!** Excuse messages

When you want to reject a call, you can send a message quickly by touching **Send SMS**. This is useful if you need to reply the message during a meeting.

### Adjusting call volume

To adjust the in-call volume during a call, use volume up & down key on the right side of the phone.

### Viewing your call logs

On the home screen, touch  and choose **Call log** tab.

View a complete list of all dialed, received and missed calls.

**TIP!** Touch any single call log entry to view the date, time, and duration of the call.



**TIP!** Touch the **Menu** key, then touch **Delete all** to delete all the recorded items.

## Call settings



You can configure phone call settings, such as call forwarding, and other special features offered by your carrier.

- 1 On the home screen, touch the **Applications** tab to open the applications menu.
- 2 Scroll and touch **Settings**.
- 3 Tap **Call settings** and choose options that you want to adjust.

## Searching for a contact

- 1 On the home screen, touch  to open your contacts.
- 2 Touch **Search** and enter the contact name using the keypad.

## Adding a new contact

- 1 On the home screen, touch  and enter the new contact's number. Then touch the **Menu** key and touch **Add to contacts** and then touch **Create new contact**.
- 2 If you want to add a picture to the new contact, touch . Choose from **Take a picture** or **Pick from gallery**.
- 3 Select the contact type by touching .
- 4 Touch a text field to open the touch keyboard and enter a new contact's name.
- 5 Touch different category of contact information and enter the details about your contact.
- 6 Touch **Save** to save the contact.

## Calls/Contacts

### Favourite contacts

You can classify frequently called contacts as favourites.

#### To add a contact to your favourites:

- 1 On the home screen, touch  to open your contacts.
- 2 Touch a contact to view their details.
- 3 Touch the star to the right of the contact's name. The star turns gold.
- 4 The favorite contacts will be saved under groups as Favorites

## Messaging/E-mail

### Messaging

Your LG-P990 combines SMS and MMS into one intuitive, easy-to-use menu.

### Sending a message

- 1 Touch  icon on the home screen, and touch **New message** to open a blank message.
- 2 Enter a contact name or call number in the **To** field. As you enter the contact name, matching contacts appear. You can add a suggested recipient. You can add multiple contacts.
- 3 Touch **Enter message** below to start entering your message.
- 4 Touch **Send** to send your message.

**TIP!** You can touch  icon to attach the file you want to share with your message.

- 5 Responses appear on the screen. As you view and send additional messages, a message thread is created.



#### **WARNING**

The 160-character limit may vary from country to country depending on how the SMS is coded and the language.



#### **WARNING**

If an image, video or audio file is added to an SMS message, it will be automatically converted into an MMS message and you will be charged accordingly.

## Messaging/E-mail

### Changing your message settings

Your LG-P990 message settings are predefined, so you can send messages immediately. You can change the settings based on your preferences.

Touch **Messaging** icon on the home screen, and touch the **Menu** key, then tap **Settings**.

### Opening your email and email accounts screen

You can use the **Email** application to read email from services like Gmail. The **Email** application supports the following account types: POP3, IMAP and Exchange.

- 1 On the home screen, touch the **Applications** tab and tap **Email** to view the account list.
- 2 The first time you open the **Email** application, a setup wizard opens to help you add an email account.

- 3 After initial setup, **Email** displays your **Inbox** (if you have only one account) or the **Accounts** screen (if you have multiple accounts). Select inbox or one of your accounts then content will be displayed.

#### TIP!

- If you long-press an account from the list of email accounts, you can select the desired option in the pop-up window. For example, select **Add to home screen** to create a shortcut icon of the account on the home screen.
- Select the **Email** shortcut icon on the home screen to move to the list of email accounts. Likewise, if you select the shortcut icon of an account on the home screen, you can move to the inbox of the corresponding account.

## Composing and sending email

### To compose and send a message:

- 1 While in the **Email** application, touch the **Menu** key and touch **Compose**.
- 2 Enter an address for the message's intended recipient. As you enter text, matching addresses are offered from your contacts. Separate multiple addresses with commas.
- 3 Touch the **Menu** key and touch **Add CC/BCC** to be able to CC or BCC other contacts/email addresses.
- 4 Enter the text of the message.
- 5 Touch **Attach** to attach the file you want to share with your message.
- 6 Touch **Send**.  
If you're not ready to send the message, touch the **Menu** key and touch **Save as Draft**

to save it in a **Drafts** folder. Touch a draft message in a **Drafts** folder to resume working on it. Your message will also be saved as a draft if you touch the **Back** key  and tap on yes in save as draft pop up before sending it. If you aren't connected to a network, for example, if you're working in airplane mode, the messages that you send are stored in your **Outbox** folder until you're connected to a network again. If it contains any pending messages, the **Outbox** is displayed on the **Email-Accounts** screen.

Please note that messages sent using an Exchange account will not be located on the phone; they will, however, be located on the Exchange server itself. If you want to see your sent messages in the **Sent** folder (or

## Messaging/E-mail

with the Sent label), you will often need to open the Sent folder/label and select Refresh from the options menu.

### TIP!

LG-P990 has inbuilt sensors to move the cursor in any editor by simply hitting slightly on the top/down/right/left sides of the phone for cursor navigations.

## Adding and editing email accounts

**To add an email account:**

- 1 Touch the **Menu** key and touch **New**.
- 2 Select **MS Exchange** or **Others**.
- 3 Enter a name for the account, confirm how you want your name to appear in outgoing mail, then touch **Done**.

**To delete an email account:**

- 1 Open the **Email-Accounts** screen.
- 2 Touch and hold the account you want to delete.
- 3 Touch **Delete** in the menu that opens.
- 4 Touch **OK** in the dialog box to confirm that you want to delete the account.

## Social networking

With your phone, you can enjoy the social networking and manage your micro-blog in on-line communities. You can update your current status upload photos and view your friends' status updates real-time.

If you don't have an account, you can visit the website to set one up.

**NOTE:** An additional costs may be incurred when connecting and using online services. Check data charges with your network provider.

### Adding your account to your phone

- 1 On the home screen, touch the **Applications** tab to open the applications menu.
- 2 Choose any social networking site application you want to use.

- 3 Enter your e-mail address and the password that you set up on your community, then tap **Log in**.

- 4 Wait while your details are checked with your community.

- 5 If you tap your community, you can see the current status of your social community.

**TIP!** If you add a social networking widget on your home screen, the widget will show your status when your phone updates from the network. You can also access the social community directly by touching the widget.

# Camera

## Getting to know the viewfinder

**Zoom** - Zoom in or zoom out. Alternatively you can use the side volume keys.

**Convert** - You can convert to the internal camera from the external one.



**Video mode** - Slide down this icon to switch to video mode.

**Taking a photo**

**Gallery** - Touch to view the last photo you captured. This enables you to access your gallery and view saved photos from within camera mode.

**Settings** - Touch this icon to open the settings menu. See Using the advanced settings.

**Flash** - Allows you to turn on the flash when taking a photo in a dark place.

**Brightness** - This defines and controls of the amount of sunlight entering the image. Slide the brightness indicator along the bar, towards “-” to lower the brightness of the image or towards “+” to increase it.

**TIP!** You can close all the shortcut options to give a clearer viewfinder screen. Just touch the centre of the viewfinder once. To recall the options, touch the screen again.

**NOTE:** In internal camera mode, you cannot enable the zoom or flash function.



## Taking a quick photo

- 1 Open the **Camera** application.
- 2 Holding the phone horizontally, point the lens towards the subject you want to photograph.
- 3 Touch the shutter icon .
- 4 The camera brings the image into focus. When the image is in focus, the focus indicators in each corner turn green and the camera takes a picture.

**NOTE:** A shading issue may occur when you try to take a picture indoors due to the characteristics of camera. (The meaning of shading is a little colour-difference between centre and side.)

## Once you've taken the photo

Your captured photo will appear on the screen.

### Share

Touch to share your photo via **Bluetooth**, **Email**, **Facebook** for **LG**, **Gmail**, **Messaging**, **MySpace** for **LG**, **Picasa** or **Twitter** for **LG**.

**NOTE:** Additional charges may apply when MMS messages are uploaded and/or downloaded while roaming.

**TIP!** If you have a social networking site account and set it up on your phone, you can share your photos to your community.

### Set as

Touch to set the image as **Contact icon** or **Wallpaper**.

### Rename

Touch to edit the name of the captured picture.



Touch to delete the image.

## Camera

 Touch to take another photo immediately. Your current photo will be saved.

 Touch to view last photo you captured.

### Using the advanced settings

In the viewfinder, touch  to open all advanced options.

You can change the camera settings by scrolling the list. After selecting the option, touch the **Back** key.

**Image size** – Touch to set the size (in pixels) of the picture you are taking. Select a pixel value from the options: 8M (3264X2448), 5M (2560X1920), 3M (2048x1536), 2M (1600x1200), 1M (1280x960), VGA (640x480), QVGA (320x240).

**NOTE:** Options for **Image size** may vary depending on the camera mode.

**Focus** – Touch this icon to select the options menu. See Using the focus mode.

**Scene mode** – Choose from **Auto**, **Portrait**, **Landscape**, **Sports**, **Sunset** and **Night**.

**ISO** – The ISO rating determines the sensitivity of the camera's light sensor. The higher the ISO, the more sensitive the camera will be. This is useful under darker conditions when you cannot use the flash. Select from ISO values of **Auto**, **800**, **400**, **200** and **100**.

**White balance** – Choose from **Auto**, **Incandescent**, **Sunny**, **Fluorescent**, and **Cloudy**.

**Color effect** – Choose a colour tone for your new photo.

#### **NOTE:**

- Options for **Color effect** may vary depending on the camera mode.

- **Solarize** for **Color effect** is only supported in internal camera mode.
- **Blue, Emboss, Posterize,** and **Vivid** for **Color effect** are supported only in external camera mode.

**Timer** – The self-timer allows you to set a delay after the shutter is pressed. Select off, 3 seconds, 5 seconds, or 10 seconds. This is ideal if you want to be included in a photo.

**Shot mode** – Select various shooting mode from the options. Choose from **Normal, Continuous shot, Out-focusing shot, Smile shot, Beauty shot, Art shot, Panorama shot** and **Stitch shot**.

**Image quality** – Choose from **Super fine, Fine,** and **Normal**. The finer the quality, the sharper the photo. However, the file size will increase as a result, which means you'll be able to store fewer photos in the memory.

**Stabilization** – Select **On** to compensate for unsteady hands.

**Auto review** – If you set **Auto review** to **On**, it will show you the picture you have just taken automatically.



**Shutter sound** – Select one of the four shutter sounds.

**Tag location** – Activate to use your phone's location-based services. Take pictures wherever you are and tag them with the location. If you upload tagged pictures to a blog that supports geotagging, you can see the pictures displayed on a map.

**NOTE:** This function is available when GPS & GPRS are activated or WPS is connected.

**Storage** – Choose whether to save your photos to the phone memory or to the external memory.

## Camera

-  Restore all camera default settings.
-  Touch whenever you want to know how this function operates. This will provide you a quick guide.

### Using the focus mode

You can select the focus mode from the following options;

**Auto** – Set the camera to focus automatically.

**Macro** – Macro mode allows you to take extreme close-ups. If you are trying to take a close-up shot but the focus box remains red, try turning the macro mode on.

**Face tracking** – If you set Face tracking and take a photo, your camera detects and focuses on human faces automatically.

**Manual** – Set the camera to focus manually.

## Video camera





### Getting to know the viewfinder

- Zoom** - Zoom in or zoom out. Alternatively you can use the side volume keys.
- Convert** - You can convert to the internal camera from the external one.
- Camera mode** - Slide up this icon to switch to camera mode.
- Start recording**
- Gallery** - Touch to view the last video you recorded. This enables you to access your gallery and view your saved videos from within video mode.
- Settings** - Touch this icon to open the settings menu. See Using the advanced settings.
- Flash** - Allows you to turn on the flash when capturing a video in dark place.
- Brightness** - This defines and controls of the amount of sunlight entering the video. Slide the brightness indicator along the bar, towards “-” to lower the brightness of the video or towards “+” to increase it.



## Video camera

### Shooting a quick video

- 1 Open the **Camera** application and slide the camera mode button down to the **Video** position. The shutter icon  will change to .
- 2 The video camera viewfinder will appear on the screen.
- 3 Holding the phone horizontally, point the lens towards the subject of the video.
- 4 Touch the start video icon .
- 5 REC will appear at the bottom of the viewfinder with a timer showing the length of the video.
- 6 Touch the stop video icon  to stop recording.

### After shooting a video

A still image representing your video will appear on the screen.

**Play** Touch to play the video.

**Share** Touch to share your video via **Bluetooth**,

**Email**, **Gmail**,  
**Messaging** or **YouTube**.

**NOTE:** Additional charges may apply when MMS messages are uploaded and/or downloaded while roaming.

**Rename** Touch to edit the name of the selected video.

 Touch to delete the video you just made, and confirm by touching **OK**. The viewfinder will reappear.

 Touch to shoot another video straight away. Your current video will be saved.

 Touch to view the last video you recorded.

### Using the advanced settings

Using the viewfinder, touch  to open all the advanced options.

Adjust the video camera settings by scrolling the list. After selecting

the option, touch the **Back** key.

**Video size** – Touch to set the size (in pixels) of the video you record. Choose your video image size from Full HD (1920x1088), HD (1280x720), TV (720x480), VGA (640x480), QVGA (320x240) and QCIF (176x144).

**White balance** – The white balance ensures that white areas in your video are realistic. To enable your camera to adjust the white balance correctly, you may need to determine the light conditions. Choose from **Auto**, **Incandescent**, **Sunny**, **Fluorescent**, and **Cloudy**.

**Color effect** – Choose a colour tone to use for your new video.

**NOTE:** Options for Color effect may vary depending on the video mode.

**Video quality** – Choose from **Super fine**, **Fine** and **Normal**.

**Duration** – Set a duration limit for your video. Choose between **Normal** and **MMS** to limit the maximum size to send as an MMS message.

**Voice** – Choose **Mute** to record a video without sound.

**Auto review** – If you set to **On**, it will automatically show you the video you have just recorded.

**Storage** – Choose whether to save your video clip to the phone memory or to the external memory.



Reset all the video camera settings.



Touch whenever you want to know how this function operates. This will provide you a quick guide.

## Video camera

### Watching your saved videos

- 1 In the viewfinder, touch .
- 2 Your gallery will appear on the screen.
- 3 Touch a video once to bring it to the front of the gallery. It will start to play automatically.

### Adjusting the volume when viewing a video

To adjust the volume of a video while it is playing, use the volume keys on the right side of the phone.



## Multimedia

### Gallery

You can store any multimedia files on your phone's memory that will be displayed in your **Gallery** so that you have easy access to all of your pictures and videos. You can also save your files to your external memory card. The advantage of using a memory card is that you can free up space on your phone memory.

Touch **Applications** tab, then select **Gallery**.

### To change how the contents of an album are displayed

You can view the images and videos in your albums in a chronological grid or in stacks, sorted by the date and the location where they were taken. Use the Album View switch  at the top right of the screen to switch

between grid and stack view.



Drag the Album View switch to the left to view the album contents in a chronological grid.



Drag the Album View switch to the right to view the contents of the album in stacks.

### Using SmartShare

SmartShare provides you a better way to enjoy multimedia contents with other DLNA(Digital Living Network Alliance) enabled devices.

#### \* Share your media contents to other DLNA devices (DMS)

- 1 Touch **Application** tab and select **SmartShare**.
- 2 Press the **Menu** key and select **Settings**.
- 3 Touch Discoverable checkbox to turn on.
- 4 Touch **Always accept**

## Multimedia

**request** if you would like to automatically accept sharing requests from other devices.

- 5 Under the Sharing contents section, touch to checkmark the types of content you would like to share. Choose from **Pictures**, **Videos** and **Music**.

- 6 **SmartShare** is now activated and ready to share contents.

**\* Let your renderer device (e.g. TV) play multimedia contents from remote content library (e.g. PC)**

- 1 Touch the top right button to select the device from renderer lists.
- 2 Touch the top left button and select one of the remote content library.
- 3 You can browse the remote content library.
- 4 Long touch a content thumbnail and flick them to the top area

by your finger or touch play button.

**Notice:** Check that your device is connected with your home network using Wi-Fi connection to use this application. The devices should be connected to the same Wi-Fi network i.e. Wi-Fi Mac address of both the devices should be the same.



**Notice:** Some DLNA enabled device (e.g. TV) supports only DMP feature of DLNA will not appear in the renderer device lists.

### Music

Your LG-P990 has a built-in music player that lets you play all your favourite tracks. To access the music player, touch **Music**.

### Playing a song

- 1 On the home screen, touch the **Applications** tab and select **Music**.

- 2 Touch **Songs**.
- 3 Select the song you want to play.
- 4 Touch  to pause the song.
- 5 Touch  to skip to the next song.
- 6 Touch  to go back to the first part of the song. Touch  twice to go back to the previous song.

To change the volume while listening to music, touch the up and down volume keys on the right side of the phone.

Touch and hold any song in the list. It will display **Play, Add to playlist, Use as phone ringtone, Delete, Share, Search** and **File info** as options.

**NOTE:** Music file copyrights may be protected by international contracts and national copyright laws.

Therefore, it may be necessary to obtain permission or a licence to reproduce or copy music. In some countries, national laws prohibit private copying of copyrighted material. Before downloading or copying the file, please check the national laws of the relevant country concerning the use of such material.

## Using the radio

Your LG-P990 has a built-in FM radio so you can tune in to your favourite stations and listen it.

**NOTE:** You must attach your headphone to listen to the radio. Insert it into the headphone jack.

## Multimedia

### Searching for stations

You can tune in to radio stations by searching for them manually or automatically. They will then be saved to specific channel numbers, so you don't have to keep re-tuning in.

- 1 On the home screen, touch the **Applications** tab and select **FM Radio**.
- 2 Touch the **Scan FM radio stations**.
- 3 If there are pre-set channels, you will see a pop-up with 'All channels will be reset. Continue?'. If you choose **OK**, all the pre-set channels will be deleted and auto scan will start.
- 4 During auto scanning, touch **Stop scanning** if you want to stop scanning. Only channels scanned before you stop will be saved.

**NOTE:** You can also manually tune in to a station using the displayed wheel.

### Listening to the radio

- 1 On the home screen, touch the **Applications** tab and select **FM Radio**.
- 2 Touch the channel list of the station you want to listen to.
- 3 Touch  icon. You can listen to the radio via built-in speaker.

### Transferring files using USB mass storage devices

**To transfer files using USB devices:**

- 1 Connect the LG-P990 to a PC using a USB cable.
- 2 If you have not installed LG Android Platform Driver on your PC, you will need to change settings manually. Choose

**Settings > SD card & phone storage > activate Mass storage only.**

- 3** Touch **Turn on USB storage.**
- 4** You can view the mass storage contents on your PC and transfer the files.

**NOTE:**

- If you installed LG Android Platform Driver, you will see pop up with '**Turn on USB storage**' immediately.
- After using USB mass storage function, if you want to synchronise your phone with your PC using the LG PC suite, you need to touch **Settings > SD card & phone storage**, then touch the tick to turn off **Mass storage only** mode.

## **How to save music/video files to your phone**

- 1** Connect your phone to the PC using the USB cable.
  - Touch and drag down the status bar on the home screen. Select **USB connected > Turn on USB storage > now Open folder** to view files in PC.
- If you have not installed LG Android Platform Driver on your PC, you will need to set it manually. For more information, refer to 'Transferring files using USB mass storage devices'.
- 2** Save music or video files from your PC to the phone's removable storage.
  - You may copy or move files from your PC to the phone's removable storage using a card reader. Using Data cable (USB Mass storage ) also you can copy

## Multimedia

- If there is a video file with a subtitle file (.smi or .srt file with the same name as the video file), place them in the same folder to display the subtitle automatically when playing the video file.

**Caution!** When downloading music or video files, copyright must be secured. Please note that a corrupted file or file with a wrong extension may cause damage to your phone.

### How to move contacts from your old phone to your current phone

**Export your contacts as a CSV file from your old phone to your PC using a PC sync program.**

- 1 Run the program and connect your Android mobile phone to the PC using a USB cable. Select the Contacts icon. Go

to Menu > File > Import and select the CSV file saved in the PC. If the fields in the imported CSV file are different from the ones in PC Sync for Android, you need to map the fields.

- 2 After mapping the fields, click OK. Then, the contacts are added in PC Sync for Android, click "Sync" or "Sync contacts" to synchronise the contacts saved in the PC to your phone and save them.

### How to send data from your phone via Bluetooth

You can send data via Bluetooth by running a corresponding application, rather than from the Bluetooth menu as with normal mobile phones.

- **Sending pictures:** Run the **Gallery** application and select **Picture > Menu**. Click **Share**

and select **Bluetooth** > Check **If Bluetooth is turned on** and select **Scan for devices** > Choose the device you want to send data from the list.

- **Exporting contacts:** Run the **Contacts** application. Touch the address you want to export to. Touch the **Menu** key and select **Share** > **Bluetooth** > Check **If Bluetooth is turned on** and select **Scan for devices** > Choose the device you want to send data from the list.
- **Sending multi-selected contacts:** Run the **Contacts** application. To select more than one contact touch the **Menu** key and touch **Share**. Select the contacts you want to send or Select all option from top > Select **Share** > **Bluetooth** > Enable the Bluetooth tick box and select **Scan for devices** >

Choose the device you want to send data from the list.

- **Connecting to FTP (Only the FTP server is supported on this handset):** Go to **Settings** > **Wireless & networks** > **Bluetooth settings**. Then, select the **Discoverable** tick box and search for other devices. Find the service you want and connect to the FTP server.

**TIP!** The version is Bluetooth 2.1 EDR and certified by Bluetooth SIG. It is compatible with other Bluetooth SIG certified devices.

**NOTE:** If you want to search for this phone from other devices, go to **Settings** > **Wireless & networks** > **Bluetooth settings**. Then, select the **Discoverable** tick box. The tick box is cleared after 120 seconds.

**NOTE:** Supported profiles are SDAP, HFP, HSP, OPP, PBAP

## Multimedia

(server), FTP (server), A2DP, and AVRCP.

**NOTE:** Your device can act only as server and you can't make FTP connection from your device to other device.



## Google applications

**NOTE:** The first time you open the Google application on your phone, you will be required to sign in with your existing Google account.

### Maps

Check your current location and traffic and receive directions to your destination. Your phone must be connected to Wi-Fi or 3G/GPRS.

**NOTE:** Google Maps does not cover all cities and countries.

With the **Menu** key, you can select options such as **Search, Directions, Starred Places, Clear Map, Latitude** and so on.

### Market

Android Market lets you download useful applications and games. If you install applications and games from Android Market, they appear

in the LG-P990 menu. You can check downloaded applications on **Downloads** tab.

### Gmail

Gmail is configured when you first set up your phone. Depending on your synchronisation settings, Gmail is automatically synchronised on your phone with your Google account on the web. The inbox conversations list is your default Gmail view.

### Talk

Google Talk is Google's instant messaging program. It lets you communicate with other people who also use Google Talk.

Touch the **Menu** key and check available options as below: **All friends, Add friend, Search, Sign out, Settings** and so on.

## Google applications

### Google Search

Touch the **Menu** key, then touch Search and again touch the menu key and touch search settings to configure Google search, including setting which data on your phone you want to be able to search.

### YouTube

YouTube is a free website where you can watch or upload videos.

**NOTE:** You can access YouTube with your Google account but you need a YouTube account for some services such as video uploading.

## Utilities

### Setting your alarm

- 1 On the home screen, touch the **Applications** tab and select **Alarm/Clock**.
- 2 If you want to add a new alarm, touch **Add alarm**.
- 3 Set the time and repeat, snooze, alarm tone. You can also touch  to set vibration, weather info, and add a memo to name the alarm.
- 4 Touch **Save** to turn on the alarm.

**NOTE:** To change alarm settings on alarm list screen, touch the Menu key and select Settings. You can adjust the below options: **Alarm in silent mode, Side button behavior, Alarm volume, Set default ringtone** and **Weather info settings**.

### Using your calculator

- 1 On the home screen, touch the **Applications** tab and select **Calculator**.
- 2 Touch the number keys to enter numbers.
- 3 For simple calculations, touch the function you want (+, -, x, or ÷), followed by =.
- 4 For more complex calculations, touch **Menu**, then touch advanced panel and choose sin, cos, tan, log, and so on.

### Adding an event to your calendar

- 1 On the home screen, touch the **Applications** tab and select **Calendar**.
- 2 To check the event, touch the date. Touch and hold if you want to add a new event. then touch **New event**.

## Utilities

- 3 Touch **What**, then enter the event name. Check the date and enter the time you want your event to begin and finish.
  - 4 Also, touch **Where**, then enter the location.
  - 5 If you would like to add a note to your event, touch **Description** and enter the details.
  - 6 If you want to repeat the Event, set **Repetition**, and set **Reminders**, if necessary.
  - 7 Touch **Done** to save the event in the calendar.
- 1 On the idle screen, touch the Home key.
  - 2 Touch Calendar, then sign in to your account.
  - 3 In the Calendar menu, Select Settings option.
  - 4 Touch Use Home Time Zone and select required time zone in Home Time Zone option.

### Home Time Zone

You can set the option “Use home time zone” & select “Home time zone” from the list.

This is used to override the local time zone set by the mobile network so that time zone of your choice is applicable to Calendar and events of your phone.

### Recording a sound or voice

- 1 On the home screen, touch the **Applications** tab and select **Voice Recorder**.
- 2 Touch  **Record** to begin recording.
- 3 Touch  **Stop** to end recording.
- 4 Touch  **Play** to listen to the recording.

**NOTE:** Touch **List** to access your album. You can listen to the saved recording.

**NOTE:** Once you have finished recording, you can send the audio clip by touching **Share**.

# The Web





## Browser

Browser gives you a fast, full-colour world of games, music, news, sports, entertainment and much more, right on your mobile phone. Wherever you are and whatever you're into.

**NOTE:** Additional charges apply when connecting to these services and downloading content. Check data charges with your network provider.

## Using options

Touch the **Menu** key to view options.

-  **New window:** Open a new window.
-  **Bookmarks:** Add/show bookmark, show most visited site and history.
-  **Windows:** Show all your open windows.
-  **Refresh:** Touch to refresh the web page.

 **Forward:** Go forward to the page you connected to after the current page.

**NOTE:** The **Back** key takes you to the previous page.

## More

- **Add bookmark:** Add the current web page as bookmark.
- **Find on page:** If you enter a letter or any word, it will mark all the letters available in the web page.
- **Select text:** Touch and select the lines you want to copy. Long touch any input box then you can paste it.
- **Page info:** Show the web page information.
- **Share page:** Send the web page.
- **Downloads:** Show downloaded history.
- **Settings:** Change web browser settings.

**NOTE:** To return the previous page, touch the **Back** key.

## Settings

On the home screen, touch the **Applications** tab then scroll and touch **Settings**.

### Wireless & networks

Here you can manage Wi-Fi and Bluetooth. You can also set mobile networks, airplane mode.

**Airplane mode** – After setting Airplane mode, all wireless connections will be disabled.

**Wi-Fi** – Touch to tick: This turns on Wi-Fi to connect to available Wi-Fi networks.

**Wi-Fi settings** – Allows you to set up and manage wireless access points. Set network notification, or add a Wi-Fi network. The advanced Wi-Fi settings screen is accessed from the Wi-Fi settings screen. Touch the **Menu** key and touch **Advanced**.

**Bluetooth** – Touch to tick: This turns on Bluetooth to connect to Bluetooth devices.

**Bluetooth settings** – Set device name & discoverable mode, scan for other devices. Or, check a list of Bluetooth devices that you've previously configured and those detected when the phone last scanned for Bluetooth devices.

**Tethering & portable hotspot** – You can configure the settings of USB tethering and portable Wi-Fi hotspot.

**VPN settings** – Displays the list of Virtual Private Networks (VPNs) that you've previously configured. Allows you to add different types of VPNs.

**Mobile network settings** – Set options for data roaming, network mode & operators, access point names (APNs), and so on.

**On-Screen Phone settings** – Allows you to change the On-Screen Phone password (the default password is "0000").

## Settings

On-Screen Phone allows you to view your mobile phone screen from a PC via a USB or Bluetooth connection. You can also control your mobile phone from your PC using the mouse or keyboard.

### Call settings

You can configure phone call settings, such as call forwarding, and other special features offered by your carrier.

- 1 On the home screen, touch the **Applications** tab to open the applications menu.
- 2 Scroll and touch **Settings**.
- 3 Tap **Call settings** and choose options that you want to adjust.

#### < Fixed Dialling Numbers >

Select **Fixed Dialling Numbers** to turn on and compile a list of numbers that can be called from your phone. You'll need your PIN 2 code, which is available from your

operator. Only numbers within the fixed dial list can be called from your phone.

#### < Voicemail >

**Voicemail service** – Allows you to select your carrier's voicemail service.

**Voicemail settings** – If you are using your carrier's voicemail service, this option allows you to enter the phone number to use for listening to and managing your voicemail.

#### < Other call settings >

**Call forwarding** – Choose whether to divert all calls, when the line is busy, when there is no answer and when you are out of reach.

**Additional settings** – This lets you change the following settings:

- **Caller ID:** Choose whether to display your number on an outgoing call.



- **Call waiting:** If call waiting is activated, the handset will notify you of an incoming call while you are on the phone (depending on your network provider).

- **Select line**

**Call barring** – Select when you would like calls to be barred. Enter the call barring password. Please check with your network operator about this service.

**Call costs** – View the charges applied to your calls. (This service is network dependent; some operators do not support this function.)

**Call duration** – View the duration of all calls including all, dialled calls, received calls and last call.

**Excuse messages** – When you want to reject a call, you can send a message quickly by using this function. This is useful if you need

to reply the message during a meeting.

**Video call settings** – Change your video call settings.

## Sound

### < General >

**Silent mode** – Allows you to silence all sounds (including call and notification ringtones) except the audio from music, videos, and any alarms you have set (You must silence media and alarms in their own applications).

**Vibrate** – Allows you to set your phone to vibrate when you receive an incoming call.

**Volume** – Allows you to set the volume for ringtones, media and alarms. If you uncheck the option to use incoming call volume for notifications, you can set both volumes for incoming call and notification separately.

## Settings

### < Incoming calls >

**Phone ringtone** – Allows you to set your default incoming call ringtone.

### < Notifications >

**Notification ringtone** – Allows you to set your default notification ringtone.

### < Feedback >

**Audible touch tones** – Allows you to set the phone to play tones when using the dial keypad to dial numbers.

**Audible selection** – Allows you to set your phone to play a sound when you touch buttons, icons, and other onscreen items that react to your touch.

**Screen lock sounds** – Allows you to set your phone to play a sound when locking and unlocking the screen.

**Haptic feedback** – Allows you to set your phone to vibrate briefly when you touch the **Menu** key, **Back** key, and perform other actions.

## Display

**Brightness** – Adjust the brightness of the screen.

**Auto-rotate screen** – Allows you to set the orientation to automatically switch to landscape mode or portrait mode when you turn the phone sideways or upright.

**Animation** – Allows you to set animated transitions when navigating from screen to screen.

**Screen timeout** – Allows you to adjust the delay time before the screen automatically turns off. For the best battery performance, use the shortest convenient timeout.

**Display font** - Change the display font.

## Gesture

Adjust the gesture settings for home screen, incoming call, alarm, gallery, music, and video player.

## Location & security

### < My Location >

**Use wireless networks** – If you tick **Use wireless networks**, your phone will determine your approximate location by using Wi-Fi and mobile networks.

**Use GPS satellites** – If you tick **Use GPS satellites**, your phone will determine your location to street-level accuracy.

### < Screen unlock>

**Set up screen lock** – Set unlock pattern to secure your phone. Opens a set of screens that guide you through drawing a screen unlock pattern. You can set **PIN** or **Password** instead of **Pattern** or leave it as **None**.

### < SIM card lock >

**Set up SIM card lock** – Set up SIM card lock or change SIM PIN.

### < Passwords >

**Visible passwords** – Select to show passwords as you type them or deselect to hide passwords as you type them.

### < Device administration >

**Select device administrators** – Add or remove device administrators.

### < Credential storage >

**Use secure credentials** – Tick to allow applications to access your phone's encrypted store of secure certificates, related passwords and other credentials. You use credential storage to establish some kinds of VPN and Wi-Fi connections. If you have not set a password for credential storage, this setting is dimmed.

**Install from SD card** – Allows you to install encrypted certificates from a microSD card.

## Settings

**Set password** – Allows you to set or change the password for your secure credential storage. Your password must have at least eight characters.

**Clear storage** – Deletes all secure certificates and related credentials and erases the secure storage password.

### Applications

**Unknown sources** – Permits installation of applications that you obtain from websites, email or other locations other than Android Market.



#### **WARNING**

To protect your phone and personal data, only download applications from trusted sources, such as Android Market.

**Manage applications** – Manage and remove installed applications.

**Running services** – Allows you to view and control currently running services and applications. This option displays what processes each running service needs and how much memory it is using.

**Storage use** – View storage used by applications.

**Battery use** – See what has been using the battery.

**Development** – Allows you to set options for application development, such as **USB debugging**, **Stay awake**, and **Allow mock locations**.

### Accounts & sync

#### **< General sync settings >**

**Background data** – Permits applications to synchronise data in the background, whether or not you are actively working in them. Un-ticking this setting can save battery power and lowers (but does not eliminate) data use.

**Auto-sync** – Permits applications to synchronise, send, and receive data on their own schedule.

#### < **Manage accounts** >

List of all Google accounts and other accounts you've added to your phone.

If you touch an account in this screen, its account screen opens.

### **Privacy**

If you select **Factory data reset**, it will erase all of your personal data from internal phone storage, including information about your Google account, any other accounts, your system/application data and settings as well as any downloaded applications and DRM license. Resetting the phone does not erase any system software updates you have downloaded or any files on your microSD card, such as music or photos. If you reset the phone in this way, you

are prompted to reenter the same information as when you first started Android.

### **SD card & phone storage**

#### < **USB connection mode** >

**Mass storage only** – Your phone can be used as a mass storage device if you have a memory card inserted. You can set the **Mass storage only** as a default setting of USB connection mode.

#### < **SD card** >

Checks total space and available space. Touch **Unmount SD card** for safe removal. If you want to delete all data from the microSD card, touch **Erase SD card** to format it.

## Settings

### < Internal SD card >

Checks total space and available space. Touch **Unmount Internal SD card** for safe removal. If you want to delete all data from the internal microSD, touch **Format Internal SD card** to format it.

### < Internal phone storage >

Checks the **Available space**.

## Language & keyboard

Use the **Language & keyboard** settings to select the language and region for the text on your phone and for configuring the onscreen keyboard, including words that you have added to the dictionary.

## Voice input & output

### < Voice input >

**Voice recognizer settings** – Use the **Voice recognizer settings** to configure the Android voice input feature.

### < Voice output >

#### **Text-to-speech settings** –

Use the **Text-to-speech settings** to configure the Android text-to-speech synthesiser for applications that can take advantage of it.

**NOTE:** If you don't have speech synthesiser data installed, only the **Install voice data** setting is available.

## Accessibility

Use the **Accessibility** settings to configure any accessibility plug-ins you have installed on your phone.

**NOTE:** Requires additional plug-ins to become selectable.

## HDMI

Adjust the HDMI connection setting. If your phone is connected with TV/PC via HDMI cable, you can see the image and video file through the TV/PC, when the video

player/image viewer is visible on your phone screen.

#### **NOTE:**

- It may take time to play media files depending on the device connected to your phone using an HDMI cable.
- Files may not be played properly when using a cable or device that is not HDMI-certified.
- The image orientation set in your phone also applies to the image displayed on the device.
- If your phone data is not displayed properly on the device due to a sync issue, you need to change the resolution of your phone. (You need to reboot your phone to reflect the new HDMI resolution.)

### **Date & time**

Use **Date & time** settings to set your references for how dates are

displayed. You can also use these settings to set your own time and time zone rather than obtaining the current time from the mobile network.

### **About phone**

View legal information and check phone status and software version.

### **Wi-Fi**

With Wi-Fi, you can use high-speed internet access within the coverage of the wireless access point (AP).

You can enjoy wireless internet with Wi-Fi, without extra charges.

### **Turn on Wi-Fi**

From the home screen, open the notification drawer and touch



on.

Or, touch **Application > Settings > Wireless & networks**, then turn **Wi-Fi** on.

## Settings

### To connect to Wi-Fi

Choose Wi-Fi network you want to connect to. If you see , you need to enter password to connect.

#### NOTE:

- If you are out of Wi-Fi area and choose 3G connection, additional charges may be applied.
- If your phone changes to sleep mode, even when connected to Wi-Fi, the Wi-Fi connection will be disabled automatically (in which case, if your phone has access to 3G data, it may be connected to the 3G network automatically and additional charges may be applied).
- The LG-P990 supports Open, WEP, WPA/WPA2 PSK, 802.1xEAP security. If your Wi-Fi service provider or network administrator sets encryption for network security, fill in the key in the pop-



up window. If encryption is not set, this pop-up window will not be shown. You can obtain the key from your Wi-Fi service provider or network administrator.

### Sharing your phone's data connection

You can share your phone's mobile data connection with a single computer via a USB cable: USB tethering. You can also share your phone's data connection with up to five devices at once, by turning your phone into a portable Wi-Fi hotspot. When your phone is sharing its data connection, an icon appears in the status bar and as an ongoing notification in the notifications drawer.

Icon	Description
	USB tethering is active



	Portable Wi-Fi hotspot is active
	Both USB tethering and portable hotspot are active

For the latest information about tethering and portable hotspots, including supported operating systems and other details, visit <http://www.android.com/tether>.

**NOTE:** An additional costs may be incurred when connecting and using online services. Check data charges with your network provider.

## USB tethering & portable Wi-Fi hotspot settings

- 1 On the home screen, touch the **Applications** tab and select **Settings**.

- 2 Touch **Wireless & networks** and select **Tethering & portable hotspot**.

- 3 Choose options that you want to adjust.

**USB tethering** – Check to share your phone’s mobile network data connection with your computer, via a USB connection.

**Portable Wi-Fi hotspot** – Check to share your phone’s mobile network data connection as a portable Wi-Fi hotspot.

**Help** – Opens a dialog with information about USB tethering and portable Wi-Fi hotspots as well as information about where to learn more.

## USB tethering and data sharing

You can’t share your phone’s data connection and microSD card via USB at the same time. If you are

## Settings

using your USB connection to make your microSD card available to your computer, you must disconnect it first.

- 1 Use the USB cable that came with your phone to connect your phone to your computer.
- 2 On the home screen, touch the **Applications** tab and select **Settings**.
- 3 Touch **Wireless & networks** and select **Tethering & portable hotspot**.
- 4 Check **USB tethering**.
  - The phone starts sharing its mobile network data connection with your computer, via USB connection. An ongoing notification  is added to the status bar and notifications drawer.
- 5 Un-tick **USB tethering** to stop sharing your data connection. Or just disconnect the USB cable.

## To share your phone's data connection as a portable Wi-Fi hotspot

- 1 On the home screen, touch the **Applications** tab and select **Settings**.
- 2 Touch **Wireless & networks** and select **Tethering & portable hotspot**.
- 3 Check **Portable Wi-Fi hotspot**.
  - After a moment, the phone starts broadcasting its Wi-Fi network name (SSID), so you can connect to it with up to five computers or other devices. An ongoing notification  is added to the status bar and notifications drawer.
  - When **Portable Wi-Fi hotspot** is ticked, you can change its network name or secure it.
- 4 Un-tick **Portable Wi-Fi hotspot** to stop sharing your data connection via Wi-Fi.

### ATTENTION!

If you set the security option as **Open**, you can not prevent unauthorised usage of online services by other people and additional charges can be incurred. To avoid unauthorised use, you are advised to keep the security option.

## How to use On-Screen Phone

On-Screen Phone allows you to view your mobile phone screen from a PC via a USB or Bluetooth connection. You can also control your mobile phone from your PC using the mouse or keyboard.

### On-Screen Phone icons



Connects or disconnects your mobile phone to/from your PC.



Rotates the On-Screen Phone window (only available at applications that support rotation).



Changes the On-Screen Phone preferences.



Exits the On-Screen Phone program.



Minimises the On-Screen Phone window.

## On-Screen Phone features

- Real-time transfer and control: displays and controls your mobile phone screen when connected to your PC.
- Mouse control: allows you to control your mobile phone by using the mouse to click and drag on your PC screen.
- Text input with keyboard: allows you to compose a text message or note using your computer keyboard.

## Settings

- File transfer (mobile phone to PC): sends files from your mobile phone (e.g. photos, videos, music and Polaris Office files) to your PC. Simply right-click and drag to send a file to your PC.
- File transfer (PC to mobile phone): sends files from your PC to your mobile phone. Simply select the files you wish to transfer and drag and drop it into the On-Screen Phone window. The files you send are stored on a micro SD card.
- Real-time event notifications: prompts a pop-up to inform you of any incoming calls or text/multimedia messages, as well as alarm notifications.

**NOTE:** The On-Screen Phone feature does not support camera preview and playing videos on your phone, so these images cannot be displayed on the PC screen.

## How to install On-Screen Phone on your PC

Visit LG Home (<http://www.lg.com>) and go to **Support > Mobile Phone Support > Download LG Mobile Support Tool** to PC. If you download LG PC Suite IV, the On-Screen Phone program will also be downloaded on your PC. Then you can install the On-Screen Phone on your PC.

## How to connect your mobile phone to your PC

### USB connection:

- 1 Open Connection Wizard, select "USB Cable connection" and click "Next".
- 2 Connect your mobile phone to the PC using a USB cable and click "Next".
- 3 Enter the On-Screen Phone password and click "Next".

The default password is "0000". You can change the password in **Settings > Wireless & Networks > On-Screen Phone Settings**.

- 4 Click "OK" to exit the window.

### **Wireless connection with Bluetooth:**

- 1 On your mobile phone, go to **Settings > Wireless & networks > Bluetooth settings**. Turn on **Bluetooth** and tick **Discoverable**.
- 2 If you have previously connected using a cable, run the New Connection Wizard to create a new connection.
- 3 Run the Connection Wizard on the computer, select "Bluetooth connection", then "Next".
- 4 The wizard starts searching for Bluetooth-enabled mobile phones. When the mobile phone

that you wish to connect to appears, click "Stop" to stop searching.

- 5 Select "LG-P990" from the device list and click "Next". You can rename the device if you wish.
- 6 Enter the PIN code (e.g. "0000") and click "Next".
- 7 On your mobile phone, accept the request and enter the same PIN code, then touch "OK".
- 8 Enter the On-Screen Phone password and click "Next" (the default password is "0000").
- 9 Touch "OK" to exit.

### **To check the phone to PC connection**

Once the devices have been connected, drag down the notification bar at the top of the home screen to check the On-Screen Phone connection status.

## Settings

### To disconnect your phone from your PC

Click  in the top left of the On-Screen Phone window. Or, drag down the notification bar at the top of the home screen and select "On-Screen Phone". Touch "Yes" in the Disconnect window.

**NOTE:** You must restart your phone after shutting down the On-Screen Phone service.

### Phone Software update

#### LG Mobile Phone Software update from internet

For more information on using this function, please visit the <http://update.lgmobile.com> or <http://www.lg.com/common/index.jsp> → select country and language.

This feature allows you to update the firmware of your phone to the newer version conveniently from the internet without the need to

visit a service centre. This feature is only available if and when LG makes the newer version of the firmware available for your device.

As the mobile phone firmware update requires the user's full attention for the duration of the update process, please make sure to check all instructions and notes that appear at each step before proceeding. Please note that removing the USB data cable or battery during the upgrade may seriously damage your mobile phone.

**NOTE:** LG reserves the right to make firmware updates available only for selective models at its own discretion and does not guarantee the availability of the newer version of the firmware for all handset models.

## F-Secure Mobile Security

On your mobile phone, go to **Settings > Location & security > Select device administrators.**

F-Secure Mobile Security™ allows you secure your mobile computing by combining virus protection, antitheft and browsing protection.

It supports the following features

- Automatic scanning upon installation
- Automatic scanning when memory card inserted
- Manual scanning
- Remote lock and wipe
- theft control

## Remote Call

It is a standard online support solution.

Remote Call + Mobile pack is a remote support solution that enables support representatives to view and control the customers mobile screen on their pc in order to remotely diagnose and fix mobile problems.

**NOTE:** This feature is dependent on the network service provider, region or countries.

## Copyrights and trademarks

Rights to all technologies and products that comprise this device are the property of their respective owners:

- Bluetooth® is a registered trademark of the Bluetooth SIG, Inc.
- microSD™ and the microSD logo are Trademarks of the SD Card Association.
- Google™, Google Maps™, Gmail™, YouTube™, Google Talk™ and Android Market™ are trademarks of Google, Inc.
- Wi-Fi is a registered trademark of the Wireless Fidelity Alliance, Inc.



Manufactured under license from Dolby Laboratories. "Dolby" and the double-D symbol are trademarks of Dolby Laboratories.



- Contains Adobe® Flash® Player or Adobe AIR® technology under license from Adobe Systems Incorporated. Copyright © 1995-2011.

### • DivX Mobile



ABOUT DIVX VIDEO: DivX® is a digital video format created by DivX Inc. This is an official DivX Certified® device that plays DivX video. Visit [www.divx.com](http://www.divx.com) for more information and software tools to convert your files into DivX video.

ABOUT DIVX VIDEO-ON-DEMAND: This DivX Certified® device must be registered in order to play purchased DivX Video-on-Demand (VOD) movies. To obtain your registration code, locate the DivX VOD section in your device setup menu.



Go to [vod.divx.com](http://vod.divx.com) for more information on how to complete your registration.

**DivX Certified® to play  
DivX® video up to HD 720p,  
including premium content.  
May play  video up to  
1920x1080.**

**DivX®, DivX Certified®  
and associated logos are  
trademarks of DivX Inc. and  
are used under license.**

### **Notice!**

#### **Open Source Software**

To obtain the corresponding source code under GPL, LGPL, MPL and other open source licenses, please visit <http://opensource.lge.com/>  
All referred license terms, disclaimers and notices are available for download with the source code.

## Accessories

These accessories are available for use with the LG-P990.  
(Items described below may be optional.)

### Charger

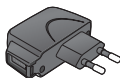

### Data cable

Connect your LG-P990 and PC.



### Battery



### User Guide

Learn more about your LG-P990.



### Stereo headset



### NOTE:

- Always use genuine LG accessories.
- Failure to do this may void your warranty.
- Accessories may vary in different regions.

# Technical data

## Ambient Temperatures

**Max:** +55°C (discharging), +45°C (charging)

**Min:** -10°C

### Declaration of Conformity



#### Suppliers Details

Name

LG Electronics Inc

Address

LG Twin Tower 20, Yeouido-dong, Yeongdeungpo-gu Seoul, Korea 150-721

#### Product Details

Product Name

GSM 850 / E-GSM 900 / DCS 1800 / PCS 1900 Quad Band and WCDMA Terminal Equipment

Model Name

LG-P980

Trade Name

LG

CE0168

#### Applicable Standards Details

RATTE Directive 1999/5/EC

EN 301 489-01 V1.8.1 / EN 301 489-07 V1.3.1 / EN 301 489-17 V2.1.1 /  
EN 301 489-19 V1.2.1 / EN 301 489-24 V1.4.1  
EN 300 328 V1.7.1  
EN 60950-1 2006+A11:2009  
EN 50360:2001 / EN62209-1:2006 / IEC62209-2:2010  
EN 301 511 V9.0.2  
EN 301 908-1 V4.2.1 / EN 301 908-2 V4.2.1

#### Supplementary Information

The conformity to above standards is verified by the following Notified Body(BABT)

BABT, Forsyth House, Churchfield Road, Walton-on-Thames, Surrey, KT12 2TD, United Kingdom  
Notified Body Identification Number : 0168

#### Declaration

I hereby declare under our sole responsibility that the product mentioned above to which this declaration relates complies with the above mentioned standards and Directives

Name

Dao Haeng Lee / Director

Issued Date

18. Feb. 2011

LG Electronics Logistics and Services B.V.  
Veluwezoom 15, 1327 AE Almere, The Netherlands

Signature of representative

## Troubleshooting

This chapter lists some problems you might encounter while using your phone. Some problems require you to call your service provider, but most are easy to correct yourself.

Message	Possible causes	Possible Corrective Measures
SIM error	There is no SIM card in the phone or it is inserted incorrectly.	Make sure that the SIM card is correctly inserted.
No network connection/ Losing network	Weak Signal outside of GSM network area. Operator applied new services	Move towards a window or into an open area. Check the network operator coverage map. Check if the SIM card is older than 6~12 months. If so, change your SIM at your network provider's nearest branch.
Codes do not match	To change a security code, you will need to confirm the new code by entering it again. The two codes you have entered do not match.	The default code is [0000]. If you forgot the code, contact your service provider.
Any application cannot be set	Not supported by service provider or registration required	Contact your service provider.

Message	Possible causes	Possible Corrective Measures
Calls not available	Dialling error	New network not authorised.
	New SIM card inserted	Check for new restrictions.
	Prepaid Charge limit reached	Contact service provider or reset limit with PIN 2.
Phone cannot be switched on	On/Off key pressed long enough	Press the On/Off key down for at least two seconds.
	Battery is not charged	Keep charger attached for longer. Clean the contacts.
	Battery contacts are dirty	Take out the battery and insert again.
Charging error	Battery is not charged.	Charge battery.
	Outside temperature is too hot or cold	Make sure phone is charging under normal temperatures.
	Contact problem	Check the charger and connection to the phone. Check the battery contacts and clean them if necessary.
	No voltage	Plug into a different socket.
	Charger defective	If the charger does not warm up, replace it.
	Wrong charger Battery defective	Only use original LG accessories. Replace battery.
Number not permitted	The Fixed Dial Number function is on.	Check settings.

## Troubleshooting

Message	Possible causes	Possible Corrective Measures
Impossible to receive/ send SMS & Picture	Memory Full	Delete some existing messages in the phone.
Files not open	Unsupported file format	Check the file format that can be supported
SD Card not working	FAT 16 file system supported only	Check SD card file system via card reader Or format SD card using phone
The screen does not turn on when I receive a call.	Proximity sensor problem	If you use any protection tape or case, check if it is covering the area around the proximity sensor. Make sure that the area around the proximity sensor is clean.
No Sound	Vibration or manner mode	Check the settings status of the sound menu to make sure you are not in vibrate or silent mode.
Hang up or freeze	Intermittent software problem	Remove battery and re-insert battery. Turn on the phone. Try to do a software update service via WEB site.



**CHOLAMANDALAM MS GENERAL INSURANCE CO. LTD.**  
**Delhi Regional Office Plot no. 6, First Floor,Opp.**  
**HP Petrol Pump, Near Metro Pillar No. 81**  
**Pusa Road, Delhi - 110005**

TO

CHOLAMANDALAM MS GENERAL  
INSURANCE CO. LTD.  
Delhi Regional Office Plot no. 6,  
First Floor,Opp. HP Petrol Pump,  
Near Metro Pillar No. 81 Pusa Road,  
Delhi - 110005

DATE...../...../.....

Dear Sir,

RE: Loss of mobile phone no.: .....

MAKE .....MODEL .....

This is to inform that my mobile phone has been lost due to theft on  
.....at.....FIR/DD entry has been lodged  
with ..... Police Station. I am enclosing the Claim  
Form cum Bill along with required documents for settlement of the claims.

Thanking you

Yours Sincerely,

Signature of the Insured

Name

### CLAIM FORM CUM CLAIM BILL

To be filled in by the ultimate consumer

Name																									
Present Address																									
Tel. No.																									
Make & Model of the Handset																									
Invoice No.									Date of Purchase																
Dealer Name																									
Address																									
Tel. No.																									
IMEI No.																									
Date of Theft									Time																
Place of Theft																									
Details of Theft																									
FIR No./DD No.									Date																
Police Station																									
Amount Claimed																									
Block the SIM Card within 3 days	YES <input type="checkbox"/>												NO <input type="checkbox"/>												

DATE

PLACE

SIGNATURE OF CUSTOMER

#### TERMS AND CONDITIONS:

##### POLICY COVERAGE

1. Theft coverage of LG GSM HANDSET for one year from the date of purchase/invoice only. No other loss covered.
2. Offer applicable on all purchases made from April 7, 2011 to April 6, 2012. under Policy No. **PBG-00030389-000-00**. Dated 07/04/11
3. Only theft registered under section 379 IPC or theft reported under Daily Dairy with Police FIR is covered.
4. Reimbursement will be subject to following depreciation/ deduction on the invoice value from date of purchase:
 

Handset upto 3 months old	-10%
More than 3 months upto 6 months	-15%
More than 6 months upto 9 months	-25%
More than 9 months upto 12 months	-35%



## **CLAIM PROCESSING DOCUMENTS**

In the event of handset loss, the buyer should follow the understated procedure:

- a) (i) Lodge FIR under Section 379 IPC or theft to be entered in Daily Dairy with the Police Station in whose jurisdiction the theft occurred within 24 hours of occurrence of the same.
- (ii) Block the SIM Card with your service provider within 3 days.
- (iii) Send information to the insurance company within 7 days of the loss.
- b) Documents required:
  - (i) Original Invoice & Cash Memo.
  - (ii) Original certified copy of DD/FIR u/s 379 by the police authority.
  - (iii) Translation of vernacular documents in English/Hindi.
  - (iv) Complete claim Form cum Bill and Discharge Voucher.

These documents should be sent to the Policy Issuing Office within 7 days of the loss by regd. post/courier. All document to be submitted in English/Hindi language. The company reserves the right to call for any other necessary document in addition to the documents listed above.

Subject to all the conditions being fulfilled, claim will be settled within 15 days of our receipt of the above documents.

Deduction of Rs. 350/- will be applicable towards accessories.

**Note:** In case the handset cost is more than Rs. 20,000/-, a survey is required. Contact nearest office of Chola Mandalam MS General Insurance Co. Ltd. for survey.

For any future queries assistance related to the policy exclusion and claim settlement you may write to Chola Mandalam MS General Insurance Co. Ltd. **Delhi Regional Office Plot no. 6, First Floor, Opp. HP Petrol Pump, Near Metro Pillar No. 81 Pusa Road, Delhi - 110005**

**Tel: +91-11-39813100, Fax: +91-11-39813110**

**e-mail id : [customercare@cholams.murugappa.com](mailto:customercare@cholams.murugappa.com)**



---

### DISCHARGE VOUCHER

Received from Chola Mandalam MS General Insurance Co. Ltd. under Policy No. .... in full and final discharge of our claim, the sum of ..... (in words) Rs. ....

Signature of Insured /Customer  
across revenue stamp

Affix Re.1 revenue stamp

Date:

Place:

## Customer Information Center

For any query related to the after sales service and customer support please contact us at below details

 **LG** **24 x 7** CALL CENTER

 **1800-180-9999**  
(Toll Free)

 **5757554**  
(Send SMS)

 [www.lg.com](http://www.lg.com)  
[serviceindia@lge.com](mailto:serviceindia@lge.com)

.....

.....

.....

.....

.....

.....

.....

.....

.....

.....

.....

.....

.....

.....

.....

.....

.....

.....

.....

.....

.....

.....

.....

.....

.....

.....

.....

.....

.....

.....

.....

.....

.....

.....

.....

.....

