

# GiONEE S6 User Guide



**Disclaimer:** The colors, specifications, functions and graphics shown/mentioned in the user manual may differ from the actual product. In such a case, the latter shall govern. Images shown are for representation purpose only. Specifications are subject to change without prior notice. GiONEE keeps the right to modify the content in this user guide without prior notice.

1. For your safety .....	1
2. Learn about the phone .....	2
● Overview .....	2
● Function Keys .....	2
3. Before using .....	2
● Insert SIM card and SD card .....	2
● Charge the Battery .....	4
4. Getting started.....	4
● Basic Function .....	4
● Home screen.....	4
● Touch screen .....	6
5. Communication .....	7
● Make a call .....	7
● Ongoing call.....	7
● Incoming call .....	8
● Send a Message .....	8
6. Multimedia.....	9
● Camera .....	9
● Gallery .....	11
● Music .....	11
7. Connection.....	11
● Airplane mode .....	12
● Mobile Networks.....	12
● WLAN.....	12
● Bluetooth.....	12
● HotKnot .....	13
● USB.....	13
8. Advanced Features .....	13
● Secret shooting .....	13
● Super screenshot.....	14
● Extreme mode .....	16
● Chameleon.....	17
● Security .....	17
● AmiClone.....	18
● Kids Home.....	<a href="#">19</a>
9. Operation .....	20
● Smart gestures .....	20
● Suspend option .....	22
10. Health and safety .....	23
● SAR Compliance .....	23
● SAR Recommendations .....	23
● E-Waste .....	24
● Operating Temperature.....	25
11. FAQ .....	25

# 1. For your safety

Please read this manual before using the cell phone to ensure safe and proper use.



## SWITCH OFF IN HOSPITALS

Please abide by relevant provisions or regulations. Please turn off your mobile phone near medical equipment.



## SWITCH OFF WHEN REFUELING

Don't use the phone at a refueling point. Don't use near fuel or chemicals.



## SIM CARDS AND SD CARD ARE PORTABLE

Keep your phone, phone parts and accessories out of children's reach.



## BATTERY

Please do not destroy or damage the battery, it can be dangerous and cause fire.

Please do not throw battery in fire to avoid hazard.

When battery cannot be used, please dispose in safe environment.

Do not try to dismantle the battery.

If the battery or the charger is broken or old, please stop using them, and replace with certified genuine battery



## USE QUALITY EQUIPMENT

Use authorized equipment to avoid danger



## ROAD SAFETY COMES FIRST

Give full attention while driving, Park before using your phone. Please follow traffic rules of local city town.



## INTERFERENCE

All wireless devices may be susceptible to cause interference, which could affect performance.



## SWITCH OFF IN AIRCRAFT



Wireless devices can cause interference in aircraft. It's not only dangerous but also illegal to use mobile phone in an aircraft.

## 2. Learn about the phone

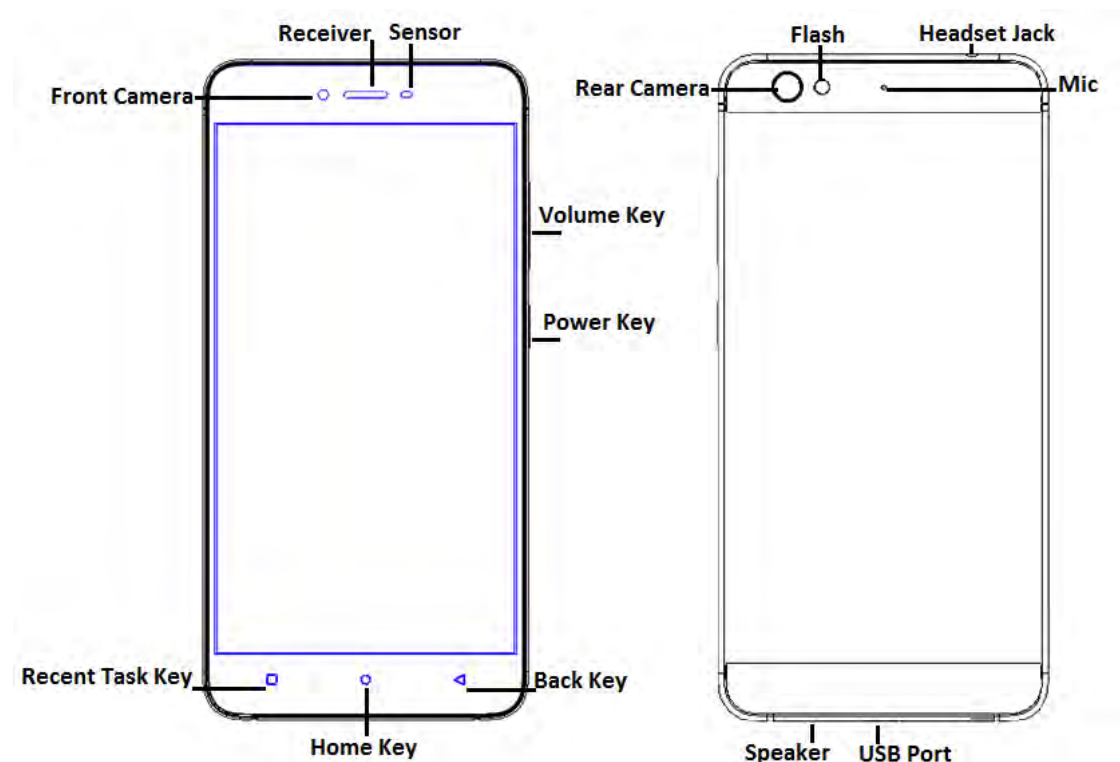
### Overview

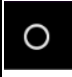

### Function Keys

Keys	Icon	Function
<b>Power key</b>		a) Press to turn on/off the screen. b) Press and Hold to power off the phone or reboot.
<b>Volume key</b>		Press to adjust the volume of device.
<b>Recent task key</b>		Tap to open the list of recently used apps. Tap "CLOSE ALL" to clean all of recently used apps. Shake the phone to clean all of recently used apps.
<b>Home key</b>		Tap to return to Home screen. Long press to access Google™ search.
<b>Back key</b>		Tap to return to the previous screen.

## 3. Before using

The phone is a Dual SIM mobile that allows you to use two mobile networks.

### Insert SIM card and SD card

- 1) Stick into the pin hole with eject tool, and then card tray will be out of phone.

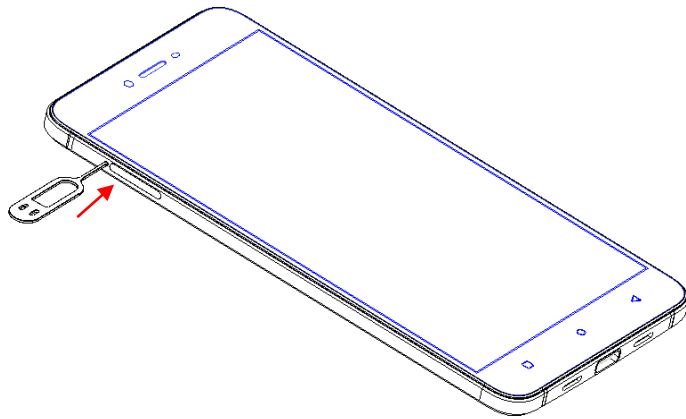

2) Put SIM card and SD card to card tray correctly.

**SIM 1** supports Micro SIM card.

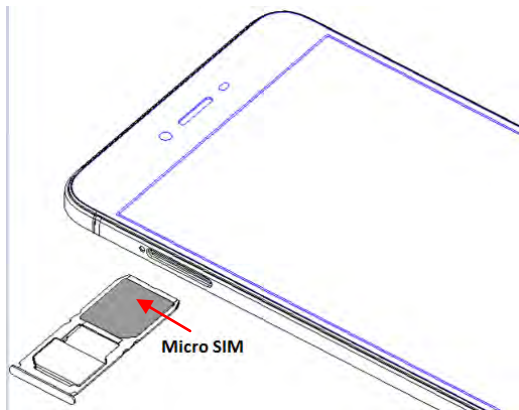

**SIM 2** supports SD card OR Nano SIM card.

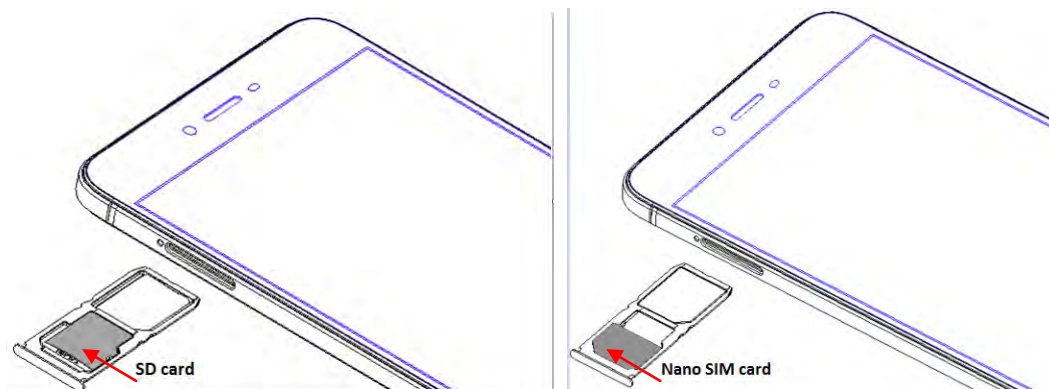

3) Push the card tray into the phone.

✓ **Note:**

- Micro / Nano SIM card and SD card support hot plugging.
- Do not remove the cards while the device is transferring data. Doing so may cause data to be lost or damage to the cards and device.
- The Micro SIM card and SD card are small parts. Please keep away from Children to

avoid swallowing the card by accident.

- Please do not touch the metal surface of Micro SIM and SD cards and keep them away from electromagnetic field to avoid damaged data.

### **Charge the Battery**

Charge the battery before using it. Connect the USB cable to the USB power adaptor, and then plug the end of the USB cable into the USB Port.



### ✓ **Note:**

- This device equips with USB Type C, it can be positive and negative plug in. Please don't use the other USB cable to plug in, otherwise the USB port will be damaged.
- The battery of mobile phone is fixed. It cannot remove.

## **4. Getting started**

### **Basic Function**

- Turn on the phone  
Press and hold for a while the power key to turn on the phone.
- Turn off the phone  
Long press the power key until a menu shows. Choose "Power off" to turn off the phone.
- Restart the phone  
Option 1: Long press the power key until a menu shows. Choose "Reboot" to restart the phone.  
Option 2: Long press the power key till 12 seconds to auto restart the phone.
- Lock the screen  
Option 1: Press the power key to turn off the screen and lock it  
Option 2: In the Home screen, double tap the screen to lock it.  
Option 3: The screen will auto lock if you don't use the phone for a while.
- Unlock the screen  
Press the power key, and then slide to top for unlocking.

### **Home screen**

The Home screen is your starting point to access all the features on your phone. It displays application icons, widgets, and other features. You can customize the Home screen with different wallpaper and display the items you want.

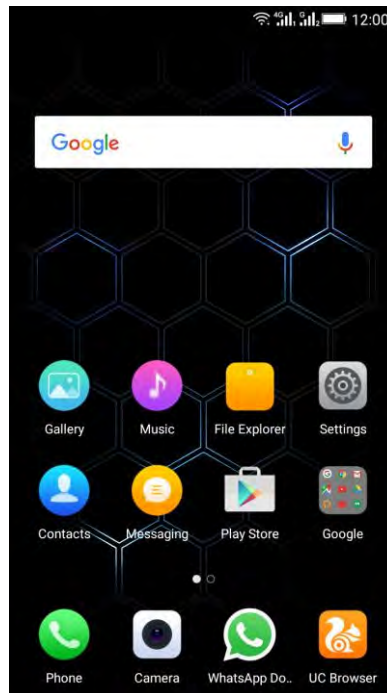

- Status Bar  
At the top of the screen, it displays the time, signal, battery information, and icons for notifications that you've received.
- Notification Center  
Swipe down from the top edge to see more detail of the new notification, such as messaging, missed call, Wi-Fi connection. Tap the notification and drag to left or right to delete it.
- Control Center  
Swipe up from the bottom edge. In the control center, it's a quick access to Torch, Fake call, Calculator, and Camera. You can also adjust the brightness and turn on / off Airplane mode, Wi-Fi, Data connection, Bluetooth, Location, Rotate screen, Vibrate, Sound, Extreme mode, and Super screenshots.

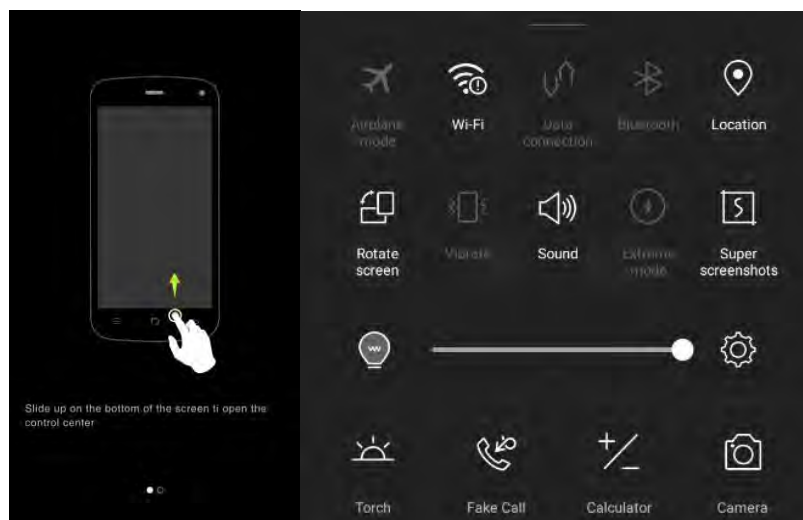

- Desktop Menu

Slide to top on the touch screen to open the desktop menu. You can change the Launcher Theme & Wallpaper, edit desktop. It's a quick access to Desktop Settings, System Settings and Search.

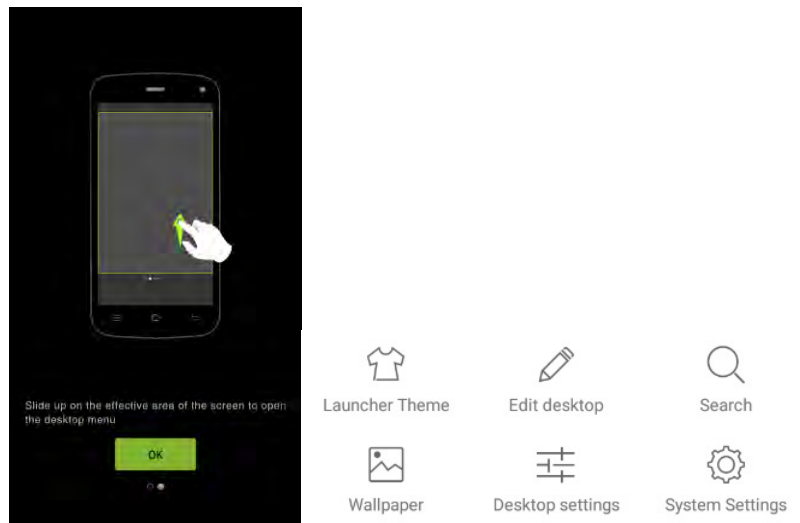

- Move an application

Touch & hold the icon you want to move. Drag the icon to move or cross at the edge of the screen to move into another screen.

- Uninstall an application

Touch & hold the icon you want to uninstall. On the top / bottom of the icon will appear "Uninstall". Tap it to uninstall.

- Creating a folder

Drag an icon on the top of another one to create a folder. Open the folder and then touch & hold the folder name to rename it.

## **Touch screen**

The way to control mobile phone is using your finger on touch icons, buttons, menu items, the onscreen keyboard, and other items on the touch screen.

- Touch: To act on items on the screen, such as application and settings icons, to type letters and symbols using the onscreen keyboard, or to press onscreen buttons, you simply touch them with your finger.
- Touch & hold: Touch & hold an item on the screen by touching it and not lifting your finger until an action occurs.
- Drag: Touch & hold an item for a moment and then, without lifting your finger, move your finger on the screen until you reach the target position. You can drag items on the Home screen to reposition them and you can drag to open the Notification Center.
- Swipe or slide: To swipe or slide, quickly move your finger across the surface of the screen, without pausing when you first touch (so you don't drag an item instead). For



example, you slide the screen up or down to scroll a list, and in same way Calendar views you can swipe quickly across the screen to change the range of time visible.

- Pinch: In some applications (Such as Maps and Gallery) you can zoom in and out by placing finger and thumb on the screen at same time and pinching them out together (to zoom out) or spreading them apart (to zoom in).
- Rotate the screen: On most screens, the orientation of the screen rotates with the phone as you turn it from upright to its side and back again. You can turn this feature on and off.

## 5. Communication

### Make a call

- Touch the phone icon on the Home screen.
- Enter the phone number you want to dial.
- Touch the phone icon to dial the number that you entered.

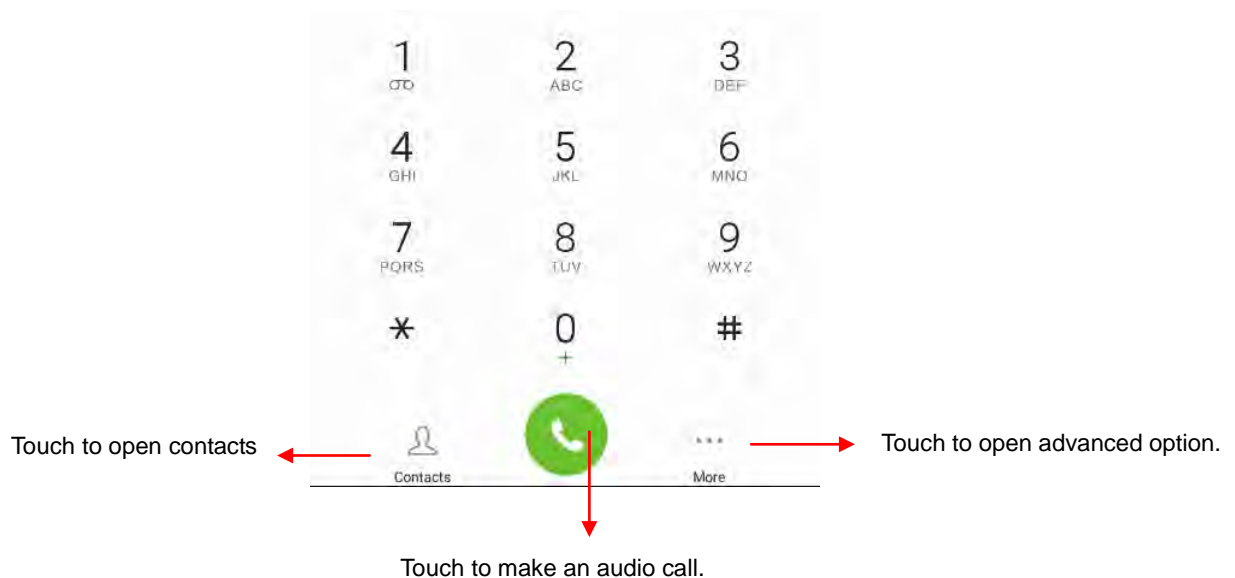

### Ongoing call

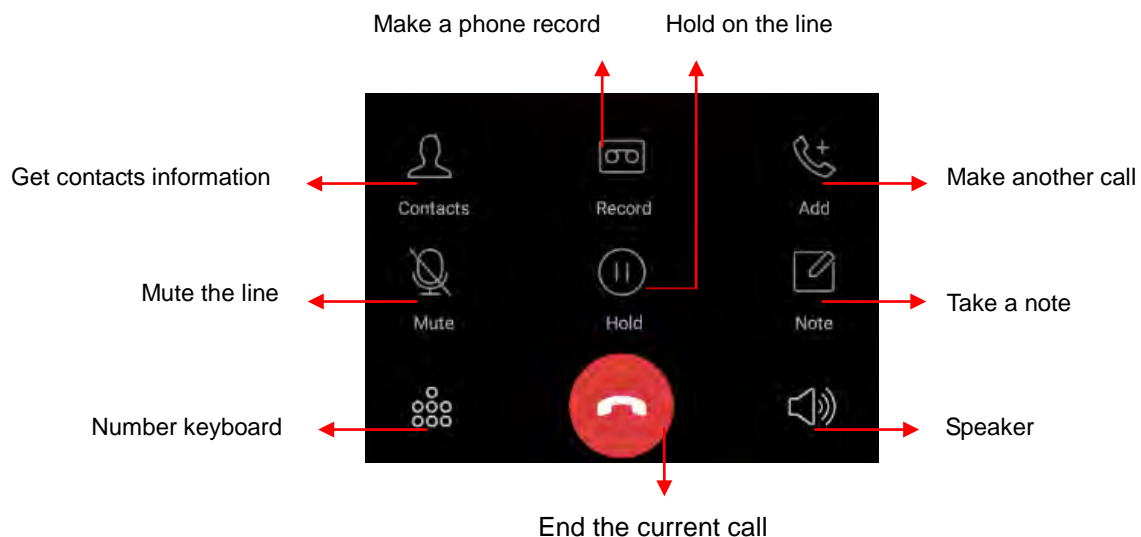

## Incoming call



### ✓ **Note:**

You can make an emergency call without SIM cards if the locations are available for the network service. But you should not rely on it for emergencies. It's also depends on the local mobile network operator. For more information, please contact with operator.

## Send a Message

You can use this phone to exchange text messages and multimedia messages with your friends on their mobile phones. The messages come to and from the same contact or phone number will be visible into a single conversation, so you can see your entire message history with a person conveniently.

### Enter text

- Tap the text field to see onscreen keyboard.
- Tap the keys on the keyboard to type; the characters you've entered appear in a strip above the keyboard. With suggestions for the word you are typing to the right.
- Use the Delete key to erase characters to the left of the cursor.
- When you're finished typing, Press Back to close the keyboard.

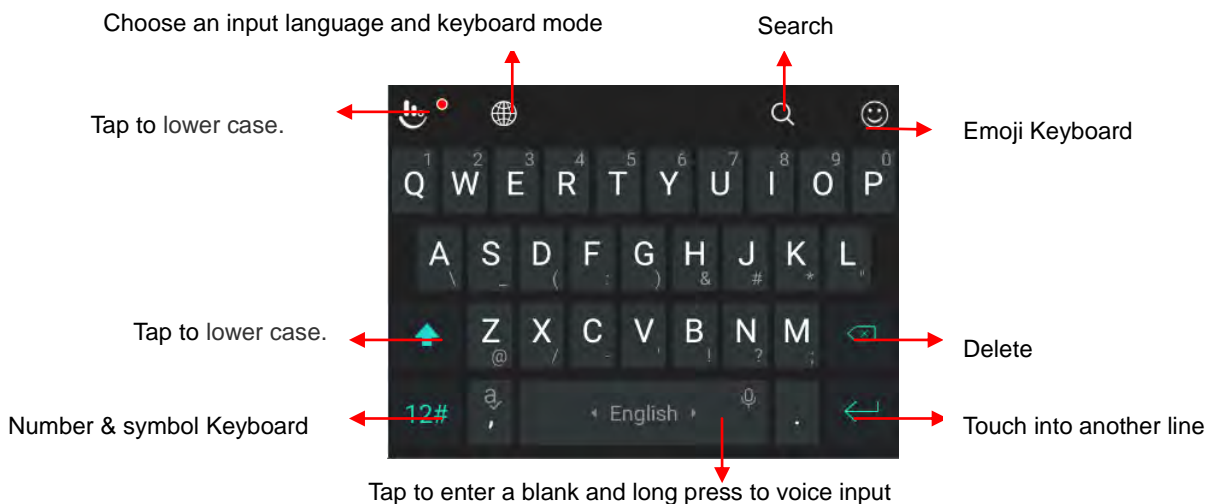

## 6. Multimedia

### Camera

Camera is a combination of camera and camcorder that you use to shoot and share pictures and videos. Tap the image on the camera screen where should focus on. You can also change camera setting like transfer front and rear camera, adjust the exposure on this screen.

#### Take a photo

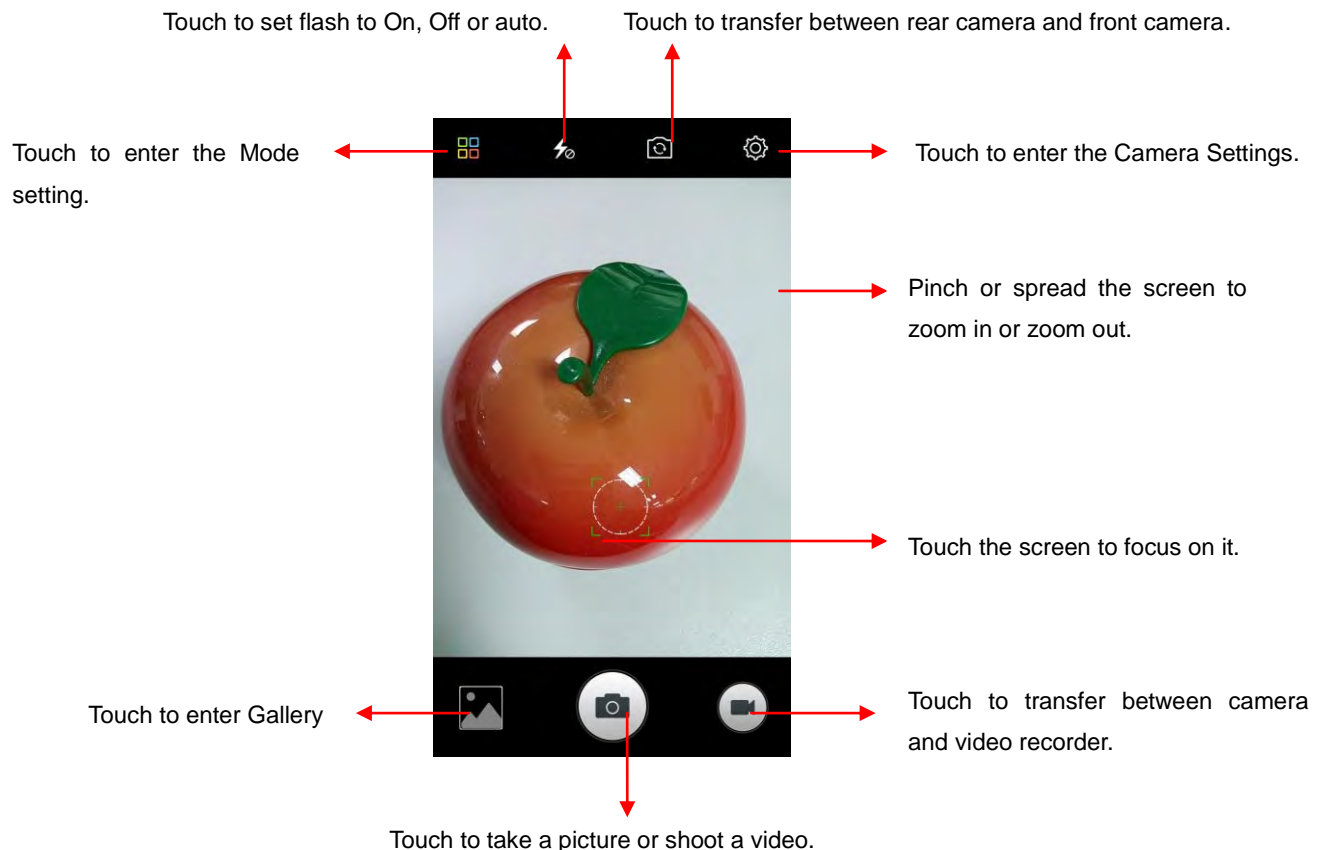

- **Normal Mode** - Take a perfect photo.
- **Professional Mode** - Change the clarity and focus mode. For Rear camera only.
- **Face Beauty Mode** - DIY your face with Smoother, Whitening, Slimming, Enlarger. Drag the slider to adjust it.
- **Take anytime Mode**
  - Best shoot, recommend the best photo.
  - Tracks, record the object movement trail and then merge into a picture.
  - Best face. Focus on the best facial expressions while taking a group photo.
  - Motion blur, make the moving object clear as the background is fuzzy.
  - Eraser, remove the moving objects from the photos.
- **Magic Focus Mode** - The effect will be better if a close-range and long-range object are included. For Rear camera only.
- **Filter Mode** - Multiple filters can select from Normal, LOMO, Hazy, Halos, Time, Food,

Beauty, Sweet, Vintage, and B&W.



- **HDR Mode** - High-Dynamic Range mode will improve the light and the shadow effect at the same time. For Rear camera only.



- **Panorama Mode** - Press camera button and move the phone on one direction slowly. For Rear camera only.
- **Night Mode** - Through nightscape noise reduction, we see the thing in the photo clear in night also. For Rear camera only.



- **Pic Note Mode** - Intelligent crop and optimize the text photo once shooting. For Rear camera only.



- **Ultra pixel Mode** - Take HD photos five times as much as the maximum pixel. For Rear camera only.
- **Smart scene Mode** - Change camera mode to: Night, HDR, fog/flare or auto based on the view.
- **Scan Mode** - Put the QR/Bar code in the box for scanning.
- **GIF Mode** - Click and continuous shooting 20 photos, GIF will be generated.

### Shoot a Video

- Tap video icon to switch it for video capturing mode.

- Adjust the quality and other settings if you wish or leave them on automatic mode.
- Point the lens to frame the scene where you want to start.
- Touch the Start Video icon. Camera starts shooting the video.
- Touch Stop video icon to stop shooting. An image from your most recent video is displayed as a thumbnail at the bottom left

## **Gallery**

Touch the Gallery icon in the Launcher to view albums of your pictures and videos which you've taken from camera. You may share the pictures and videos with your friends by Messaging, Email, Bluetooth and so on.

You can also encrypt the private photos.

- To View files: **Gallery-->Pinch out and enter private album**
- To Backup files: **File Explorer --> File --> Phone storage --> Pictures --> More --> Show hidden files --> .Gallery Safe --> si.**

## **Music**

You can use Music player to organize and listen to music and other audio files that you transfer to your phone from your computer.

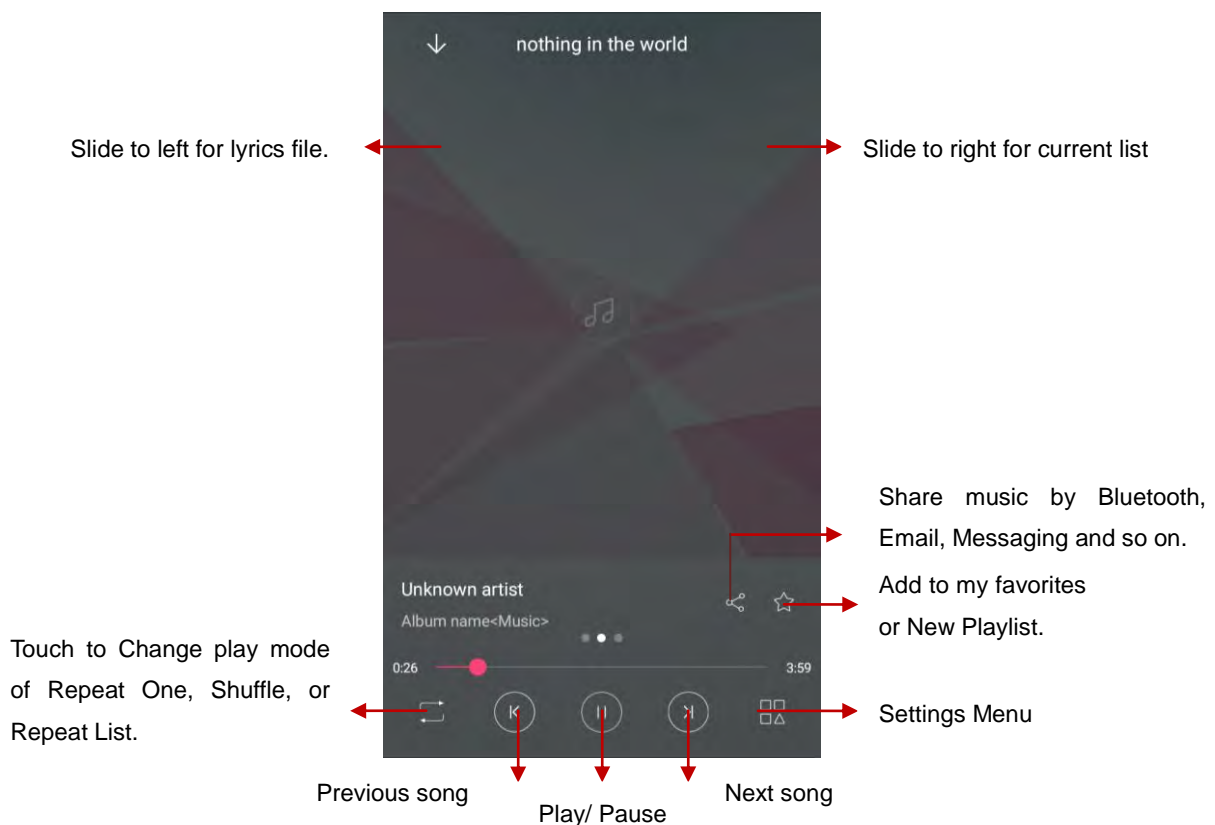

## **7. Connection**

Your phone can connect to a variety of networks and devices, including mobile networks

for voice and data transmission, WLAN data networks, and Bluetooth devices, such as headsets. You can also connect your phone to a computer, to transfer files from your phone storage, and share your phone's mobile data connection via USB or as a portable WLAN hotspot.

### **Airplane mode**

**Settings-->Airplane mode** to turn it on

Some locations like Airplane may require you to turn off your phone's Cellular network, WLAN, and Bluetooth wireless connections. You can turn off all these wireless connections at once by placing your phone on Airplane mode.

### **Mobile Networks**

When you assemble your phone with a SIM card from your wireless service provider, your phone is configured to use your provider's mobile networks for voice calls and for transmitting data.

**Settings-->Mobile Networks-->Network operators**

The name of the wireless service provider you're currently registered with is selected in the list.

### **WLAN**

WLAN is a wireless networking technology that can provide internet access at distance of up to 100 meters, depending on the WLAN router and your surroundings. You can configure the WLAN as follow:

- **Settings-->WLAN**, check **WLAN** to turn it on.
- Enter **WLAN**. The phone scans for available WLAN networks and displays the names of those it finds. Secured networks are indicated with a Lock icon. The phone will auto login to the network if you have previously connected.
- Touch a network to connect to it.  
If the network is open, you are prompted to confirm that you want to connect to that network by touching connect. If the network is secured, you're prompted to enter a password or other credentials.

### **Bluetooth**

Bluetooth is a short-range wireless communications technology that devices can use to exchange information over a distance of about 10 meters. The most common Bluetooth devices are headphones for making calls or listening to music, hands-free kits for cars, and other portable device, including laptops and cell phones.

To send a file

- **Settings--> Bluetooth**, check **Bluetooth** to turn it on.
- Enter **File Explorer** to select a file, Select **More--> SHARE--> Bluetooth**.
- Touch **Scan for devices**, the phone will scan for and display the names of all available Bluetooth devices in range.
- Touch the names of the other device in the list to pair them. After pairing the file will

be sent.

#### To receive a file

**Settings--> Bluetooth**, check **Bluetooth** to turn it on. Ensure your Bluetooth has been connected within visibility time.

You can receive files from the devices which are paired with yours. The file you received will be saved to the “**Bluetooth**” folder in the File Explorer.

#### To connect to a Handsfree device

- Turn on the Handsfree device, make it in a searchable state;
- **Settings-->Bluetooth**, Select “**Search for devices**”;
- After searching for the Handsfree device, Select it in the list to pair.
- After pairing, you can use the Handsfree device to listen to music, video and receive call.

#### **HotKnot**

HotKnot is used for data exchange when the screen touches another device.

**Settings--> HotKnot**. Turn on the **HotKnot**.

**Gallery-->Choose a Picture or Video -->Share --> HotKnot Share**, then use screen to touch another device and the picture or video will be sent to another device.

- Ensure the receiving device has turned on HotKnot and keep its screen unlocked.
- Put your device onto the receiving device screen to screen.
- Take your device away from the receiving device after you hear a voice prompt.

#### **USB**

You can connect the phone to your computer with a USB cable to transfer music, pictures, and other files.

#### Turn on USB connection

1. Connect the phone to your computer with a USB cable.
2. Open the notification center and tap **Connected as a media device** to access files on this device.
3. Other USB options can be chosen.

**Charging**, connected as a USB for charging.

**View photos**, connected as a camera to browse photos on PC only.

#### ✓ **Note:**

Do not disconnect the USB cable from the phone when you are transferring files. Doing so may cause data loss or phone damage.

## **8. Advanced Features**

#### **Secret shooting**

In control center, long press the Camera key by 3 seconds to take a photo secretly. The



secret photo is auto saved in “Phone Storage/SD Card --> DCIM --> Camera”.



### 🌈 Super screenshot

In the control center, tap to access Super screenshots. Super screenshots includes Normal screenshots, Long screenshots and Part screenshots. To view on: **File Explorer --> Phone Storage / SD card --> Screenshots**

- Normal screenshots  
Capture 1 page in screenshots.

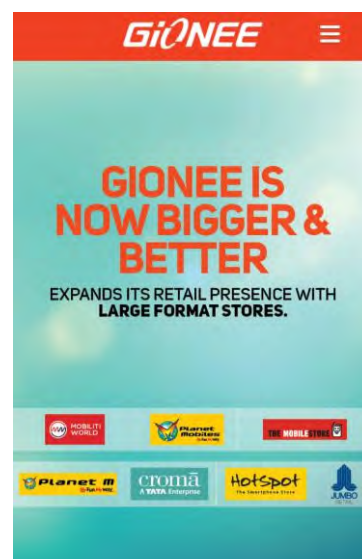

- Long screenshots  
Capture 10 pages at most in screenshots. It's easy for you to save conversations in



commutation tools, articles in website and so on.

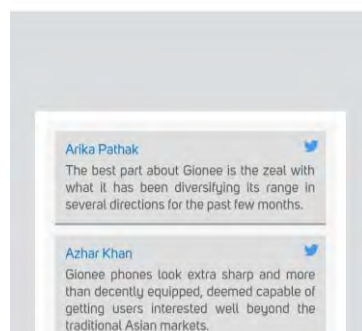
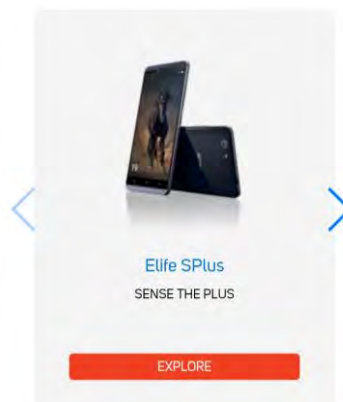

- Part screenshots  
Capture part size in screenshots. You can adjust the size with square on the screen.



### **Extreme mode**

Extreme mode lets mobile phone enter the minimalist desktop to extend standby time. But only phone, contacts, messaging and clock can be used during this time.

#### Access to extreme mode

- 1) **Home screen-->Control center-->Tap Extreme mode**
- 2) **Home screen-->System Manager-->Power Manager -->Tap Extreme power saving mode**
- 3) **Settings--> Power management -->Power manager-->Select Extreme power saving mode**

Tap to exit the extreme mode

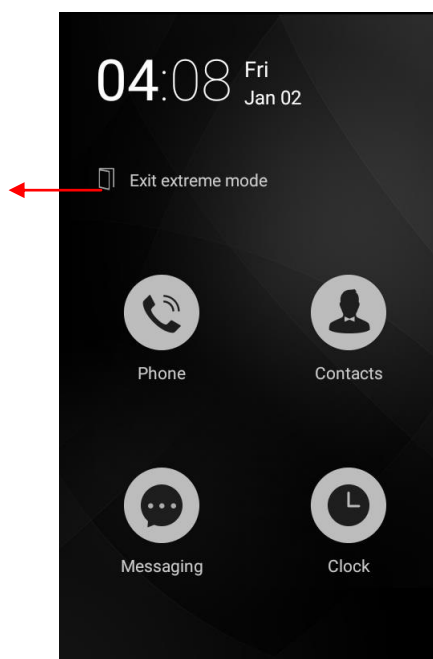

## Chameleon

With Chameleon, you can pick color with front or rear camera. Click anywhere or drag the color point to pick your favorite to design the colors of phone background.

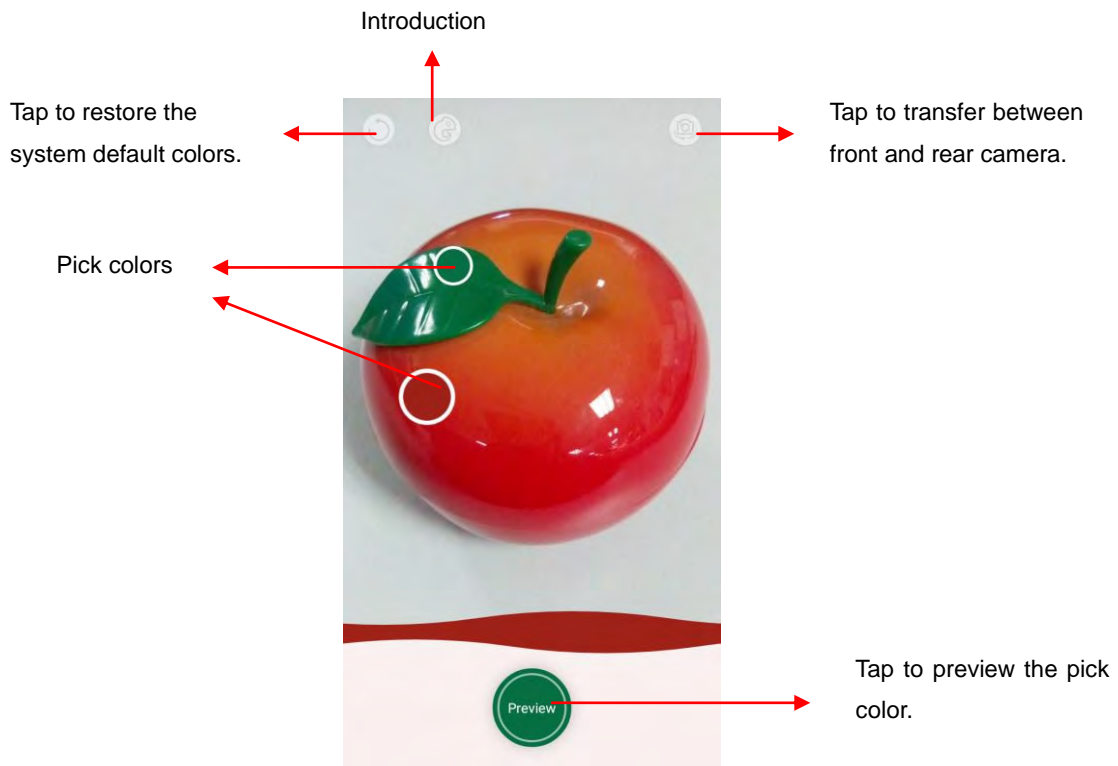

## Color Preview



## Security

Security features protect the information on your phone from being accessed by others.

- **Guest Mode**

Guest mode hides some private information like call logs, messages, albums, desktop edit etc. On lock screen, it's a quick success to enter Guest Mode with three fingers slide to the top of the screen. Or enter to **Settings --> Security --> Guest mode**

- **Face Unlock**

- 1) Look at your phone and adjust your face inside the dots to set up.

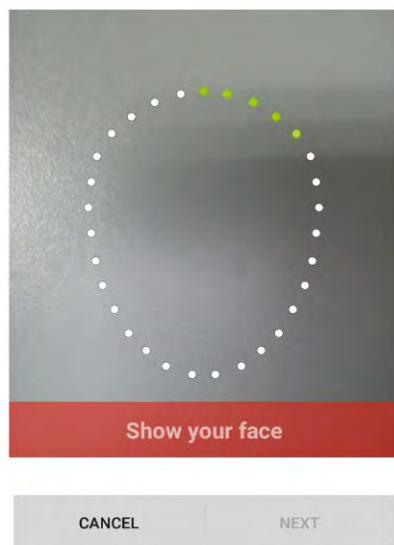

- 2) Turn on the screen and show your face on front camera when you want to unlock.

- **Mobile Security**

If you lost your phone unfortunately, you could control it by remote. A security password and close friend's phone number must be necessary.

Lock the phone

Send a message with "lockphone\*security password" to the lost phone to lock the device thoroughly.

Unlock the phone

Enter the security password for unlocking when you get your lost phone back.

Once SIM card is been changed in your lost phone, the new SIM card number will be auto sent to your close friend's phone immediately.



- **AmiClone**

AmiClone allows data migration from old smartphone to a new one. **Connect** each other to transfer contacts, messages, pictures, music, videos and Apps.

**Settings --> Advanced settings --> Backup & reset --> AmiClone**

- 1) Set up a connection with two smartphones.

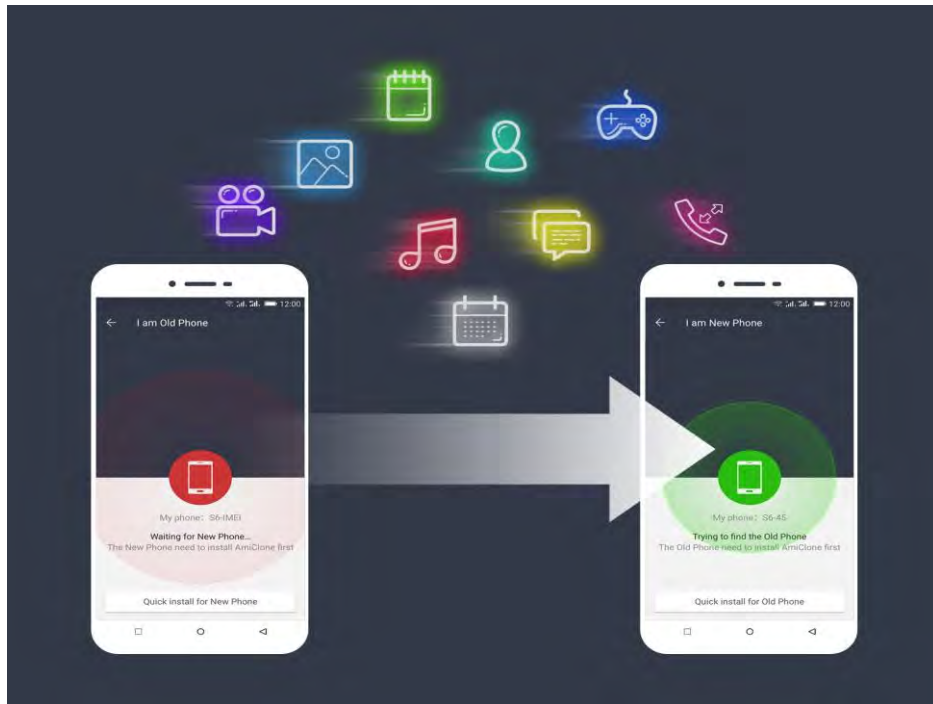

- 2) Select the files which you want to transfer **from old phone to new phone.**

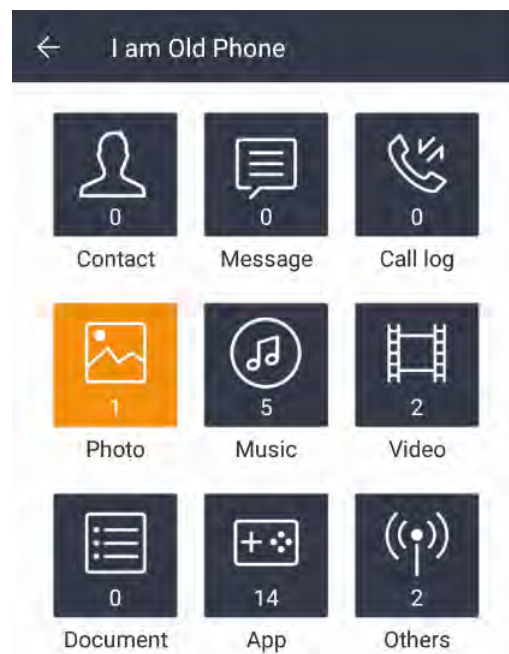

- 3) Receive successfully in the new one.

### **Kids Home**

It's an exclusive place for children. As a parent, you can manage the applications and set

up the daily time with a password.

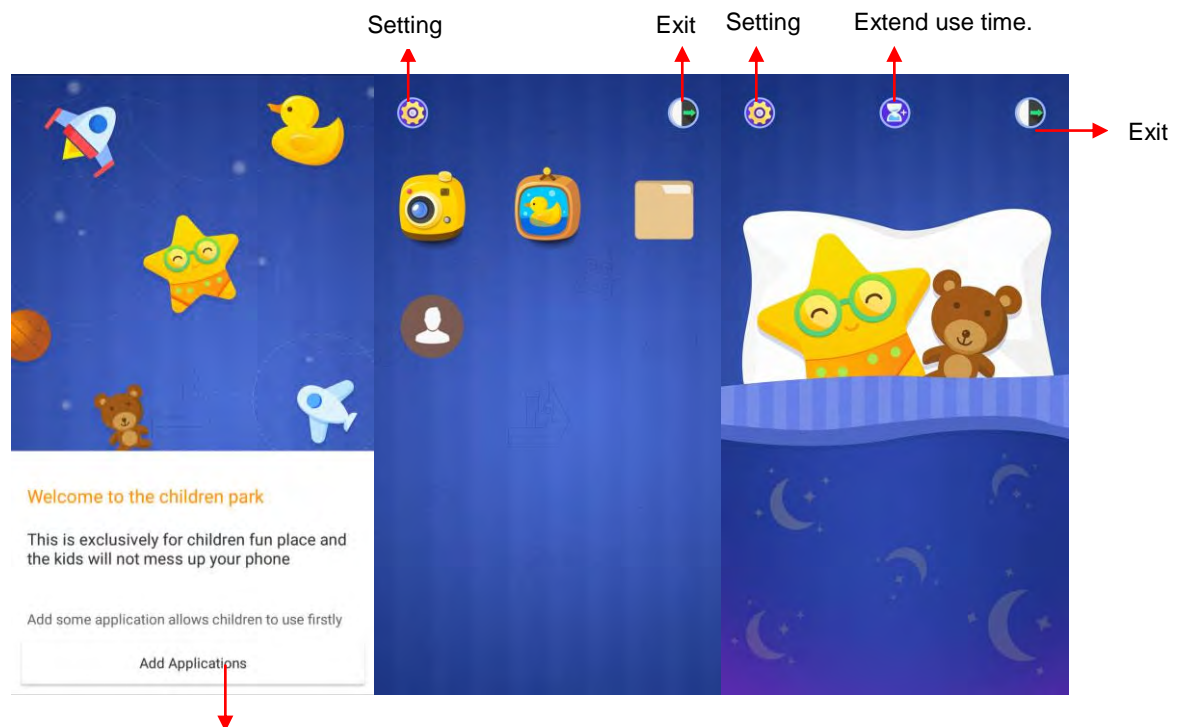

Add Applications for setting up.

## 9. Operation

### Smart gestures

**Settings-->Advanced settings--> Smart gestures** to turn it on.

The smart gestures system supports a variety of experience and control, through gesture can be more convenient operation, some of the smart gesture functions will not work while flip cover is closed.

- Smart dial

**Settings-->Advanced settings --> Smart gestures --> Select Smart dial**

In message content page, contacts detail page or call history details page, dial the number automatically after pick up the phone to your ear.

In contact detail page, directly dial the first number if you have many numbers.

Dual card mobile phone, please set default dial card from Settings-->Dual card settings-->Calls at first.

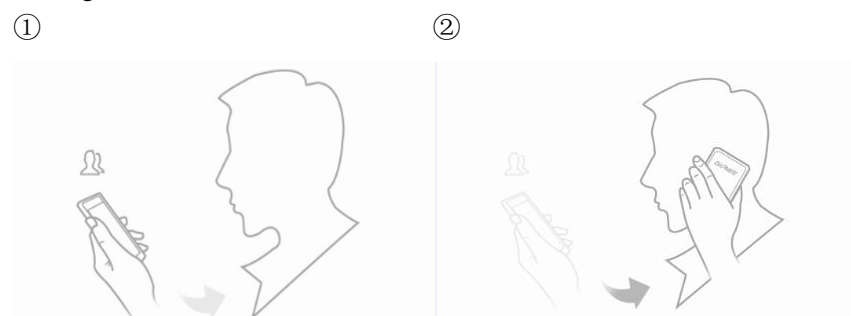

- Smart answer

**Settings--> Advanced settings --> Smart gestures -->Select Smart answer**

Pick up the phone to your ear so it will answer the incoming call automatically.

①

②

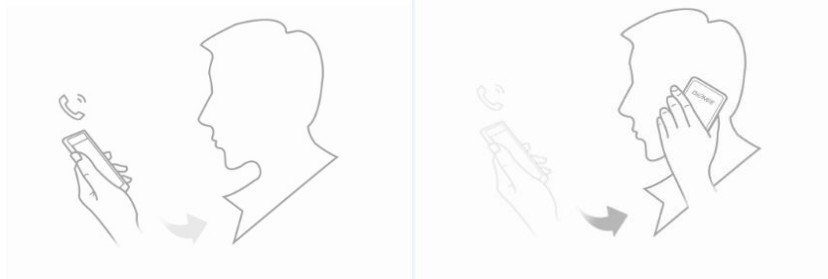

- Pause alarm

**Settings--> Advanced settings--> Smart gestures -->Select Pause alarm**

Flip back the phone to pause the on-going alarm.

①

②

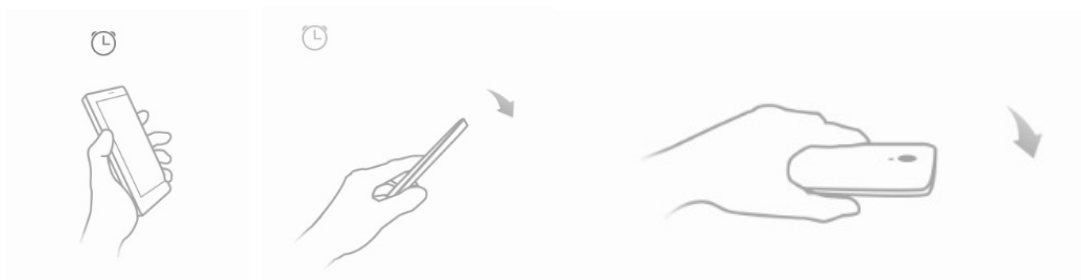

- Black screen gestures

**Settings--> Advanced settings--> Smart gestures --> Select Black screen gestures**

Draw pattern to access menu quickly while phone is on sleep mode.

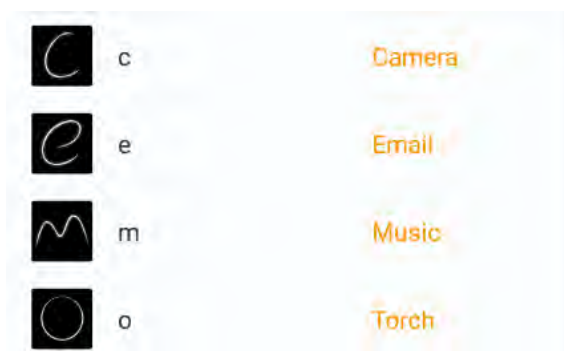

Add a custom gesture

Add a simple graphics or symbols with fewer than three strokes.

- Smart vibration remind

**Settings--> Advanced settings--> Smart gestures -->Select Smart vibration remind**

Phone vibrate to remind the unread message or missed call notification in sleep mode.



①

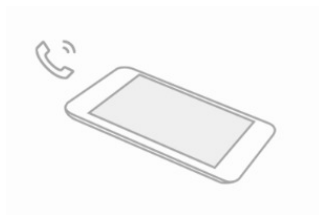

②

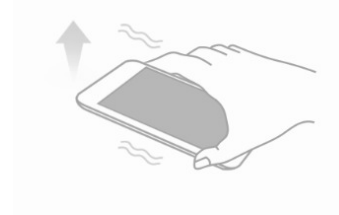

- Smart bright screen

**Settings--> Advanced settings--> Smart gestures-->Select Smart bright screen**

When front camera detects you are viewing screen, the screen can be maintained normally. Enable this function, the status bar will display this icon

The following scenario, the function maybe failure:

- User doesn't face on the screen
- The light is too strong or too dark
- Front camera is used by other applications

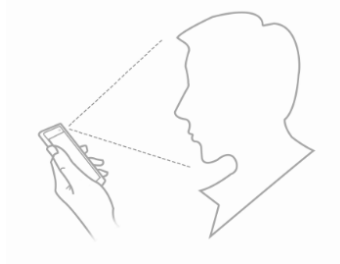

- Double click wake

**Settings--> Advanced settings --> Smart gestures -->Select Double click wake**

In sleep screen, quick double tapping can wake up the mobile phone.

①

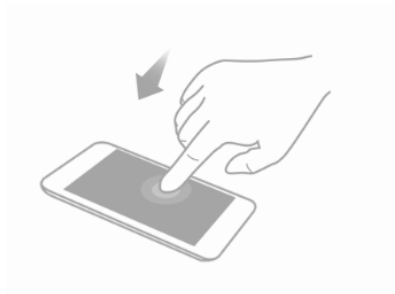

②

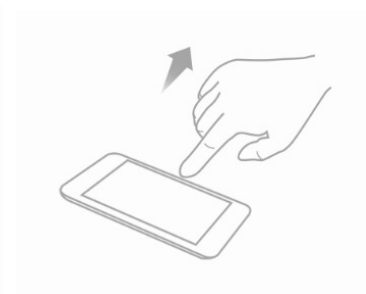

- **Suspend option**

It's a quick access to Options, Home screen, Zoom in the screen and back. Long press can hide it in the notification bar.

**Settings--> Advanced settings--> Suspend option** to turn it on.



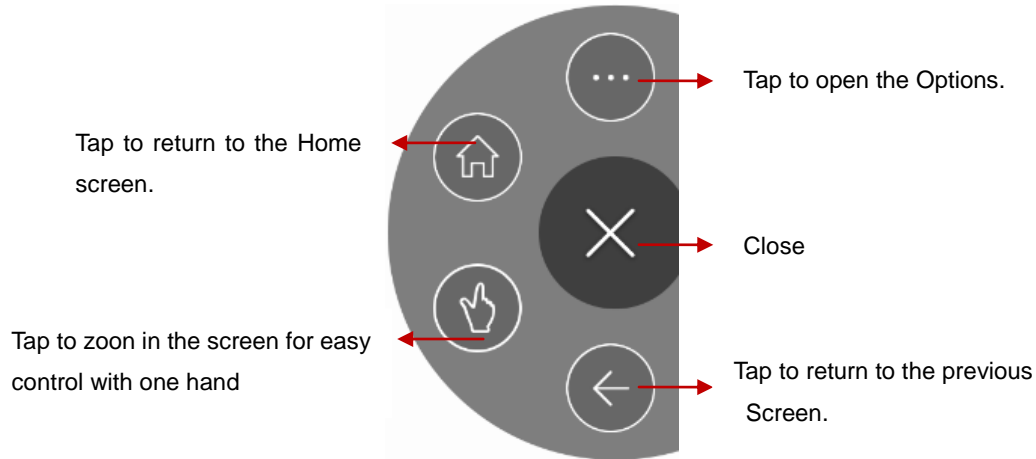

## 10. Health and safety

Please read these simple guidelines. Not following them may be dangerous or illegal.

### **SAR Compliance**

Your phone is designed not to exceed the limits of emission of radio waves recommended by international guidelines.

SAR (specific absorption rate) is the measurement of body-absorbed RF quantity when the phone is in use. SAR value is ascertained according to the highest RF level generated during laboratory tests.

The SAR value of the phone may depend on factors such as proximity to the network tower, use of accessories and other enhancements.

The true SAR level during normal phone usage will be much lower than this level.

The highest SAR value of this device at the head and body are **0.192 W/kg and 0.119W/kg**. Respectively averaged over 1.5cm gap of human tissue.

### **SAR Recommendations**

Use a wireless handsfree system (headphone, headset) with a low power Bluetooth emitter.

Please keep your calls short and use SMS whenever more convenient. This advice applies especially to children, adolescents and pregnant women

Make sure the cell phone has a low SAR.

Prefer to use your cell phone when the signal quality is good.

People having active medical implants should preferably keep the cell phone at least 15 cm away from the implant.

Maintain a preferable distance of 15 mm from the device.

- Safe Driving

Do not use the phone while driving. When you have to use the phone, please use the personal hands-free kit.

Please do not put the phone onto any passenger seat or any place from which it may fall down in case of vehicular collision or emergency braking.

- During Flight

Flight is influenced by interference caused by the phone. It is illegal to use a phone on the airplane. Please turn off your phone during a flight.

- In Hospitals

Your Phone's radio waves may interfere with the functioning of inadequately shielded medical devices. Consult a physician or the manufacturer of the medical device to determine whether they are adequately shielded from external Radio Frequency. Switch off your device when regulations posted instruct you to do so.

To avoid potential interference with implanted medical devices such as a pacemaker or cardioverter defibrillator:

Always keep your phone at least 15.3 centimeters (6 inches) from the medical device.

Do not carry the wireless device in a breast pocket.

Turn off the phone if there is any reason to suspect that interference is taking place.

Follow the manufacturer directions for the implanted medical device.

If you have any questions about using your wireless device with an implanted medical device, consult your health care provider.

- Unsafe Areas

Please turn off your phone when you are close to a gas station or in the vicinity of any place where fuel and chemical preparations, or any other dangerous goods are stored.

## **E-Waste**

### **INFORMATION UNDER E-WASTE (MANAGEMENT AND HANDLING) RULES, 2011**

For disposal of e-waste, please call our helpline no: 1800 208 1166 or visit our website: <http://gionee.co.in/social/>

1. Do's for disposal of product
  - a) Always drop your used electronic products, batteries, and packaging materials after the end of their life in nearest collection point or collection center
  - b) Separate the packaging material according to responsible waste disposal options and sorting for recycling.
  - c) The battery can easily be removed from the product for recycling.
2. Don't for disposal of equipment
  - a) Never dump E-waste in garbage bins or municipal solid waste stream.
  - b) Do not dispose of your product as unsorted municipal waste.
  - c) Do not throw used batteries into household waste.
  - d) Do not dispose damaged or leaking Lithium Ion (Li-Ion) battery with normal household waste.



3. Information on the consequences of improper handling, accidental breakage damage and improper recycling of the end of life product.
  - a) If batteries are not properly disposed of, it can cause harm to human health or the environment.

- b) Placing of batteries or devices on or in heating devices, such as microwave ovens, stoves, or radiators and improper disposal of batteries may lead to explosion.

If the battery terminals are in contact with metal objects, it may cause a fire.

### **Operating Temperature**

The cell phone operating temperature is between 0° and 35° C (32° to 95° F). Low- or high-temperature conditions might cause the cell phone to change its performance.

When using the cell phone, it is normal for it to get warm. The exterior of the cell phone functions as a cooling surface that transfers heat from its inside to the cooler air outside.

## **11. FAQ**

<b>S.No.</b>	<b>FAQ</b>	<b>Answers</b>
1	How to Add or Remove account in Android?	Settings -> Advanced Settings -> Add Accounts a) To add an Account: Add Credential to add account b) To remove an Account: Select account that you need to remove->Option->Remove account
2	How to Factory Reset Android phone?	Settings -> Advanced Settings ->Backup & reset -> Factory data reset ->Confirm restore From there, Select Format Phone storage for best result. <b>Note:</b> Reset Factory default will remove all user data; Make sure to take a backup of your data in PC or on Gmail™.
3	In what scenario does the user have to factory reset Android phone?	In the following scenarios user needs to reset his phone. a) Phone not responding b) Phone automatically Restarting c) Erratic behavior of phone d) Bad Battery backup or charging issues e) Apps not working f) Deleted any pre-installed apps by mistake g) Erased customer data & settings h) To remove an account. <b>Note:</b> If the problem persists, please visit your nearest Service Center.
4	How to connect device via portable hotspot?	Please follow the listed steps. a) Plug in your USB cable and connect it to PC. b) Settings -> More -> Tethering & Portable hotspot-> Select USB tethering. Let it install all the drivers first and after that you will be connected to Internet automatically. Drivers can be downloaded from our Website: <a href="http://gionee.co.in">http://gionee.co.in</a>

5	How to connect your device as USB mass storage?	<p>Please follow the listed steps.</p> <p>a) Plug in USB cable and connect it to PC.</p> <p>b) Select File copy.</p> <p>Let all the drivers install first and then your Device will be connected as a USB Mass Storage. Drivers can be downloaded from our website <a href="http://gionee.co.in">http://gionee.co.in</a>.</p>
6	How to add Data Account or APN settings?	All GiONEE Smart phones come with Pre-loaded Internet Settings. User needs to insert SIM and turn the Data Connectivity On. The phone will automatically detect settings.
7	How to do Data account or APN setting if user has edited or erased pre-installed data settings?	<p>There are two ways to resolve it.</p> <p>a) Do Reset Factory Default Setting.</p> <p>b) Settings-&gt; Mobile Networks-&gt;Access Point Names-&gt; Add new APN / Reset to default.</p>
8	How to select Data mode (Auto or GSM or WCDMA)?	Settings->Mobile Networks->Preferred Networks Type-> Select Mode as per your need from 4G/3G/2G (Auto), 3G/2G, 3G only or 2G only.
9	How to reboot or reset to factory settings?	Power off the phone->Press and Hold Volume up and Power key-> Select the option based on your requirement.
10	How to install applications that are not downloaded on Google Play™ store?	<p>To install applications directly, do following.</p> <p>Settings -&gt; Security -&gt;DEVICE ADMINISTRATION-&gt; Select unknown sources.</p>
11	How to backup contacts and SMS?	<p>(a) For Contact Backup</p> <p>(i) User can take backup on Gmail</p> <p>(ii) Contact-&gt; More-&gt;Import/Export -&gt; Select Source &amp; Destination point to take back-up.</p> <p>(b) For SMS Backup</p> <p>(i) User can take backup on Gmail</p> <p>(ii) Messaging -&gt; More-&gt; Import/Export SMS-&gt; Import SMS Backup from storage or Export SMS to storage.</p> <p>On a device running Android User can take backup of Contacts, SMS, Call log, Calendar with following steps.</p> <p>Settings -&gt; Advanced settings -&gt; Backup &amp; reset -&gt;System Backup and restore -&gt; Backup to storage</p>

12	Why the actual capacity may differ from the one mentioned on product label?	A certain portion of capacity of ROM may be used for system files and maintenance, thus actual capacity may differ from that indicated on the product label.
----	---	--

## COPYRIGHT

All rights reserved. Reproduction, transfer, distribution or storage of part or all of the contents in this document in any form without the prior written permission of GIONEE is strictly prohibited.

Android, Google, Google Play, and other marks are trademarks of Google Inc.

## FCC Regulations:

This mobile phone complies with part 15 of the FCC Rules. Operation is subject to the following two conditions: (1) This device may not cause harmful interference, and (2) this device must accept any interference received, including interference that may cause undesired operation.

This mobile phone has been tested and found to comply with the limits for a Class B digital device, pursuant to Part 15 of the FCC Rules. These limits are designed to provide reasonable protection against harmful interference in a residential installation. This equipment generates, uses and can radiated radio frequency energy and, if not installed and used in accordance with the instructions, may cause harmful interference to radio communications. However, there is no guarantee that interference will not occur in a particular installation. If this equipment does cause harmful interference to radio or television reception, which can be determined by turning the equipment off and on, the user is encouraged to try to correct the interference by one or more of the following measures:

- Reorient or relocate the receiving antenna.
- Increase the separation between the equipment and receiver.
- Connect the equipment into an outlet on a circuit different from that to which the receiver is connected.
- Consult the dealer or an experienced radio/TV technician for help.

FCC Note:

Caution: Changes or modifications not expressly approved by the party responsible for compliance could void the user's authority to operate the equipment.

## RF Exposure Information (SAR)

This phone is designed and manufactured not to exceed the emission limits for exposure to radio frequency (RF) energy set by the Federal Communications Commission of the United States.

During SAR testing, this device was set to transmit at its highest certified power level in all tested frequency bands, and placed in positions that simulate RF exposure in usage against the head with no separation, and near the body with the separation of 10 mm. Although the SAR is determined at the highest certified power level, the actual SAR level of the device while operating can be well below the maximum value. This is because the phone is designed to operate at multiple power levels so as to use only the power required to reach the network. In general, the closer you are to a wireless base station antenna, the lower the power output.

The exposure standard for wireless devices employing a unit of measurement is known as the Specific Absorption Rate, or SAR.

The SAR limit set by the FCC is 1.6W/kg.

This device is complied with SAR for general population /uncontrolled exposure limits in ANSI/IEEE C95.1-1992 and had been tested in accordance with the measurement methods and procedures specified in IEEE1528.

The FCC has granted an Equipment Authorization for this model phone with all reported SAR levels evaluated as in compliance with the FCC RF exposure guidelines. SAR information on this model phone is on file with the FCC and can be found under the Display Grant section of [www.fcc.gov/oet/ea/fccid](http://www.fcc.gov/oet/ea/fccid) after searching on FCC ID: 2AFWFS6.

For this device, the highest reported SAR value for usage against the head is 0.95 W/kg, for usage near the body is 1.16 W/kg.

While there may be differences between the SAR levels of various phones and at various positions, they all meet the government requirements.

SAR compliance for body-worn operation is based on a separation distance of 10 mm between the unit and the human body. Carry this device at least 10 mm away from your body to ensure RF exposure level compliant or lower to the reported level. To support body-worn operation, choose the belt clips or holsters, which do not contain metallic components, to maintain a separation of 10 mm between this device and your body. RF exposure compliance with any body-worn accessory, which contains metal, was not tested and certified, and use such body-worn accessory should be avoided.