



# Lenovo PHAB

## Safety, Warranty & Quick Start Guide

Lenovo PB1-750M

## English

 Read this guide carefully before using your Lenovo PHAB.

## Read before using your Lenovo PHAB

### Read first-Regulatory information

Device models equipped with wireless communications comply with the radio frequency and safety standards of any country or region in which it has been approved for wireless use. In addition, if your product contains a telecom modem, it complies with the requirements for connection to the telephone network in your country.

Be sure to read the *Regulatory Notice* for your country or region before using the wireless devices contained in your device. To obtain a PDF version of the *Regulatory Notice*, refer to the “Downloading publications” section below.

### Getting support

To get support on network service and billing, contact your wireless network operator. To learn how to use your device and view its technical specifications, go to <http://support.lenovo.com>

### Downloading publications

Electronic versions of your publications are available from <http://support.lenovo.com>. To download the publications for your device, go to <http://support.lenovo.com> and follow the instructions on the screen.

### Accessing your User Guide

Your User Guide contains detailed information about your device. To access your User Guide, go to <http://support.lenovo.com> and follow the instructions on the screen.

### Legal notices

Lenovo and the Lenovo logo are trademarks of Lenovo in the United States, other countries, or both.

Other company, product, or service names may be trademarks or service marks of others.

Manufactured under license from Dolby Laboratories. Dolby, Dolby Atmos, and the double-D symbol are trademarks of Dolby Laboratories.

LIMITED AND RESTRICTED RIGHTS NOTICE: If data or software is delivered pursuant to a General Services Administration “GSA” contract, use, reproduction, or disclosure is subject to restrictions set forth in Contract No. GS-35F-05925.

## Contents

|  |   |
|--|---|
| Lenovo PHAB overview .....                               | 1 |
| Preparing your Lenovo PHAB .....                         | 2 |
| Starting to use your Lenovo PHAB .....                   | 3 |
| Important safety and handling information .....          | 4 |
| European Union Compliance Statement .....                | 5 |
| RF Exposure (SAR) information: .....                     | 5 |
| Service and Support information.....                     | 5 |
| Warranty information .....                               | 6 |
| Environmental, recycling, and disposal information ..... | 8 |

# Lenovo PHAB overview

| Model           | Version          |
|-----------------|------------------|
| Lenovo PB1-750M | WLAN+LTE (Voice) |

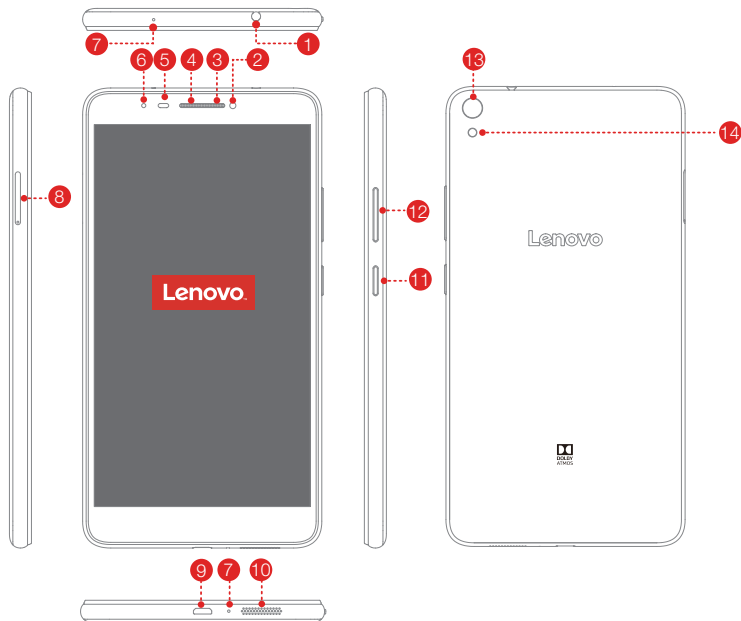

- |                 |                          |   |
|-----------------|--------------------------|---|
| 1 Earphone jack | 2 Front camera           | 3 Microphone<br>(inside the receiver cover) |
| 4 Receiver      | 5 Light/Proximity sensor | 6 Indicator light                           |
| 7 Microphone    | 8 Card slot              | 9 Micro USB connector                       |
| 10 Speaker      | 11 On/Off button         | 12 Volume button                            |
| 13 Rear camera  | 14 Flash light           |   |

## Preparing your Lenovo PHAB

A Micro SIM card provided by your carrier is required in order to use cellular services.

A microSD card is required to store data.

Install the Micro SIM cards and the microSD card as shown.

**Step 1.** Insert the eject tool that comes with your device into the hole in the card tray.

**Step 2.** Pull out the card tray and do one of the following:

- Position the SIM1 card in Slot1 and the SIM2 card in Slot2, or position the SIM1 card in Slot1 and the microSD card in Slot2.
- Both of the card slots support 4G/3G/2G data services, but you can enable only one Micro SIM card for data connection at a time. If you want to change the Micro SIM card used for data connection, go to Settings > SIM Cards > Cellular Data.

**Step 3.** Carefully insert the tray with the installed cards back into the slot.

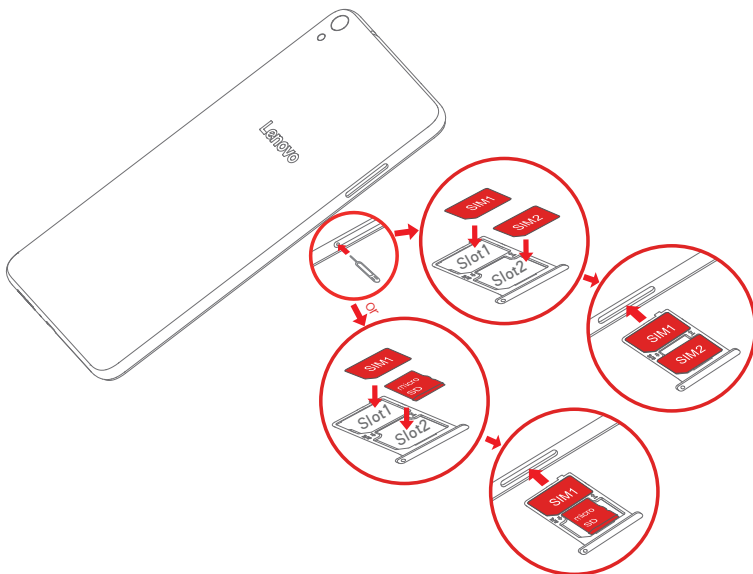

# Starting to use your Lenovo PHAB

Before using your device, you might need to charge the battery.  
Charge the battery as shown.

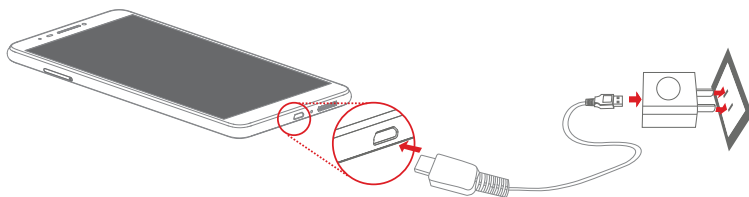

Connect your device to a power outlet using the included cable and USB power adapter.

 Low battery

 Fully charged

 Charging

## Turning on/off

---

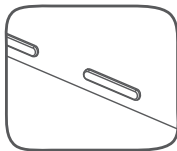

**Turn on:** Press and hold the On/Off button until the Lenovo logo appears.

**Turn off:** Press and hold the On/Off button for a few seconds, then tap **Power off**.

**Restart:** Press and hold the On/Off button for about 10 seconds.

## Taking screenshots

---

Press and hold the On/Off button and the volume down button at the same time.

# Important safety and handling information

## Plastic bag notice

**DANGER:** Plastic bags can be dangerous. Keep plastic bags away from babies and children to avoid danger of suffocation.

## Built-in rechargeable battery notice

**DANGER:** Do not attempt to replace the internal rechargeable lithium ion battery. Risk of explosion if the battery is replaced with an incorrect type. Contact Lenovo Support for factory replacement.

## Polyvinyl Chloride (PVC) cable and cord notice

**WARNING:** Handling the cord on this product or cords associated with accessories sold with this product will expose you to lead, a chemical known to the State of California to cause cancer, and birth defects or other reproductive harm. Wash hands after handling.

## Prevent hearing damage

Your device has a headphone connector. Always use the headphone connector for headphones (also called a headset) or earphones.

**CAUTION: Excessive sound pressure from earphones and headphones can cause hearing loss. Adjustment of the equalizer to maximum increases the earphone and headphone output voltage and the sound pressure level. Therefore, to protect your hearing, adjust the equalizer to an appropriate level.**

Excessive use of headphones or earphones for a long period of time at high volume can be dangerous if the output of the headphone or earphone connectors do not comply with specifications of EN 50332-2.

The headphone output connector of your device complies with EN 50332-2 Sub clause 7. This specification limits the device's maximum wide band true RMS output voltage to 150 mV. To help protect against hearing loss, ensure that the headphones or earphones you use also comply with EN 50332-2 (Clause 7 limits) for a wide band characteristic voltage of 75 mV. Using headphones that do not comply with EN 50332-2 can be dangerous due to excessive sound pressure levels.

If your device came with headphones or earphones in the package, as a set, the combination of the headphones or earphones and the device already complies with the specifications of EN 50332-1. If different headphones or earphones are used, ensure that they comply with EN 50332-1 (Clause 6.5 Limitation Values). Using headphones that do not comply with EN 50332-1 can be dangerous due to excessive sound pressure levels.

## Sound pressure warning statement

For the device that is tested in accordance with EN 60950-1: 2006+A11:2009+A1:2010+A12:2011, it is mandatory to perform audio tests for EN50332.

This device has been tested to comply with the Sound Pressure Level requirement laid down in the applicable EN 50332-1 and/or EN 50332-2 standards. Permanent hearing loss may occur if earphones or headphones are used at high volume for prolonged periods of time.



Warning statement: To prevent possible hearing damage, do not listen at high volume levels for a long period of time.

## European Union Compliance Statement

Radio and Telecommunications Terminal Equipment Directive



Lenovo declares that this product is in compliance with:

- The essential requirements and other relevant provisions of the Radio and Telecommunications Terminal Equipment Directive, 1999/5/EC
- All other relevant EU directives

The Declaration of Conformity information is located in the *Regulatory Notice* To obtain a PDF version of the *Regulatory Notice*, go to <http://support.lenovo.com>.

## Service and Support information

The following information describes the technical support that is available for your product, during the warranty period or throughout the life of your product. Refer to the *Lenovo Limited Warranty* for a full explanation of Lenovo warranty terms. See “Lenovo Limited Warranty notice” later in this document for details on accessing the full warranty.