



# Lenovo P70

## Quick Start Guide v1.0



Read this guide carefully before using your smartphone.

# Technical specifications



## Model and system

Model: Lenovo P70-A

System: Android



## ①Dimensions and weight

Height: 142 mm (5.59 inches)

Width: 71.8 mm (2.83 inches)

Depth: 8.9 mm (0.35 inch)

Weight: 149 g (0.328 lb)



## Processor

Processor: MTK MT6752, Octa Core, 1.7 GHz



## Camera

Type: CMOS

Pixels: 13.0 megapixels (back) + 5.0 megapixels (front)



## Battery

Battery: 4000 mAh



## Display

Size: 5.0 inches

Screen: multi-touch

Resolution: 1280 × 720 pixels

LCD type: IPS



## Wireless Communication

Bluetooth 4.0; WLAN 802.11 b/g/n; ②LTE, WCDMA, GSM; GPS



① Depending on the measuring method, the dimensions and weight might vary slightly.

② In some countries, LTE is not supported. To know if your smartphone works with LTE networks in your country, contact your carrier.

# First glance

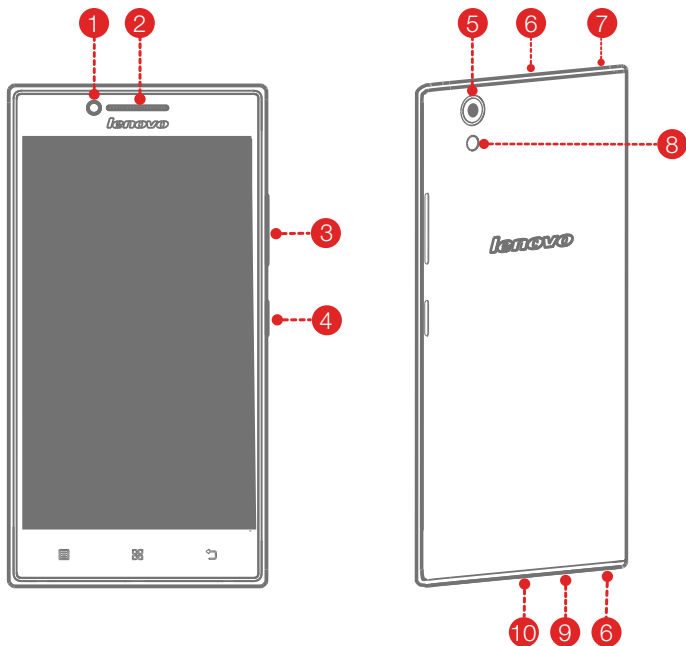

1 Front-facing camera

4 On/Off button

7 Headset connector

10 Micro USB connector

2 Receiver

5 Rear-facing camera

8 Flashlight

3 Volume buttons

6 Microphone

9 Speaker

# Preparing your smartphone

You must insert the SIM card provided by your carrier to use cellular services. Set up your smartphone as shown.

**Step 1.** Open the back cover.

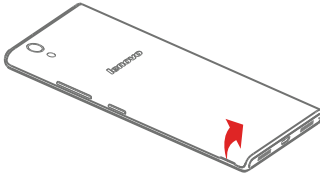

**Tip:** The battery is unremovable, and is fixed to the phone. Please do not pull the battery, otherwise it will damage the phone.

**Step 2.** Insert the (U)SIM cards.

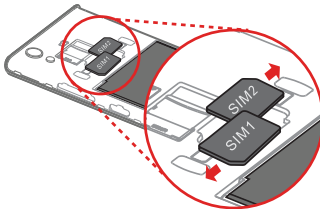

**Tip:** Insert the (U)SIM card into SIM1 slot and SIM card into SIM2 slot.

**Step 3.** Insert the memory card.

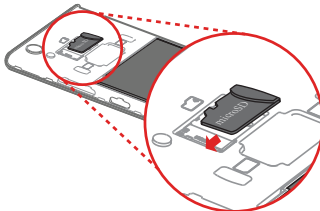

**Step 4.** Install the back cover.



 Always turn off your smartphone first before you insert or remove a SIM card. Insert or remove a SIM card with your smartphone on may damage your SIM card or smartphone permanently.

# Charging the battery

Charge the battery as shown.

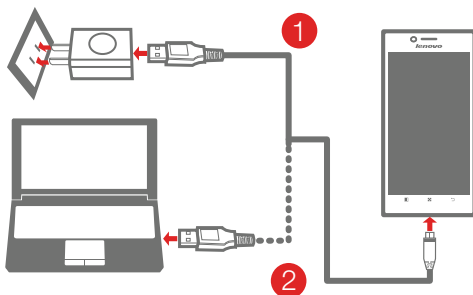

**Method 1.** Connect your smartphone to a power outlet using the cable and USB power adapter that come with your smartphone.

**Method 2.** Connect your smartphone to a computer using the cable that comes with your smartphone.

 Low battery power

 Fully charged

 Charging

## Turning on or turning off your smartphone

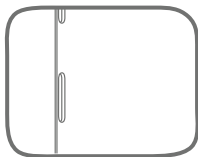

**Turn on:** Press and hold the On/Off button until the Lenovo logo appears.

**Turn off:** Press and hold the On/Off button for a few seconds, then tap **Power off**.

-  Your smartphone has a rechargeable battery. For more information about battery safety, see the “Rechargeable battery notice” in the *Important Product Information Guide* shipped with your smartphone.

## Learning more

To learn more information about your Lenovo smartphone and obtain the latest smartphone manuals, go to:  
<http://support.lenovo.com/>.

### Getting support

For support on network service and billing, contact your wireless network operator. For instructions on how to use your device, go to: <http://support.lenovo.com/>.

### European Union conformity



### Radio and Telecommunications Terminal Equipment Directive

This product is in compliance with the essential requirements and other relevant provisions of the Radio and Telecommunications Terminal Equipment Directive, 1999/5/EC.

### Legal notices

Lenovo and the Lenovo logo are trademarks of Lenovo in the United States, other countries, or both.  
Other company, product, or service names may be trademarks or service marks of others.

First Edition (January 2015) © Copyright Lenovo 2015.

**Reduce | Reuse | Recycle**



HQ60111378000

Printed in China