

# tecmobile® | R50 User Manual Dual SIM

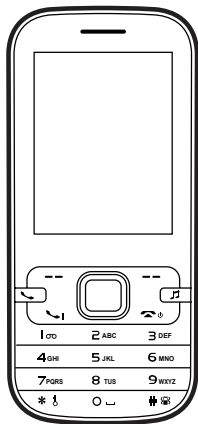

# Contents

<b>1) Introduction</b>	<b>4</b>	<b>4) Messages</b>	<b>14</b>
1.1) Overview	4	4.1) SMS Settings	14
1.2) Box Contents	5	4.2) MMS Settings	14
1.3) Button Functions	6	4.3) Composing a SMS	15
<b>2) Getting Started</b>	<b>8</b>	4.4) Composing a MMS	15
2.1) Installing the Battery, SIM Card and Memory Card	8	4.5) Save the Information as a Draft	16
2.2) Charging the Battery	11	4.6) Reading and Replying to a Message	16
2.3) Powering ON/OFF	12	4.7) Forwarding Messages	17
<b>3) Making Phone Calls</b>	<b>13</b>	4.8) Deleting Messages	17
3.1) Making a Call Using the Keypad	13	<b>5) Profiles</b>	<b>18</b>
3.2) Making a Call from Contacts	13	<b>6) Phone Settings</b>	<b>20</b>
3.3) Answering a Call	13	6.1) Menu Settings	20
3.4) Adjusting the Volume	13	6.2) Call Settings	20
		6.3) Phone Settings	23
		6.4) Display Settings	24
		6.5) Security Settings	24
		6.6) Management	26

<b>7) Managing Contacts</b>	<b>27</b>	<b>10) Audio Player</b>	<b>36</b>
7.1) Creating Contacts	27		
7.2) Editing Contacts	28	<b>11) Camera</b>	<b>37</b>
7.3) Searching for a Contact	28		
7.4) Deleting a Contact	29	<b>12) Tools</b>	<b>38</b>
		12.1) Alarm	38
<b>8) Using Bluetooth</b>	<b>30</b>	12.2) Calendar	39
8.1) Turning ON Bluetooth and making your phone Visible (Discoverable)	30	12.3) eBook	40
8.2) Pairing with a Bluetooth Device	30	12.4) Calculator	40
8.3) Un-Pairing a Bluetooth Device	31		
8.4) Sending and Receiving Files	31	<b>13) File Manager</b>	<b>41</b>
<b>9) Multimedia</b>	<b>32</b>	<b>14) Internet</b>	<b>42</b>
9.1) Video Recorder	32	14.1) Internet Service	42
9.2) Video Player	32	14.2) APN Settings	43
9.3) Image Browser	32	<b>15) Legal Information</b>	<b>44</b>
9.4) Recorder	33		
9.5) FM Radio	34	<b>16) Health and Safety</b>	<b>48</b>
		<b>17) Declaration of Conformity</b>	<b>55</b>

# 1) Introduction

## 1.1) Overview

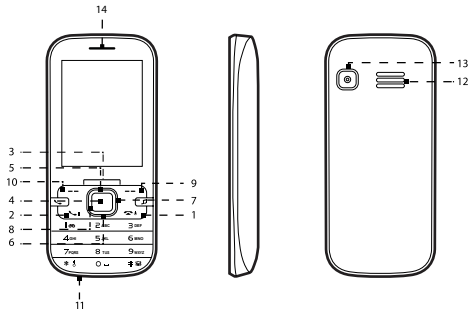

- |   |                         |
|---|-------------------------|
| 1 | Power ON/OFF/End button |
| 2 | Send button             |
| 3 | Navigation button       |
| 4 | OK button               |
| 5 | Up button               |
| 6 | Down button             |
| 7 | Right button            |

- |    |                              |
|----|------------------------------|
| 8  | Left button                  |
| 9  | Right soft button            |
| 10 | Left soft button             |
| 11 | Mini USB/ Audio/Charger jack |
| 12 | Speaker                      |
| 13 | Camera                       |
| 14 | Earpiece                     |

## **1.2) Box Contents**

Please check the box includes the following components. If there are any items missing please contact your supplier.

- Handset
- Headset
- Power Adaptor
- Data Cable
- Quick Start-Up Guide

## **1.3) Button Functions**

### **Power ON/OFF/End Button**

- When the phone is OFF, press to turn ON the phone.
- When the phone is ON and the screen is unlocked, press to turn OFF the phone.

### **Navigation Button**

#### **Up Button**

- During an active call, press to increase the volume on the earpiece.
- When not on a call, press to go to shortcuts.
- Whilst listening to the FM radio, press to increase the volume.
- Use this button to navigate the Main menu.

#### **Down Button**

- During an active call, press to decrease the volume on the earpiece.
- When not on a call, press to go to alarm.
- Whilst listening to the FM radio, press to decrease the volume.
- Use this button to navigate the Main menu.

### **Left Button**

- In standby mode use this button to go to sounds.
- Whilst listening to the FM radio, press to search for a lower radio frequency.
- Use this button to navigate the Main menu.

### **Right Button**

- In standby mode use this button to add a new contact.
- Whilst listening to the FM radio, press to search for a higher radio frequency.
- Use this button to navigate the Main menu.

### **Right Soft Button**

- Press the **Right Soft button** to select the corresponding function on the bottom right hand side on the screen.

### **Left Soft Button**

- Press the **Left Soft button** to select the corresponding function on the bottom left hand side on the screen.

## 2) Getting Started

### 2.1) Installing the Battery, SIM Card and Memory Card

Your phone comes with a rechargeable Lithium-ion battery and is designed to use only manufacturer-specified original batteries and accessories. Battery performance depends on many factors, including network configuration, signal strength, the temperature of the environment in which you operate your phone, the features and/or settings you select and use, items attached to connecting ports, your voice, data, and other program usage patterns.

#### Installing the Battery and SIM card.

1. Make sure that your mobile phone is powered OFF.
2. Remove the back cover.
3. Pull the battery up and remove it from the mobile phone.

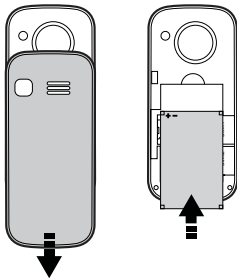



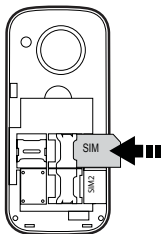

4. Slot the SIM card into place.  
Always ensure the SIM card is  
inserted correctly before replacing  
the battery.

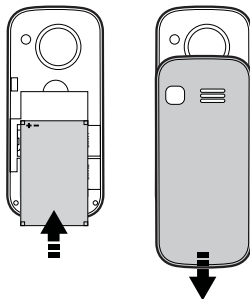

5. Replace the battery into position  
and slide the back cover into place  
until you hear a click.

## Installing the Micro SD Memory Card.

1. Make sure that your mobile phone is powered OFF.
2. Remove the back cover.
3. Pull the battery up and remove it from the mobile phone.
4. Slide the micro SD card holder to the **Open** position and flip the holder upwards.
5. Insert the memory card into the holder and click it back into place.
6. Slide the holder to the **Lock** position to secure it into place.
7. Insert the battery and the back cover.

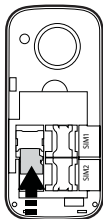

## **2.2) Charging the Battery**

Only use the power adaptor and USB data cable provided in this pack to charge your phone. There are 2 methods for charging the battery.

### **Charging the battery with the Power Adaptor and USB data cable.**

1. Install the battery correctly in the phone.
2. Connect one end of the USB data cable into the charger port on the phone.
3. Attach the other end to the Power adaptor.
4. Connect the adaptor to a standard AC wall outlet.
5. When charging is complete, unplug the adaptor from the AC wall outlet and disconnect the cable from the phone.

### **Charging the battery with a computer and USB data cable.**

1. Connect the mini USB end of the data cable into the charging port on the phone.
2. Attach the USB end of the data cable to the USB port on the computer.
3. When charging is complete, disconnect the cables from the handset and computer.

## 2.3) Powering ON/OFF

Ensure the SIM card and battery have been inserted correctly into your phone before attempting to power ON.

Press and hold the **Power ON/OFF/End** button for 3 seconds to power ON/OFF your phone.

## 3) Making Phone Calls

### 3.1) Making a Call Using the Keypad

1. In Standby mode, input the contact number on the keypad.
2. Press the **Send button** to make a call.
3. Press the **Power ON/OFF/End button** to terminate a call.

### 3.2) Making a Call from Contacts

1. In Standby mode, press **Left Soft button** to access the **Menu**.
2. Use the Navigation button to select **Contact** and scroll through the **Contact List**.
3. Choose your contact and press the **Send button** to make the call.

### 3.3) Answering a Call

When there is an incoming call, the phone will display the information on the screen.

Press the **Send button** to answer the call.

Press the **Power ON/OFF/End button** to terminate or reject the call.

### 3.4) Adjusting the Volume

In an active call press the **Up/ Down button** on the Navigation button to increase or decrease the volume.

## 4) Messages

### 4.1) SMS Settings

1. In the Standby mode, press the **Left Soft button** to access the **Main menu**.
2. Use the Navigation button to select **Messages > Options > Settings > SMS** to access the submenu.

**SIM1 msg centre:** Edit and save SIM1 message centre number.

**SIM2 msg centre:** Edit and save SIM2 message centre number.

**Message validity period:** Period which a message will stay on your SMS centre if not sent because the recipient was offline.

**Status report:** Enable this option to know when the recipient receives your message.

**Save sent messages:** Enables you to save your sent messages.

**Preferred storage:** Enables you to save the SMS to the SIM card or to the phone.

**SMS backup:** Backup messages from your phone into your SD memory card or from your SD memory card to your phone (Import or Export).

### 4.2) MMS Settings

1. In the Standby mode, press the **Left Soft button** to access the **Main menu**.
2. Use the Navigation button to select **Messages > Options > Settings > MMS** to access the submenu.
3. Edit the following submenu to set your MMS settings:

**SIM1 MMS account:** Set to **Automatic**, to enable your 3G/EDGE connection through your data plan. Contact your network operator for more information.

**SIM2 MMS account:** Set to **Automatic**, to enable your 3G/EDGE connection through your data plan. Contact your network operator for more information.

**Send options:** Set your delivery reports and MMS sending options.

**Receive options:** Set your arrival reports and MMS receipt options.

**Play audio:** Select your desired storage location for **pictures, music or video files** received via MMS.

**Restore default:** View the storage capacity remaining or used.

#### **4.3) Composing a SMS**

1. In Standby mode, press the **Left Soft button** to access the **Main menu**.
2. Use the Navigation button to select **Messages > Write message > New SMS**.
3. Type your message.
4. **Enter a contact number** or select the desired recipient from the **Contact List**.

#### **4.4) Composing a MMS**

1. In the Standby mode, press the **Left Soft button** to access the **Main menu**.
2. Use the Navigation button to select **Messages > Write message > New MMS**.
3. Insert recipient, subject, type your message and add an attachment.
4. Select **Options > Send**.

#### 4.5) Save the Information as a Draft

When composing a message, the MMS or SMS can be saved to the **Draft box** by pressing **Power On/OFF/End button** or going to **Options** and select **Save to Drafts**.

To edit the message

1. In Standby mode, press the **Left Soft button** to access the **Main menu**.
2. Use the Navigation button to select **Messages > Draft**.
3. Highlight the desired message to edit and press the **OK button**.
4. Edit your message and select **Options > Send**.
5. Enter a contact number or select the desired recipient from the **Contact List** to send the message.

#### 4.6) Reading and Replying to a Message

The phone will display an icon on the screen to notify you of a **New Message** received. Press the **Left Soft button** to View the message.



#### 4.7) Forwarding Messages

1. In the Standby mode, press the **Left Soft button** to access the **Main menu**.
2. Select **Messages** and go to the message you want to forward.
3. Select **Options > Forward**.
4. Edit your message and select **Options > Send To** or press the **OK button**.
5. Enter a contact number or select the desired recipient from the **Contact List** to send the message to.

#### 4.8) Deleting Messages

1. In Standby mode, press the **Left Soft button** to access the **Main menu**.
2. Use the Navigation button to select **Messages > Inbox**.
3. Open the desired message and select **Options > Delete** to remove the message

## 5) Profiles

By setting your profile you can customise ring settings, volume, call alerts, message alerts, alarm and calendar reminders, key tones, battery low alert and power ringtone.

You can choose between various profile modes:

**General, Silent, Vibrate, Indoor, Outdoor and Earphone.**

1. In standby mode, press the **Left soft key** button to access the **Main menu**.
2. Use the Navigation button to go to **Profile**.
3. Choose and edit the desired profile:

**General/ Silent/ Vibrate/ Indoor/ Outdoor/ Earphone**

4. Press the **Left soft button** to see the available options: **Activate, Customise and Rename**.
5. Choose **Customise** to edit your profile and make the desired changes on the following settings:

**Ring settings:** Select the desired call and message ringtones from Fixed tones or from your memory card.

**Adjust volume:** Choose and adjust the volume for all your alerts.

**Call alert:** Select the desired alert for your incoming calls: Ringtone, Vibrate, Silent, Vibrate then ring or Ring and vibrate.

**Message alert:** Select the desired alert for your messages: Ringtone, Vibrate, Silent or Ring and vibrate.

**Alarm & calendar reminder:** Select alarm options and calendar reminders.

**Key tone:** Enable or disable the sound on your keypad.

**Battery low alert:** Activate an alert for when your battery is running low.

**Power ringtone:** Enable or disable a ringtone for when powering ON/OFF your phone.

## 6) Phone Settings

### 6.1) Menu Settings

1. In Standby mode, press the **Left Soft button** to access the **Main menu**.
2. Use the Navigation button to select **Settings** to access the submenu to display the list of options to change your phone settings.

### 6.2) Call Settings

1. In Standby mode press **Left Soft Button** to access the **Main menu**.
2. Use the Navigation button to select **Settings > Call settings**.
3. Edit the following fields to change your call settings:

**Dual-SIM:** Select SIM card to be used and set a preferred name for each of your SIM cards. You can also activate a feature that enables you to reply to a message with the SIM which received the message or call (**Reply by original SIM**).

**Network selection:** Select preferred network, this can be done manually or automatically.

**Call divert:** Edit divert call options for each of your SIM cards.

**Divert all calls:** Diverts all calls to your voicemail or another pre-set number.

**Divert if busy:** Diverts all calls to your voicemail or another pre-set number during an active call.

**Divert if no answer:** Diverts all calls to your voicemail or another pre-set number if the incoming call is not answered.

**Divert if unreachable:** Diverts all calls to your voicemail or another pre-set number if you are outside a network coverage area or if the phone is powered off.

**Cancel all diverts:** All call diverts will be cancelled.

**Call barring:** Edit barring call options for each of your SIM cards.

**All outgoing calls:** Activate this function to block all your outgoing voice calls.

**All incoming call:** Activate this function to block all your incoming voice calls.

**Incoming calls when roaming:** Activate this function to block all your incoming roaming calls.

**ISD calling:** Block all the international calls on your phone.

**Dial when INTL roaming:** Block all calls when you are abroad, using international roaming service.

**Cancel all barring:** Cancel all call barring features. You will be required to input a password to enable or disable this function.

**Change password:** Change your call barring password. You need to contact your network operator to get your password.

**Call waiting:** During an active call this feature will allow the network to alert you when there is another incoming call. You can answer the incoming call whilst putting the current call on hold or have the option to reject the call.

**Hide ID:** This feature allows you to hide your ID for your outgoing calls.

**Select line:** This setting (network service) is shown only if the SIM card supports two subscriber numbers, that is, two phone lines. Select which phone line you want to use for making calls and sending text messages. Calls on both lines can be answered irrespective of the selected line. If you select Line 2 and have not subscribed to this network service, you are not able to make calls.

**Flight mode:** Enable or disable the flight mode on your phone. You cannot make/receive calls or send/receive messages when in flight mode.

#### **Others:**

**50 secs warning:** There will be a warning sound on the first 50 seconds of an active call.

**Vibration when connected:** The phone will vibrate when the recipient answers your voice call.

**Answer/Reject mode:** There are two functions that can be activated: “Reply SMS after reject” which means after rejecting a call your phone will send an SMS to the person who tried to call you, and “Any-key answer” which means that you can answer an incoming call with any key on your phone’s keypad.

**Auto redial:** When auto redial is enabled, if a call does not connect your phone will automatically redial within a set interval.

### **6.3) Phone Settings**

1. In Standby mode press **Left Soft button** to access the **Main menu**.
2. Use the Navigation button to select **Settings > Phone Settings**.
3. Edit the following to set your phone settings:

**Time & Date:** Allow you to set your local time and date and format to be displayed.

**Set language:** Sets the language on your phone.

**Shortcut settings:** Assign different functions for the Navigation button.

**Auto power ON/OFF:** Set preferred times to automatically switch your handset ON and OFF.

**Power management:** Allows you to check how much battery you have got left.

**Restore factory settings:** Restore all the settings in your phone to factory mode.

Note: Your saved data will be deleted after restoring.

## 6.4) Display Settings

Enables you to set the brightness of the screen, associated screen and keypad backlight delay as well as select your wallpaper and the Power ON/OFF animation.

## 6.5) Security Settings

### Using a PIN code to protect your SIM card

You can specify a Personal Identification Number (PIN) to protect the SIM card from unauthorised use.

1. In Standby mode press **Left Soft button** to access the **Main menu**.
2. Use the Navigation button to select **Settings > Security settings** to access the submenu.
3. Select **PIN** or **PIN2** to set the PIN code, or change the PIN and PIN2 settings.

Note: Emergency calls can always be made without a PIN code.

### Privacy

By activating this function you are able to add passwords to any of your folders, so you are the only one who has full access to them.



### **Auto keypad lock (to protect your phone)**

Locking the keypad can prevent you from making accidental calls.

1. In Standby mode press **Left Soft button** to access the **Main menu**.
2. Use the Navigation button to select **Settings > Security Settings**.
3. Enable the **Keypad Lock** and select the delay time for this function.

### **Lock screen by End-key**

Activate this function so that you can lock your phone by pressing the **End button** on the main interface.

### **Power-on password**

If you activate this feature you will be prompted to insert a password to allow you to Power ON the phone. This feature is different than having a PIN code, as the PIN code is provided by your network operator and this password is to make sure that this phone can only be used by you.

## Guardlock

In case somebody steals your phone and you have activated this function, as soon as the person inserts a new SIM card, the phone will send a text to the number you pre-set with information.

## 6.6) Management

1. In Standby mode press **Left Soft button** to access the **Main menu**.
2. Use the Navigation button to select **Settings > Connection management**.
3. Edit the following fields to change your settings:

### Network account

Choose which network account you would like to use for your internet connection. If your network is not shown on the list you must add a new connection and follow each give step accordingly.

### GPRS settings

Adjust your GPRS connection settings by choosing when you need the connectivity to be on: **Connect when needed** or **Always connect**.

## 7) Managing Contacts

### 7.1) Creating Contacts

You can add new contacts with additional personal information. Setting this up will allow you to call the person or browse their information quickly and efficiently. Contacts can be saved in the phone's memory or in the SIM card.

1. In Standby mode press the **Left Soft button** to access the Main menu.
2. Use the Navigation button to select **Contact > Add New**.
3. Select whether to store the new entry on a SIM card or phone.

**Storing on SIM:** The new contact's information can be stored onto SIM1 or SIM2. Select the desired location to store the new entry. Only the name and number information can be added.

**Storing on phone:** This allows you to save to the phone's memory. The name and number can be stored. A ringtone and an image can be assigned to the contact, and you can also add the contact's details to one of your groups.

4. Name: Input the name of the contact using the keypad.
5. Number: Input the contact number using the keypad.
6. Press the **Left Soft button** to Save the details you have added.

## 7.2) Editing Contacts

1. In Standby mode press **Left Soft button** to access the Main menu.
2. Select **Contacts**. The Contact List will display the name of the Contact. Select the contact and press the **OK** button to open up their details which you will be able to Edit in the fields.

## 7.3) Searching for a Contact

1. In Standby mode, press **Left Soft button** to access the Main menu.
2. Use the Navigation button to select and scroll through the **Contact list**.
3. Press **OK** button to view the contact details.

#### 7.4) Deleting a Contact

1. In the Standby mode press the **Left Soft button** to access the Main menu and go to **Contacts**.
2. Use the Navigation button to select the desired contact to delete.
3. Press the **Left Soft button** to access the **Options** menu.
4. Select **Delete** and then **OK** to confirm to remove the entry.

## 8) Using Bluetooth

Bluetooth is a short-range wireless communications technology that allows devices to exchange information over a distance of about 10 Metres without requiring a physical connection. The Bluetooth device must be initially paired with your phone.

### 8.1) Turning ON Bluetooth and making your phone Visible (Discoverable)

Allows you to manage the connection, set up device names and enable the visibility of your phone for other Bluetooth devices.

1. In Standby mode press **Left Soft button** to access the **Main menu**.
2. Use the Navigation button to select **Tools > Bluetooth**.
3. Select **Open Bluetooth** to **ON** and set the Visibility to **Show**.

### 8.2) Pairing with a Bluetooth Device

You can pair your phone with another Bluetooth device.

1. Make sure the phone is Bluetooth-enabled.
2. In Standby mode press **Left Soft button** to access the **Main menu**.
3. Use the Navigation button to select **Tools > Bluetooth**.
4. Select **Paired device > Add new device**, and your phone will start searching for Bluetooth devices within range.

5. Select the name of the device detected on your phone and when prompted, select Pair to complete the pairing process.

Note: To successfully pair 2 devices you must use the same Password.

### 8.3) Un-Pairing a Bluetooth Device

You can disconnect a paired device with your phone.

1. In Standby mode press **Left Soft button** to access the **Main menu**.
2. Use the Navigation button to select **Tools > Bluetooth**.
3. Select **Paired devices** and use the Navigation button to select the device name you wish to unpair.

### 8.4) Sending and Receiving Files

You can use Bluetooth to transfer information between your phone and another Bluetooth-enabled device such as a phone or computer. The first time you transfer information between your phone and another device, you need to enter or confirm a security passcode. Once the device is paired with your phone you will not need to set up the pairing process again unless you delete the device from your phone.

## 9) Multimedia

1. In Standby mode press **Left Soft button** to access the **Main menu**.
2. Select **Multimedia** to access the submenu to display the list of multimedia options.
3. Edit the following submenus to change your multimedia settings.

### 9.1) Video Recorder

Enables you to Record Videos and change the video quality settings. Notice that videos can only be recorded in horizontal mode, but they will be shown in vertical mode.

### 9.2) Video Player

Enables you to see videos you have recorded with your camera and other imported videos.

### 9.3) Image Browser

Enables you to see and manage all the images on your phone. It is possible to edit, rename, send, delete and check the picture information.

1. Press **Options** to display the list of submenus.
2. Edit the following fields to change your settings:



**Change folder:** Change the location where the image is saved.

**Send:** Allows you to send the image via Bluetooth or as a MMS message.

**Slide play:** See your pictures in slides. It will show you all the pictures.

**Delete:** Delete the current image.

**Set image as wallpaper:** Set current image as your wallpaper.

**Rename:** Allows you to rename the file.

**Mark:** Allows you to select one or more images.

**Details:** View the image information: Name, date, time, size, location and resolution.

**Slide settings:** Select the effect for the display of the pictures and the delay time between the pictures.

**Sort by:** Allows you to organise and sort the file by Name, Type, Time or Size.

#### 9.4) Recorder

The display shows the length of recording time and volume metre. You can choose where to store the recordings and change the audio volume.

1. Use the right/left buttons on the Navigation key to select one of the four icons displayed.
2. Press the **OK** button to select one of the icons.
3. Once finished you can **Playback** the recording.
4. By selecting the icon on the right side you will have access to your recording list.

### 9.5) FM Radio

Plug in your headset before use as this will function as an antenna as well as a headphone for you to listen to the radio.

1. Insert the headphone into the **Mini USB** port on the phone.
2. In Standby mode press **Left Soft button** to access the **Main menu**.
3. Use the **Up/Down button** on the Navigation button to select **Multimedia > FM Radio**.
4. Use the **Left/Right button** on the Navigation button to adjust the frequency.
5. Use the **OK** button to change between speaker and earphone.
6. Use the **Star and Hash** key to adjust the volume.
7. Use the **Down** key on the Navigation button to power **ON/OFF**.
8. Select **Options** to edit the following settings:

**Auto search and save:** Enables the Auto search and automatically saves the channels in its memory.

**Channel list:** Lists the present radio channels.

**Save:** Save the current channel.

**Manual search:** Inputs the frequency of the radio station manually.

**Open speaker:** Enables or disables Loudspeaker.

**Background play:** You can leave the FM radio interface and still listen to it while performing other operations on your device.

**Note:** The broadcast reception quality may be affected in an indoor or shielded environment. You can improve the reception quality by putting the phone near a window, adjusting the position of the headphone cable, or manually changing the channels.

## 10) Audio Player

1. In Standby mode press **Left Soft button** to access the **Main menu**.
2. Select **Audio player** to access your playlists.
3. Press Up button on the Navigation key to play or pause.
4. Press Down button on the Navigation key to stop.
5. Use the **Right/Left buttons** on the **Navigation key** to rewind and forward, or to change music.
6. Press **Star key** to decrease volume and **Hash key** to increase it.

You can listen to music from your phone or your playlist from your memory card. It enables you to repeat the same music the number of times you want and to shuffle your music when you are listening to it.

## 11) Camera

1. In Standby mode press **Left Soft button** to access the **Main menu**.
2. Use the Navigation key to go through the main menu and select **Camera**.
3. Use the Navigation key to change the settings, such as size, night mode, brightness, contrast, exposure bias, white balance, delay and effect.
4. Your camera view will be changed from vertical to horizontal according to the size you choose.
5. You can access your gallery by going to **Options**, on the left side of the screen.

## 12) Tools

1. In Standby mode press **Left Soft button** to access the **Main menu**.
2. Select **General** to access the submenu to display the list of options.

### 12.1) Alarm

The alarm clock function can be configured to meet different alarm settings.

1. In Standby mode press **Left Soft button** to access the **Main Menu**.
2. Use the Navigation button to select **General > Alarm**.
3. Edit the following to set your alarms:

**Status:** Activates or deactivates your alarm settings.

**Time:** Adjusts the time of the alarm.

**Repeat:** Selects the alarm to sound once or daily or selected days of the week.

**Snooze:** Set how long the snooze button will pause - between 1 to 10 min intervals.

**Alert Type:** Sets the alarm to ring only or vibrate only.

## 12.2) Calendar

Use your phone's Calendar to create and manage your events, meetings, and appointments. By default the calendar is viewed by month. You can set a reminder and view the calendar by Day, Week, or Month.

1. In Standby mode press **Left Soft button** to access the **Main menu**.
2. Use the Navigation button to select **General > Calendar**.
3. Press the **Left Soft button** to select **options** to open the submenu.
4. Edit the following fields to change your settings:

**View:** View all the event reminders set on a date. Use the **Left/Right button** to view the dates sequentially.

**View All:** View all the event reminders stored on the Calendar.

**Add Event:** Input the details and set different reminders for your events.

**Delete Event:** Delete an entry.

**Jump to date:** Select a date to view the events set up.

**Go to Today:** Select to view events on the current day.

**Go to weekly view:** Select to view weekly events.

### 12.3) eBook

You can view files in TXT format in the eBook folder.

1. In Standby mode press the **Left Soft button** to access the **Main menu**.
2. Use the Navigation button to select **General > eBook > Bookshelf** to access the eBook list.
3. Select the desired file to view.

### 12.4) Calculator

The calculator can be used to perform basic arithmetic calculations.

1. In Standby mode press the **Left Soft button** to access the **Main menu**.
2. Use the Navigation button to select **General > Calculator** to open the calculator interface.
3. Use the keypad to perform your calculations.



### 13) File Manager

This option allows you to manage the files stored in your phone's memory card.

1. In Standby mode, press the **Left Soft button** to access the **Main menu**.
2. Use the Navigation button to select **File Manager**.
3. Once in the File manager you can manage all files stored in your SD memory card

# 14) Internet

## 14.1) Internet Service

1. In Standby mode press **Left Soft button** to access the **Main menu**.
2. Use the Navigation button to select **Internet**.
3. Edit the following fields to modify your internet settings:

**Open:** Select **Go to URL** if you want to go to another website or select **Homepage** if you would like to return to it.

**Current page:** Stop the current page, set it as your homepage, save as bookmark, save as offline page and also check its information.

**Send connection:** Input the required website URL to access the web page.

**Bookmarks:** Check your saved bookmarks.

**History:** See which websites you have previously visited.

**Offline pages:** See webpages when you are offline. The only webpages you can visit are the ones you have saved as offline pages.

**Tools:** Clear cache and cookies, as well as change some of your internet settings

**Exit:** Exit the internet service.

## 14.2) APN Settings

APN setting is only for your 3G/EDGE connection through your data plan. Contact your network operator for more information. You will need details on your APN, username and password.

1. In Standby mode press **Left Soft button** to access the **Main menu**.
2. Use the Navigation button to select **Settings > Connection management > Network account**.
3. Select one of the network connections from the list or go to **Options > New connection** to add a new APN.
4. Input the correct information provided by your network operator to set up the network connection.

## 15) Legal Information

©Tecmobile (International) Ltd. All rights reserved. Tecmobile® and related trademarks, names, and logos are the property of Tecmobile (International) Ltd and are registered and/ or used in Europe and other countries around the world.

### Notice

The information in this manual is subject to change without notice. Whilst every care has been taken in the preparation and design of the manual, statements, recommendations and information, implied or expressed, these do not constitute a warranty of any kind. No part of this manual may be reproduced, quoted or translated by any means or in any form photographically, mechanically or electronically, without the written permission of Tecmobile (International) Ltd.

### Trademarks and Permissions

The Bluetooth® trademark and logos are owned by the Bluetooth SIG Google Mail is a trademark of Google Inc.; Wi-Fi, Wi-Fi Protected Access, Wi-Fi Protected setup, and WPA are trademarks of the Wi-Fi Alliance; Microsoft, Hotmail, Outlook, Windows Live, and Windows Media are trademarks of Microsoft Corporation; GSM and Global System for Mobile Communications are trademarks of the GSM MOU Association; JavaScript is a trademark of Oracle America, Inc. All other trademarks are the property of their respective owners and any use of such trademarks by Tecmobile is under license where required.

## **FCC Notice**

This mobile phone complies with part 15 of the FCC Rules. Operation is subject to the following two conditions: (1) This device may not cause harmful interference, and (2) this device must accept any interference received, including interference that may cause undesired operation.

This mobile phone has been tested and found to comply with the limits for a Class B digital device, pursuant to Part 15 of the FCC Rules. These limits are designed to provide reasonable protection against harmful interference in a residential installation. This equipment generates uses and can radiate radio frequency energy and, if not installed and used in accordance with the instructions, may cause harmful interference to radio communications. However, there is no guarantee that interference will not occur in a particular installation. If this equipment does cause harmful interference to radio or television reception, which can be determined by turning the equipment off and on, the user is encouraged to try to correct the interference by one or more of the following measures:

- Re-orientate or relocate the receiving antenna.
- Increase the separation between the equipment and receiver.
- Connect the equipment into an outlet on a circuit different from that to which the receiver is connected.
- Consult the dealer or an experienced radio/TV technician for help.

Changes or modifications not expressly approved by the party responsible for compliance could void the user's authority to operate the equipment. The antenna(s) used for this transmitter must not be co-located or operating in conjunction with any other antenna or transmitter.

### Warranty Disclaimers

Although every effort is used to reduce inaccuracies and, except those required by applicable law, no warranties of any kind, either express or implied, and including but not limited to the implied warranties of fitness for a particular use or satisfactory quality, are made in relation to the contents, accuracy or reliability of this manual.

Tecmobile reserves the right to modify, change specifications or information in this manual without any consequential liability or prior notice. Under no circumstances, except as required by applicable law, will Tecmobile or any of its licensors be responsible for indirect damages or consequential loss of income or data however caused.

## **Disclaimer**

Third party content and services may be enabled and are available through this device. Some features and accessories referred to in this manual rely on local network settings and installed software. These may or may not automatically be accepted, in total or in a limited way, by local service and network providers. As a consequence, some descriptions may not match the features or product which you can purchase/download. Third party content and services belong to, are the copyright of, are trademarked by and patented by their respective owners under intellectual property law. They should not be used without the express permission of the service provider or content owner and, unless given specific permission by them, you should not transmit, upload, publish, modify, copy or distribute in any way the services or content displayed through this device. The device may contain technology, software or commodities which are subject to regulations and export laws from the US and other countries. Diversion contrary to law is prohibited. To the fullest extent permissible by applicable law by using the applications provided with your device, you acknowledge that the application is provided “as is”. Tecmobile does not provide a warranty, make any representations, or take any responsibility for the end-user support, content or functionality of third-party applications provided with your device.

## 16) Health and Safety

### RF/SAR Information

Your mobile phone is a radio transmitter and receiver. When switching on, your phone sends out low-level radio-frequency (RF). Country governments all over the world adopt state security guidelines developed by independent scientific organisations such as ICNIRP and IEEE. These guidelines establish permitted levels of RF energy for the general population. The guidelines include a substantial safety margin designed to ensure the safety of all persons, regardless of age and health. SAR is the unit of measurement for absorbed radio quantity when using mobile devices. SAR tests are conducted using standard operating positions with the phone transmitting at its highest certified power level, however, the actual SAR level of the phone while operating can be well below the maximum value. In general, the closer you are to a base station, the lower the power output of the phone.

The SAR values may vary, depending on different models of phones. To ensure the safety and health of the users, the phone is designed and manufactured to meet the radio exposure guidelines. The ICNIRP SAR limit for mobiles devices used by the general public is 2W/kg and highest SAR value for this device is tested for use at the ear is below the SAR limit recommended by ICNIRP.

The guidelines use a unit of measurement known as Specific Absorption Rate, or SAR. The SAR limit for mobile devices is 2W/kg and the highest SAR value reported under this standard during product certification for use at the ear is 0.928 W/kg.



## **Batteries**

Never use a charger or battery that is damaged in any way. Use the battery properly. Do not short-circuit the battery, which may damage the battery, cause heat or cause fire. Do not dispose of batteries in high temperature or in a fire as they may explode. Return the waste battery to the dealer or appointed recycle locations.

Do not dispose as household waste. Battery charging time depends on the remaining battery charge, the type of battery, and the charger used. The battery can be charged and discharged hundreds of times, but it will gradually wear out. When the operation time is noticeably shorter than normal, it is time to replace the battery with a new one.

Use only original or approved chargers and batteries. Unplug the charger from the electrical plug and the device when not in use. Do not over charge as this will damage the battery and shorten its life. Leaving the battery in extreme hot or cold places will reduce the capacity of the battery. Li-ion batteries are particularly affected by temperatures below 0°centigrade.

## **Operating Environment**

Remember to follow any special regulations in force in the area you are in, and always switch off your phone whenever it is forbidden to use it, or it may cause danger. When connecting the phone or any accessory to another device, read its User's Guide for detailed safety instructions. Do not connect incompatible products. It is recommended that the equipment should only be used in the normal operating position (held to your ear with the antenna pointing over your shoulder) for your satisfactory operation of the equipment and for the safety of personnel. Do not expose the equipment to temperature below -10° or above 50° centigrade. Keep the phone in an appropriate holder while you are driving. Do not put it on a seat or places where it could fall when driving. To ensure safe driving and avoid accidents, do NOT use the phone when driving.

## **Medical Devices**

Ensure that you switch OFF your phone in areas near electronic medical equipment that obviously require the phone to be switched OFF: (Such as heart pacemakers, hearing aids, etc). Most medical devices can shield the phone's RF signal, but some cannot. If you have any doubts, or need to find out more, please consult your doctor or medical device manufacturer.

## **Pacemakers**

Pacemaker manufacturers advise the distance between your phone and heart pacemaker should be 6 inches (15.3 cm) at least, otherwise the phone could interfere with the pacemaker.

People fitted with a pacemaker should note the following:

- Always keep a distance (at least 6 inches) between the phone and the pacemaker, when the phone is switched ON.
- Do not carry the phone in a breast pocket
- Listen to the phone using the ear which is farther from the pacemaker.

## **Caution:**

Please switch OFF your phone if you feel there is interference, and consult the doctor as soon as you can.

## **Hearing Aids**

Mobile phones may cause some interference with some hearing aids. If so, please consult your hearing aid manufacturer and other safety information.

- If you do not use your phone for extended periods, please switch it OFF and remove the battery to save energy.
- Do not have the volume excessively loud while using the phone, as this could impair your hearing.
- Repairs should only be undertaken by an approved agent.
- Avoid using phone cases that have magnetic closures:  
These can affect the performance and life of the phone and its components.
- If you or your family have a medical record of dizziness or epilepsy, please consult your doctor first, if you want to play games on the phone or use the torch.

## **Emergency Calls**

This phone, like any wireless phone, operates using radio signals, which cannot guarantee connection in all conditions. Therefore, you should never rely solely on any wireless phone for essential communications like medical emergencies. To make or receive calls, the phone must be switched ON and in a service area with adequate signal strength. To make an emergency call, enter the local emergency number in standby mode to make a call.

## Care and Maintenance

Your phone is a product of superior design and craftsmanship and should be treated with care. The suggestions below will allow you to enjoy this product for many years.

- Keep your phone away from small children and pets. They may accidentally damage the phone or choke on small parts.
- Keep the phone dry and avoid liquids that corrode the phone.
- Do not use the phone with a wet hand, which may cause an electric shock.
- Do not store the phone in hot areas, which can shorten the life of electronic devices, damage batteries, or melt accessories.
- Do not store the phone in cold areas. When the phone warms up to its normal operating temperature, moisture can form inside the phone, which may damage the phones electronic circuit boards.
- Do not expose your phone to hot sunlight which may cause it to over-heat.
- Do not place your phone near inflammable liquids, gas or explosive substances.
- Do not drop or knock the phone. Rough handling can break internal circuit boards.
- When cleaning the phone, use a damp or anti-static cloth. Do not use a dry or static cloth.
- Do not use chemicals such as cleaning solvents to clean the surface. Switch OFF the phone first before cleaning.
- Do not paint the phone. Paint can prevent proper operation.

- If your phone has a torch, do not use it too close to the eyes. This may cause damage to eyes.
- If the phone or battery gets wet and the label on the phone are damaged, phone repairs are no longer guaranteed by the manufacturer's warranty, even if the warranty for your phone has not expired.

## **17) Declaration of Conformity**

Hereby, we declare under our sole responsibility that your device, and in combination with the accessories, are in compliance with the appropriate standards EN 60950-1:2006+A11:2009+A1:2010+A12:2011, EN 60950-1:2006+A11:2009+A1:2010+A12:2011, EN 50360:2001/A1:2012; EN 62209-1:2006, EN 62479:2010, EN 301 489-1 V1.9.2; EN 301 489-7 V1.3.1; EN 301 489-17 V2.2.1, EN 301 511 V9.0.2, EN 300 328 V1.7.1, following the provisions of, Radio Equipment and Telecommunication Terminal Equipment directive 99/5/EC with requirements covering EMC directive 04/108/EC, and Low Voltage directive 06/95/EC.

# tecmobile®

| tecmobile.com |

Tecmobile reserves the rights to change specifications and parameters of the products without prior notice.

MODEL NO: TEC/R50

CE 0700

