

HUAWEI *Ascend* G6

User Guide



Contents

Foreword

Preparations

- 2 Your phone at a glance
- 3 Charging the battery
- 4 Powering your phone on and off

Getting started

- 5 Getting to know your home screen
- 7 Using the notification panel
- 7 Accessing applications
- 8 Texting

Personalizing your phone

- 10 Setting the theme
- 10 Change the wallpaper
- 11 Organizing home screen widgets and application icons
- 11 Organizing home screen icons using folders
- 12 Customizing switch shortcuts on the notification panel
- 12 Setting tones
- 13 Changing the font size
- 13 Setting the screen unlock method

Calls

- 16 Smart dialing
- 16 Answering or rejecting a call
- 17 Viewing the call log
- 17 What you can do during a call
- 18 Answering a third-party call
- 18 Making emergency calls
- 19 Other call services

People

- 21 Creating a contact
- 21 Searching for a contact
- 21 Importing or exporting contacts
- 22 Sharing contacts
- 23 Creating a contact group
- 23 Sending messages or emails to a contact group

Messaging

- 24 Sending a text message
- 24 Sending a multimedia message
- 25 Replying to a message
- 25 Searching for a message
- 25 Managing messages

Browser

- 27 Browsing web pages
- 27 Managing bookmarks
- 28 Setting the home page
- 28 Clearing your browsing history

Email

- 29 Adding a POP3 or IMAP email account
- 29 Adding an Exchange account
- 30 Sending emails
- 30 Checking your emails

Multimedia

- 31 Camera
- 33 Gallery
- 35 Music

Internet connection

- 38 Mobile data connection
- 38 Setting up a Wi-Fi connection
- 40 Wi-Fi Direct
- 40 Wi-Fi hotspot

Sharing data

- 42 Bluetooth
- 43 Using DLNA
- 44 Connecting your phone to a computer

Managing applications

- 46 Downloading applications
- 46 Viewing applications
- 46 Uninstalling an application
- 46 Clearing the application cache

Settings

- 48 Turning on or off airplane mode
- 48 Tone settings

49	Display settings
49	Setting the date and time
50	Changing the system language
50	Modifying location service settings
51	Restoring factory settings
51	Online update

Legal Notice

Foreword



Thank you for choosing the **HUAWEI Ascend G6** smartphone.

This guide introduces you to the features and functions of your new phone and safety precautions. Please read it carefully before you start using the phone.

All pictures and illustrations in this document are for your reference only. The actual product may vary.

Symbols and definitions

The following symbols are used in this document.

	Note	Provides additional information.
	Caution	Indicates potential problems that may arise without the proper care and, if necessary, how to handle these problems.



Preparations

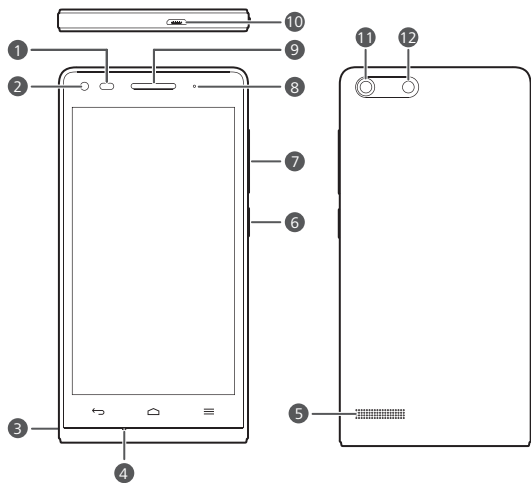

Your phone at a glance



1	Proximity sensor/light sensor	2	Front camera
3	Headset jack	4	Microphone
5	Speaker	6	Power button 
7	Volume button	8	Status indicator
9	Earpiece	10	Micro USB port
11	Rear camera	12	Flashlight

Buttons

- When your phone is powered off, press and hold  to power it on.
- Press  to turn on or off the screen. Press and hold  to display an option menu.

-
- Touch  to return to the previous screen or exit the current application.
 - When you are entering text, touch  to hide the onscreen keyboard.
-

 Touch  to return to the home screen.

 Touch  to display the option menu.

Charging the battery

 Your phone's built-in battery is not user-removable. To replace the battery, contact an authorized service center. Do not attempt to remove it yourself.

Use the provided USB cable and power adapter to connect your phone to a power outlet, or use the USB cable itself to connect your phone to a computer.

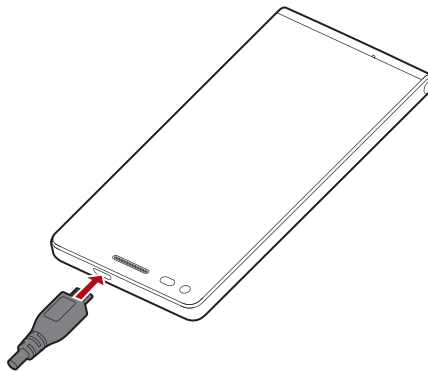

Battery indicator

The battery indicator shows your phone's battery level.



- Blinking red: The battery level is lower than 10%.
- Steady red (when charging): The battery level is lower than 10%.
- Steady yellow (when charging): The battery level is higher than 10%.



- Steady green (when charging): The battery is almost or already full.

Important information about the battery

- If the battery power is depleted, you may not be able to power on your phone immediately after you begin charging the battery. This is normal. Allow the battery to charge for a few minutes before attempting to power on your phone.
- Rechargeable batteries have a limited number of charge cycles and may eventually need to be replaced. When the battery life becomes noticeably shorter, replace the battery.
- The time required to fully charge the battery depends on the ambient temperature and age of the battery.
- If your phone is very low on power, it plays an alert tone and displays a message. If the battery level is extremely low, your phone automatically powers off.

Powering your phone on and off

- To power on your phone, press and hold .
- To power off your phone, press and hold  to display an option menu, and then touch **Power off > OK**.

-  If errors occur and you cannot power off your phone, press and hold  for 10 or more seconds to restart your phone.

Getting started

Getting to know your home screen

Your home screens are where you'll find your favorite widgets and all your applications. We did away with the application list to give you a more convenient and direct path to your applications. The default home screen is shown below.

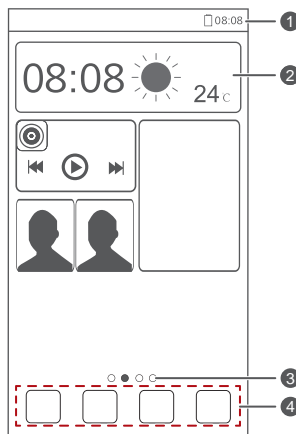

1

Status bar: displays notifications and icons. Flick down from the status bar to open the notification panel.

2

Display area: displays application icons, folders, and widgets.

3

Screen position indicator: shows the current screen's position.

4

Dock: displays your most common applications.

Switching between home screens

Running out of space on the home screen? Not to worry. Your phone lets you create more home screens for various application icons and widgets.

- Flick left and right across the screen to switch between the home screens.

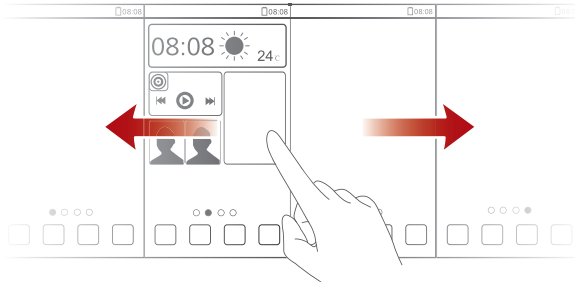

- Pinch two fingers together to display the home screen thumbnails. Touch a thumbnail to enter that particular home screen.

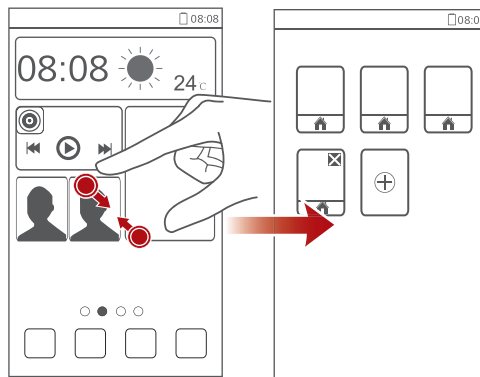

Taking a screenshot

Want to share an interesting scene in a movie or show off your new high score in a game? Take a screenshot and share away.

Press  and the volume down button simultaneously to take a screenshot.

Then, open the notification panel and touch  to share the screenshot.

Screenshots are saved to the **Screenshots** album in **Gallery**.

Auto-rotate screen



Your phone features a tilt sensor. If you rotate your phone when browsing a web page or viewing a photo, the orientation of your screen will automatically change to landscape or portrait view. You'll also be able to enjoy tilt sensor-based applications, such as racing games.

To quickly turn the auto-rotate screen function on or off, flick down from the status bar to open the notification panel and touch .

Using the notification panel

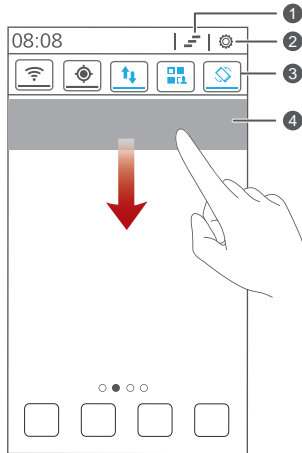
Flick down from the status bar to open the notification panel.



- 1 Touch  to delete all notifications.
- 2 Touch  to display the settings screen.
- 3 Touch the switch shortcuts on the notification panel to turn on or off the functions.
- 4 Touch an application to start it and flick left or right across a notification to dismiss it.

Accessing applications

Starting applications and switching between them

On the home screen, touch an application icon to open it.

To switch to another application, touch  to return to the home screen, and touch the icon of the application you want to open.

Viewing recently used applications

To display the list of recently used applications, touch and hold . You can then:



- Touch an application to start it.
- Flick left or right across an application to dismiss it.
- Touch  to clear the list.

Texting

Your phone comes with multiple text input methods. You can quickly enter text using the onscreen keyboard.

- Touch a text box to bring up the onscreen keyboard.
- To hide the onscreen keyboard, touch .





Selecting an input method

1. On the text input screen, flick down from the status bar to open the notification panel.
 2. Touch  to select an input method.
-  To change your phone's default input method, touch **Settings** on the home screen. Then touch the **All** tab. Under **PERSONAL**, touch **Language & input** > **Default** to select an input method.

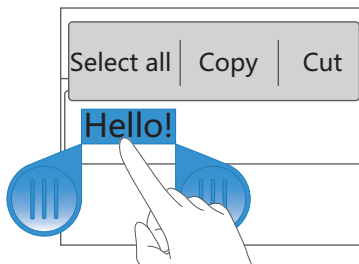
Editing text

Learn how to select, cut, copy, and paste text on your phone.



- **Select text:** Touch and hold the text to bring up . Then drag  and  to select more or less text, or touch **Select all** to select all text in a text box.
- **Cut text:** Select text and touch **Cut**.
- **Copy text:** Select text and touch **Copy**.
- **Paste text:** Touch where you want to insert the text, drag  to move the insertion point, and touch **Paste** to paste the text you copied or cut.

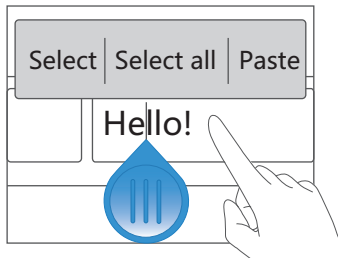

Personalizing your phone

Setting the theme

Your phone comes with a variety of themes. You can download more themes and mix and match theme elements to find a perfect fit.

Changing the theme

1. On the home screen, touch **Themes**.
2. Select a theme and touch **APPLY**.

Customizing a theme

1. From the theme grid, touch **CUSTOMIZE CURRENT THEME**.
2. From the element list, choose the element you want to modify.

Change the wallpaper

1. On the home screen, touch and hold a blank area to display the **Set home screen** dialog box.
2. Touch **Wallpapers**.
3. From the **Wallpaper** screen, you can set the following items:
 - **Lock screen wallpaper:** Set the wallpaper displayed on the phone lock screen.
 - **Home screen wallpaper:** Set the home screen wallpaper.
 - **Shake to change:** Change the home screen wallpaper by shaking your phone.
 - **Random change:** The home screen wallpaper changes randomly.



Organizing home screen widgets and application icons

Adding a widget to the home screen

1. On the home screen, touch and hold a blank area to display the **Set home screen** dialog box.
2. Touch **Widgets**.
3. Drag a widget from the screen's lower section to a screen thumbnail.
4. Touch  to return to the home screen.

 If the home screen doesn't have enough space, your phone will automatically create a new home screen to the original's right and place the widget on the new home screen.

Deleting an application icon or widget

On the home screen, touch and hold the application icon or widget you want to delete until  is displayed. Drag the unwanted application icon or widget to  to delete it.

 Deleting an application icon uninstalls the application. When you delete an application icon, your phone prompts you to confirm the action. Touch **OK** to uninstall the application.

Moving an application icon or widget

You can re-arrange application icons and widgets to any fitting empty space on the home screen.

Organizing home screen icons using folders

Creating a folder on the home screen

1. On the home screen, drag an item onto another one to create a folder containing both of them.

2. You can then:

- Touch the folder name to rename it.
- Touch  and add more items to the folder.

Removing an item from a folder

1. On the home screen, touch a folder.
2. Drag an item out from the folder to remove the item.

A folder must contain at least two items; otherwise, the folder will automatically disappear.

Customizing switch shortcuts on the notification panel

You can rearrange your switch shortcuts and move those you use most to top the list. Shortcuts on the top will be fully displayed on the notification panel.

1. Flick down from the status bar to open the notification panel.
2. Flick left on the upper area. Touch  to display the switch shortcut list.
3. Drag a switch shortcut to a new position in the list.

Setting tones

Setting the ringtone

1. On the home screen, touch **Settings** then the **All** tab.
2. Under **DEVICE**, touch **Sound**.
3. Touch **Phone ringtone** and select either of the following options from the displayed dialog box:
 - **Ringtone**: choose from the default selection.
 - **Music**: choose from the audio files you have saved to your phone.
4. Touch **Apply**.

Setting notification tones

1. On the home screen, touch **Settings** then the **All** tab.
2. Under **DEVICE**, touch **Sound**.
3. Touch **Notification tone**.
4. Select a tone type.



You can configure the email notification tone only after you have set up an email account.

5. Select a tone.
6. Touch **Apply**.

Changing the font size

1. On the home screen, touch **Settings** then the **All** tab.
2. Under **DEVICE**, touch **Display**.
3. Touch **Font size** and select a font size.

Setting the screen unlock method

Face unlock

1. On the home screen, touch **Settings** then the **All** tab.
2. Under **PERSONAL**, touch **Security**.
3. Touch **Screen lock** > **Face Unlock**.
4. Follow the onscreen instructions to take a photo of your face.
Your phone will use face unlock as the primary unlock method.
5. Set a secondary unlock method.

If face unlock cannot recognize you (dim light, for example), follow the onscreen instructions to unlock your phone using the secondary unlock method.

To turn off face unlock, use the secondary unlock method to enter the **Screen lock** screen, and select another unlock method.

Unlocking the screen with a pattern

1. On the home screen, touch **Settings** then the **All** tab.
2. Under **PERSONAL**, touch **Security**.
3. Touch **Screen lock** > **Pattern**.
4. Follow the onscreen instructions to set a screen unlock pattern.

 If you draw incorrect patterns five consecutive times, the screen stops responding to further unlock attempts for 30 seconds. You will still be able to make emergency calls during this time.

Unlocking the screen with a PIN

1. On the home screen, touch **Settings** then the **All** tab.
2. Under **PERSONAL**, touch **Security**.
3. Touch **Screen lock** > **PIN**.
4. Follow the onscreen instructions to set a screen unlock PIN.

After a PIN is set, you will have to enter it every time you want to unlock the phone screen.

 If you enter incorrect PINs five consecutive times, the screen stops responding to further unlock attempts for 30 seconds. You will still be able to make emergency calls during this time.

Unlocking the screen with a password

1. On the home screen, touch **Settings** then the **All** tab.
2. Under **PERSONAL**, touch **Security**.
3. Touch **Screen lock** > **Password**.
4. Follow the onscreen instructions to set a screen unlock password.
5. Repeat the password and touch **OK**.

After a password is set, you will have to enter it every time you want to unlock the phone screen.

-  If you enter incorrect passwords five consecutive times, the screen stops responding to further unlock attempts for 30 seconds. You will still be able to make emergency calls during this time.

Calls

Smart dialing



In addition to standard call procedures, smart dialing lets you quickly find contacts by entering parts of their names or numbers.

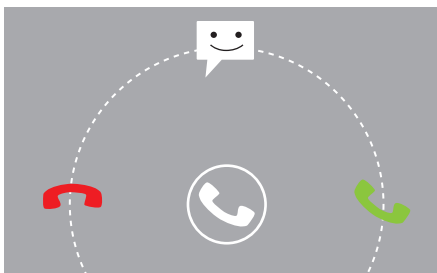

1. On the home screen, touch **Phone**.
2. Enter a phone number or the initials or first several letters of a contact name.
Matching contacts in your phone and phone numbers in your call log are then displayed in a list.
3. From the list, select the contact you want to call.
4. To end the call, touch .

Answering or rejecting a call

-  When a call comes in, you can press the volume button to mute the ringtone.



- Drag  right to answer the call.
- Drag  left to reject the call.





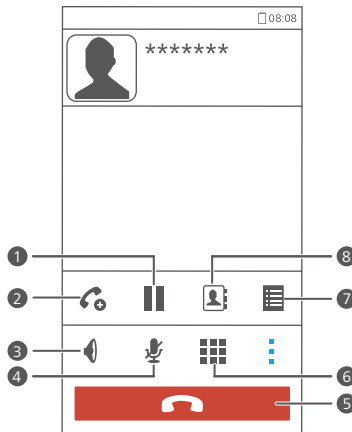

- Drag  up to reject the call and send the caller a message.
-  On the dialer screen, touch  > **Call settings** > **Quick responses** to edit the message that will be sent.

Viewing the call log

1. On the home screen, touch **Phone** to display your recent calls above the dialer.
2. Touch  > **Missed calls** to view your missed calls.

What you can do during a call



1. Touch  >  to place the current call on hold, and touch  again to resume the call.
2. Touch  >  to start a three-way call. Before you use three-way calling, make sure you have subscribed to this service. For details, contact your service provider.
3. Touch  to use the speakerphone.

4 Touch  to mute or unmute the microphone.

5 Touch  to end the call.

6 Touch  to display the dialer.



7 Touch  >  to display a note.

8 Touch  >  to display the contact list.

To return to the call screen, flick down from the status bar to open the notification panel, and touch **Current call**.

Answering a third-party call

Before you answer a third-party call, make sure you have turned on call waiting.

1. If a call comes in when you are already in another call, drag  right to answer the new call and place the first call on hold.
2. To switch between the two calls, touch .

Making emergency calls

In the event of an emergency, you will still be able to make emergency calls without the use of a SIM card. However, you must still be under the coverage area.

1. On the home screen, touch **Phone**.
2. Enter your local emergency number and touch .

 Emergency calls are subject to cellular network quality, use environment, service provider policies, and local laws and regulations. Never rely solely on your phone for critical communications when emergencies occur.

Other call services

Your phone also supports other call functions, such as call forwarding, call waiting, and voicemail. Before you use these functions, make sure you have subscribed to these services. For details, contact your service provider.

Enabling call forwarding

Too busy to answer all your calls with one phone? Forward them to another number and never miss an important call again!

1. On the home screen, touch **Settings** then the **All** tab.
2. Under **APPS**, touch **Call**.
3. Touch **Call forwarding**.
4. Select a forwarding mode.
5. Enter the phone number to which you want to forward calls, and touch **Enable**.

Enabling call waiting

The call waiting function lets you answer another incoming call when you are already busy in a call and switch between the two calls.

1. On the home screen, touch **Settings** then the **All** tab.
2. Under **APPS**, touch **Call**.
3. Touch **Additional settings**.
4. Touch **Call waiting** to enable call waiting.

Setting up your voicemail

Voicemail is your personal storage for missed calls, including the calls missed when you are in another call or your phone is powered off.

-  Before you use voicemail, make sure you have subscribed to the voicemail service and obtained your voicemail number. For details, contact your service provider. You must also enable call forwarding and set all incoming calls to be forwarded to your voicemail.

1. On the home screen, touch **Settings** then the **All** tab.

2. Under **APPS**, touch **Call**.
3. Touch **Voicemail** > **Voicemail settings** > **Voicemail number**.
4. Enter your voicemail number, and touch **OK**.

To listen to your voicemail messages, touch and hold the **1** key on the dialer and follow the voice instructions.

People

Forget about lugging around business card holders. You can now easily store and manage your contacts.

Creating a contact

1. On the home screen, touch **People** then the **Contacts** tab.
2. Touch  .
3. Select an account.
4. Enter the contact name, phone number, and other details. Touch **Add another field** to enter more information.
5. Touch **DONE** to save the contact.

Searching for a contact

1. On the home screen, touch **People** then the **Contacts** tab.
 2. Touch the search box.
 3. Enter the contact name or initials.
Matching results are displayed as you type.
- For example, to search for John Doe, enter **John Doe** or **JD**.

Importing or exporting contacts

Your phone supports contact files in .vcf format only. This is a standard format for files storing contacts. Contact names, addresses, phone numbers, and other information can be saved in .vcf files.

Importing contacts from a storage device

You can import contacts saved in a .vcf file from a storage device to your phone.

1. On the home screen, touch **People** then the **Contacts** tab.

2. Touch  > **Manage contacts** > **Import from storage**.
3. Select one or more .vcf files.
4. Touch **OK**.

Importing contacts from a Bluetooth device

You can import contacts saved in a .vcf file from a Bluetooth device to your phone.

1. On the home screen, touch **People** then the **Contacts** tab.
2. Touch  > **Manage contacts** > **Import via Bluetooth**.
Your phone then enables Bluetooth and searches for available Bluetooth devices.
3. Touch the Bluetooth device with which you want to pair your phone.
When the two devices are paired, your phone automatically imports contacts from the other device.

Exporting contacts

Back up your contacts to an external storage device to avoid losing them during a system upgrade or by mistake.

1. On the home screen, touch **People** then the **Contacts** tab.
2. Touch  > **Manage contacts** > **Export to storage**.
A dialog box is then displayed, showing the exported .vcf file name and its save location.
3. Touch **OK**.

To view the .vcf file you just exported, open **File Manager**. The file is displayed in the root directory of your phone's internal storage.



Sharing contacts

You can share contacts in .vcf format in many ways.

1. On the home screen, touch **People** then the **Contacts** tab.
2. Touch  > **Share contacts**.



3. Touch the contacts you want to share or touch **All** to select all contacts.
4. Touch **SHARE** and choose a sharing method from the displayed option menu.

Creating a contact group

1. On the home screen, touch **People** then the **Groups** tab.
2. Touch .
3. Name the contact group.
4. Touch .
5. Select one or more contacts.
6. Touch **ADD MEMBERS**.
7. Touch **DONE**.



Sending messages or emails to a contact group

1. On the home screen, touch **People** then the **Groups** tab.
2. Touch and hold the contact group you want to send a message or email to.
3. From the displayed option menu, choose **Send message** or **Send email**.

 You can also open the contact group and touch  to send a message or  to send an email.







Messaging

Sending a text message

1. On the home screen, touch **Messaging**.
2. In the list of message threads, touch .
3. Touch the recipient text box and enter the contact name or phone number.
-  Touch  to select more contacts.
4. Write your message.
5. Touch **Send**.

Sending a multimedia message

Make sure your data service is on before trying to send multimedia messages.

1. On the home screen, touch **Messaging**.
2. In the list of message threads, touch .
3. Touch the recipient text box and enter the contact name or phone number.
-  Touch  to select more contacts.
4. Touch  > **Add subject** and enter the message subject.
5. Write your message.
6. Touch , select the attachment type, and attach a file.
-  To attach more than one files to the message, touch **Slideshow**.
7. Touch **Send**.

Replying to a message

1. On the home screen, touch **Messaging**.
2. In the list of message threads, touch a contact name or phone number to view the conversation thread.
3. Touch the text field to write your reply.
4. Touch **Send**.

Searching for a message

1. On the home screen, touch **Messaging**.
2. In the list of message threads, touch  > **Search**.
3. Enter the message or contact, or parts of them.
Your phone then displays matching results.

Managing messages

Copying a message

1. On the home screen, touch **Messaging**.
2. In the list of message threads, touch a contact name or phone number to view the conversation thread.
3. Touch and hold the message you want to copy.
4. From the displayed option menu, choose **Copy text**.
5. Touch and hold the area you want to paste the message and choose **Paste** from the displayed option menu.

Forwarding a message

1. On the home screen, touch **Messaging**.
2. In the list of message threads, touch a contact name or phone number to view the conversation thread.

3. Touch and hold the message you want to forward.
4. From the displayed option menu, choose **Forward**.
5. Touch the recipient text box and enter the contact name or phone number.

 Touch  to select more contacts.

6. Touch .

Deleting a message

1. On the home screen, touch **Messaging**.
2. In the list of message threads, touch a contact name or phone number to view the conversation thread.
3. Touch and hold the message you want to delete and touch **Delete**.

Deleting a thread

1. On the home screen, touch **Messaging**.
2. In the list of message threads, touch and hold the thread you want to delete.
3. From the displayed option menu, choose **Delete messages**.

Browser

Your phone's browser lets you surf the web and stay on the ball with up-to-date news and information. Staying connected has never been easier.

Browsing web pages

1. On the home screen, touch **Browser**.
2. Enter a website address in the address box.
Your phone displays matching websites as you type.
3. Touch the website you want to visit.

Managing bookmarks

Bookmarks let you keep track of your favorite websites.

Adding a bookmark

1. On the home screen, touch **Browser**.
2. On the **Browser** screen, open the web page you want to add as a bookmark.
3. Touch  > **Save to bookmarks**.
4. Name the bookmark or use the default name. Then, touch **OK**.

Accessing a bookmark

1. On the home screen, touch **Browser**.
2. On the **Browser** screen, touch .
3. Touch **Bookmarks**.
4. Under **Local**, touch a bookmark.

Editing a bookmark

1. On the home screen, touch **Browser**.

2. On the **Browser** screen, touch .
3. Touch **Bookmarks**.
4. Touch and hold the bookmark you want to edit.
5. From the displayed option menu, choose **Edit bookmark**.
6. Edit the bookmark.
7. Touch **OK**.

Setting the home page

Set your favorite web page as your browser's home page to make life a little easier.

1. On the home screen, touch **Browser**.
2. On the **Browser** screen, touch .
3. Touch **Settings > General > Set homepage**.
4. From the displayed option menu, choose the web page you want to set as the home page.

Clearing your browsing history

To better protect your privacy, clear your browsing history from time to time.

1. On the home screen, touch **Browser**.
2. On the **Browser** screen, touch .
3. Touch **Settings > Privacy & security > Clear history**.
4. Touch **OK**.

Email



Don't want to miss important emails from your friends or clients during your business trip? Use your phone to read and reply to emails when you are on the go.

Adding a POP3 or IMAP email account

Certain parameters must be set when you add a POP3 or IMAP email account. For details, contact your email service provider.

1. On the home screen, touch **Email**.
2. Select an email account type.
3. Enter your **Email address** and **Password**, and touch **Next**.
4. Follow the onscreen instructions to configure the email settings.

When the email account is set up, the **Inbox** screen is displayed.

 To add more email accounts, touch  > **Settings** > **Add account**.

Adding an Exchange account



Exchange is an email system developed by Microsoft to implement communication inside an enterprise. Some email service providers also provide Exchange accounts for individuals and families.

Certain parameters must be set when you add an Exchange account. For details, contact your email service provider.







1. On the home screen, touch **Email**.
2. Touch **Exchange**.
3. Enter your **Email address**, **Domain**, **Username**, and **Password**. Then, touch **Next**.
4. Follow the onscreen instructions to configure the email settings.

When the Exchange account is set up, the **Inbox** screen is displayed.

Sending emails

1. On the home screen, touch **Email**.
2. Open an email account.
3. On the **Inbox** screen, touch .
4. Enter the recipient and subject and write your message. Upload any attachments.
5. When you are done, touch  to send the email.

Checking your emails

1. On the home screen, touch **Email**.
2. Open an email account.
3. On the **Inbox** screen, touch the email you want to read.
4. When reading an email, you can:
 - Touch  to reply to it.
 - Touch  to forward it.
 - Touch  to delete it.
 - Touch  to go back to the previous email.
 - Touch  to skip to the next email.
-  Mail retrieval may be slightly delayed, depending on the network condition. Touch  in the lower right corner to refresh the inbox.

Multimedia

Camera

As time flies by, there must be some memories you want to keep forever. Camera is a great tool for this. It supports a variety of capture modes, such as beauty and smile.



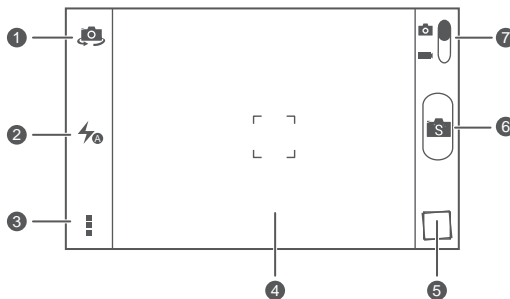



Viewfinder





① Touch  to switch between the rear and front cameras.

② Touch  to set the flashlight mode.

Touch  to open the option menu, where you can:

- Touch  to switch to normal mode.
- Touch  to switch to smart mode.
- Touch  to switch to beauty mode.
- ③ • Touch  to switch to HDR mode.
- Touch  to switch to panoramic mode.
- Touch  to switch to special effects mode.
- Touch  to enable or disable **Object tracking**, **Capture smiles**, **Touch to capture**, and other functions, as well as set the photo resolution, timer, and other parameters.



-
- 4
 - Touch an object on the viewfinder to focus the camera on it.
 - Spread two fingers to zoom in or pinch to zoom out.
-
- 5 Touch the thumbnail to view your photos.
-
- 6 Touch  to take a photo.
-
- 7
 - Drag the slider to  to switch to photo mode.
 - Drag the slider to  to switch to video mode.
-

Taking a photo

1. On the home screen, touch **Camera**.
2. Frame the scene you want to capture. The camera automatically focuses itself.
When the viewfinder frame turns green, the camera is focused.



3. Touch .

Shooting a video

1. On the home screen, touch **Camera**.
2. Frame the scene you want to record.
3. Touch  to start recording.
4. Touch  to stop recording.





Taking a photo in beauty mode

Want great photo quality without putting on any makeup? Enable beauty mode for flawless photos.

1. On the home screen, touch **Camera**.
2. In photo mode, touch  >  to switch to beauty mode.
3. Frame the scene you want to capture and adjust the beauty level.
The camera will identify a face and focus on it.
4. Touch .



Taking a panoramic photo

Are you still upset that your camera's view angle isn't wide enough to capture an incredible scene? Panorama mode is exactly the solution you need. You'll be able to piece together several photos and combine them into one seamless shot.

1. On the home screen, touch **Camera**.
2. In photo mode, touch  >  to switch to panoramic mode.
3. Frame the scene you want to capture.
4. Touch .
5. Move your phone slowly in the direction indicated by the arrow to capture multiple photos.
6. Your phone stops shooting when it has taken enough photos for a panoramic photo. You can also touch  to stop shooting.
The camera automatically stitches the photos together to create one panoramic photograph.

Using HDR

High dynamic range (HDR) imaging technology improves the details in the lightest and darkest areas of photos for true-to-life quality.

1. On the home screen, touch **Camera**.
2. In photo mode, touch  >  to switch to HDR mode.
3. Frame the scene you want to capture. The camera automatically focuses itself.
When the viewfinder frame turns green, the camera is focused.
4. Touch .

Gallery

Gallery is your personal treasure box of sweet memories.







Viewing photos or videos

1. On the home screen, touch **Gallery**.
2. Touch the album you want to view.
3. Touch the photo or video to view it in full screen mode.

 When viewing a photo, pinch two fingers together to zoom out or spread them apart to zoom in.

Editing a photo

You can remove red eye, crop a photo, or apply a number of effects to make your photos even more stunning.



1. On the home screen, touch **Gallery**.
2. Touch the photo you want to edit.
3. Touch  > **Edit** and then you can:
 - Touch  to select a filter.
 - Touch  to rotate or crop the photo.
 - Touch  to lighten or shadow the photo.
 - Touch  to add a frame to the photo.
4. Touch .

Sharing a photo or video

Want to share your best shots or an amusing trick your dog just did? Simply share the photos and videos using email, Bluetooth, and more.

1. On the home screen, touch **Gallery**.
2. Touch the photo or video you want to share.
3. Touch .
4. Choose a sharing method and follow the onscreen instructions.

Setting a photo as the wallpaper

1. On the home screen, touch **Gallery**.
2. Choose the photo you want to set as the wallpaper.
3. Touch  > **Set as** > **Wallpaper**.
4. Drag the frames of the grid to resize it.
5. Touch .

Music

In the mood for music? Your phone provides you with a supreme audio experience.

Adding songs

You can copy songs to your phone and immerse yourself in a world of extraordinary sound anytime. Add songs to your phone by:

- Copying songs from your computer using a USB cable.
- Downloading songs from the web.
- Copying songs from Bluetooth devices.
- Copying songs from other devices using Wi-Fi.

Listening to music

1. On the home screen, touch **Music**.
2. Choose a category.
3. Touch the song you want to play.

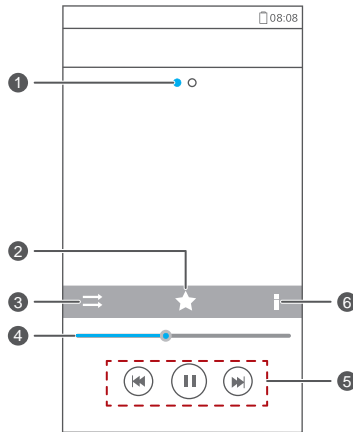

① Flick left or right to switch between the album cover and lyrics.

② Touch ★ to add a song to your favorites.

③ Touch ⇌ to switch the playing mode.

④ Drag the slider to control the playback.

- Touch ▶ to play and touch || to pause.

⑤ • Touch ⏮ to go back to the previous song.

- Touch ⏭ to skip to the next song.

⑥ Touch ⋮ to display the option menu from which you can perform additional operations.

i When a song is playing, touch 🏠 to exit the playback screen without stopping the song. To return to the music playback screen, open the notification panel and touch the playing song.

Creating a playlist

Creating playlists lets you be creative with your songs, and organize them into groups. You'll be able to listen to the playlist that best fits your mood.

1. On the home screen, touch **Music**.

2. Touch **Playlists > Create new playlist**.
3. Touch the text box to name the playlist.
4. Touch **Save**.
You can now add songs to the playlist.
5. In the displayed dialog box, touch **OK**.
6. Select the songs you want to add.
7. Touch **ADD**.

Playing a playlist

1. On the home screen, touch **Music**.
2. Touch **Playlists**.
3. Touch and hold the playlist you want to play.
4. From the displayed option menu, choose **Play**.

Internet connection

Mobile data connection

After you insert a SIM card into your phone and power it on for the first time, your phone automatically registers with your service provider's data service.

Checking the network connection

1. On the home screen, touch **Settings** then the **All** tab.
2. Under **WIRELESS & NETWORKS**, touch **Mobile networks**.
3. Touch **Access Point Names** or **Network operators** to check network connection settings.

 Your phone automatically reads access point settings from your SIM card. Do not change the access point settings; otherwise, you may not be able to access the network.

Enabling the data service

1. On the home screen, flick down from the status bar to open the notification panel.
2. Touch  to enable your phone's data service.

 When you don't need to access the Internet, disable the data service to save battery power and reduce data usage.

Setting up a Wi-Fi connection

When you use your phone at home, you can connect to the Wi-Fi hotspot created from your router. Some public locations, such as airports and libraries, may also have Wi-Fi networks available for use.

Connecting to a Wi-Fi network

1. On the home screen, touch **Settings** then the **All** tab.

2. Under **WIRELESS & NETWORKS**, touch the Wi-Fi switch to turn on Wi-Fi.
3. Under **WIRELESS & NETWORKS**, touch **Wi-Fi**.
Your phone then scans for available Wi-Fi networks and displays them.
4. Choose the Wi-Fi network you want to connect to and touch **Connect**.
For an encrypted Wi-Fi network, enter the password when prompted.

 If Wi-Fi and mobile data are both enabled, your phone connects to the Wi-Fi network preferentially. When Wi-Fi becomes unavailable, your phone automatically switches to the mobile data connection.

Connecting to a Wi-Fi network using WPS

Wi-Fi protected setup (WPS) lets you quickly connect to a Wi-Fi network. A safe connection is set up by pressing the WPS button or entering the PIN.

 To use the WPS function and set up a Wi-Fi connection between your phone and a Wi-Fi hotspot, make sure the Wi-Fi hotspot also supports the WPS.

Using the WPS button

1. On the home screen, touch **Settings** then the **All** tab.
2. Under **WIRELESS & NETWORKS**, touch the Wi-Fi switch to turn on Wi-Fi.
3. On the Wi-Fi network list, touch .
4. On the Wi-Fi hotspot device, press the WPS button.

Using the WPS PIN

1. On the home screen, touch **Settings** then the **All** tab.
2. Under **WIRELESS & NETWORKS**, touch the Wi-Fi switch to turn on Wi-Fi.
3. On the Wi-Fi network list, touch .
4. Touch **Input WPS PIN**.
Your phone generates a PIN.
5. On the Wi-Fi hotspot device, enter the PIN.

Wi-Fi Direct

Wi-Fi Direct lets you easily connect two devices and transmit or share data between them.

Connecting two devices using Wi-Fi Direct

1. On the home screen, touch **Settings** then the **All** tab.
2. Under **WIRELESS & NETWORKS**, touch the Wi-Fi switch to turn on Wi-Fi.
3. In the Wi-Fi network list, touch  .
Your phone then scans for available devices and displays them.
4. Select a device.

Sending a file using a Wi-Fi network

1. Touch and hold the file you want to send.
2. From the displayed option menu, choose **Share**.
3. Touch **Wi-Fi direct**.
Your phone then scans for available devices and displays them.
4. Touch the device you want to send the file to.

 Specific steps may vary slightly by file type.

Wi-Fi hotspot

Your phone can also function as a Wi-Fi hotspot for other devices, sharing its mobile data connection.

1. On the home screen, touch **Settings** then the **All** tab.
2. Under **WIRELESS & NETWORKS**, touch **More...**
3. Touch **Tethering & portable hotspot > Configure Wi-Fi hotspot**.
4. Name the Wi-Fi hotspot.
5. Select an encryption mode.

 It is recommended that you set the encryption mode to WPA2PSK to

better secure the Wi-Fi network.

6. Set the key to the Wi-Fi hotspot.

When other devices want to access your phone's network, this key must be entered.

7. Select the **Portable Wi-Fi hotspot** check box.

8. On the device you want to use, search for and connect to your phone's Wi-Fi network.

Sharing data



Bluetooth

Your phone is Bluetooth-capable, allowing you to connect to other Bluetooth-enabled devices for wireless data transmission. When using Bluetooth, stay within 10 meters (33 feet) of other Bluetooth devices.

Turning on Bluetooth

1. On the home screen, touch **Settings** then the **All** tab.
2. Under **WIRELESS & NETWORKS**, touch **Bluetooth**.

When Bluetooth is turned on, your phone's name is displayed at the top of the **Bluetooth** screen. Touch the name to set your phone's visibility.

 To rename your phone, touch  > **Rename phone**. When you are done, touch **Rename** to save the changes.

Pairing with other Bluetooth devices

To exchange data with another Bluetooth device, enable Bluetooth on both devices and pair them with each other.

1. On the home screen, touch **Settings** then the **ALL** tab.
2. Under **WIRELESS & NETWORKS**, touch **Bluetooth**.
3. From the list of detected Bluetooth devices, touch a device and follow the onscreen instructions to pair with it.

To disconnect from a paired Bluetooth device, under **PAIRED DEVICES**, touch

 > **Unpair**.

 If a Bluetooth connection cannot be set up between your phone and another device, they may be incompatible.

Sharing files using Bluetooth

Bluetooth enables you to conveniently send photos, videos, and other files to your family and friends. You can share files with Bluetooth-enabled devices without an Internet connection.

1. On the home screen, touch **File Manager**.
2. Touch and hold the file you want to send.
3. From the displayed option menu, choose **Share > Bluetooth**.
4. From the detected Bluetooth device list, select a device.

Receiving files using Bluetooth

1. When your phone receives a file transfer request, open the notification panel.
2. Touch **Bluetooth share: Incoming file** to display a file reception dialog box.
3. Touch **Accept** to start receiving the file.

When the file is received, you will receive a notification of a successful transfer. Open the notification panel to read the notification. By default, received files are saved to the **bluetooth** folder in **File Manager**.

Using DLNA

The Digital Living Network Alliance (DLNA) aims to implement intercommunication between computers and other electronic products through wired and wireless networks, providing users with seamless digital media services. DLNA enables users on the same Wi-Fi network to share multimedia files easily. Using DLNA, you can:

- Share multimedia files with your friends.
- Access multimedia files on other DLNA devices.
- Play multimedia files on other devices and control the playback.



Before you use DLNA, make sure your phone and other DLNA devices are connected to the same Wi-Fi network and DLNA is enabled on all devices.

On the home screen, touch **DLNA** to access this application. You can then share photos, videos, and songs with other DLNA devices, as well as view and download the multimedia files that other DLNA devices are sharing with you.

Connecting your phone to a computer

When you connect your phone to a computer using a USB cable, your phone will display a notification prompting you to select a connection type.

MTP mode

The Media Transfer Protocol (MTP) is used to transfer media files, such as pictures, songs, and videos, between your phone and a computer. The MTP mode is only compatible with Windows Media Player 10 or later.

1. Use a USB cable to connect your phone to the computer.
2. On the **USB computer connection** screen, choose **Media device (MTP)**.
The phone driver is then automatically installed on the computer.
3. After the driver is installed, follow the onscreen instructions on the computer to view or transfer files.

PTP mode

The Picture Transfer Protocol (PTP) is another method to transfer pictures and videos to your computer.

1. Use a USB cable to connect your phone to the computer.
2. On the **USB computer connection** screen, choose **Camera (PTP)**.
The phone driver is then automatically installed on the computer.
3. After the driver is installed, follow the onscreen instructions on the computer to view or transfer files.

Mass storage mode

In mass storage mode, you can use your phone as a USB mass storage device and transfer files between your phone and a computer.

1. Use a USB cable to connect your phone to the computer.

2. On the **USB computer connection** screen, choose **USB storage device**.
The phone driver is then automatically installed on the computer.
3. The computer will identify your phone as a USB mass storage device. You can then transfer files between your phone and the computer.



After file transmission, safely remove the device from the computer and disconnect it from the USB cable to prevent your data from being lost or corrupted.

Managing applications

Downloading applications

A rich selection of applications is available through Google's **Play Store**. You can also connect your phone to a computer and transfer applications over that way.

Viewing applications

You can view detailed information about all applications installed on your phone.

1. On the home screen, touch **Settings** then the **All** tab.
2. Under **APPS**, touch **Manage apps**.
3. Flick to **ALL**.
4. Select the application you want to view.

Uninstalling an application

You can remove unwanted applications to increase your phone's available storage.

1. On the home screen, touch **Settings** then the **All** tab.
2. Under **APPS**, touch **Manage apps**.
3. Flick to **All**.
4. Select the application you want to uninstall.
5. Touch **Uninstall** > **OK**.

 Some pre-installed applications cannot be uninstalled.

Clearing the application cache

You can clear the application cache to free up the phone memory.

1. On the home screen, touch **Settings** then the **All** tab.
2. Under **APPS**, touch **Manage apps**.
3. Flick to **All**.
4. Touch **Clear cache**.

Settings

Turning on or off airplane mode

Always comply with all airline rules and regulations. If allowed by the aircraft operator, you may switch on your phone and enable airplane mode in flight.

In airplane mode, your phone's wireless features are disabled, but you can still listen to music or play games.

Use either of the following methods to turn on or off **Airplane mode**:

- Press and hold the power button. From the displayed option menu, choose **Airplane mode**.
- On the home screen, touch **Settings** then the **All** tab. Under **WIRELESS & NETWORKS**, touch **Airplane mode**.

When airplane mode is on,  appears in the status bar.

Tone settings

1. On the home screen, touch **Settings** then the **All** tab.
2. Under **DEVICE**, touch **Sound**.
3. From the settings screen, you can:
 - Touch **Volume** and drag the sliders to set the volume of music, ringtones, message tones, and more.
 - Touch **Vibration** to set whether your phone vibrates when you have an incoming call, message, email, event, and more.
 - Touch **Silent mode** to turn on or off silent mode.
 - Touch **Phone ringtone** to select a ringtone.
 - Touch **Notification tone** to select a tone for messages, emails, events, and more.
 - Touch **SYSTEM** to turn the notification tone or vibration on or off when you touch or lock the screen, take a screenshot, dial a number, and more.

-  You can adjust the volume from the home screen or most applications, such as call, music, and video.

Display settings

1. On the home screen, touch **Settings** then the **All** tab.
2. Under **DEVICE**, touch **Display**.
3. On the settings screen, you can:
 - Touch **Brightness** to set the screen brightness. To manually adjust the brightness, clear the **Automatic brightness** check box.
 - Touch **Wallpaper** to set the lock screen and home screen wallpapers.
 - Touch **Auto-rotate screen** to turn on or off the screen auto-rotate function. If this function is turned on, your screen's orientation will automatically change with the way you hold your phone when you perform certain operations, such as browsing a web page, viewing a picture, or writing a message.
 - Touch **Sleep** to set a screen timeout period. If idle for the specified period, your phone automatically locks its screen to save battery power.
 - Touch **Daydream** to turn on or off the screen saver. If this function is enabled, the screen saver will automatically run while your phone is being charged.
 - Touch **Font size** to change the display font size.

Setting the date and time

By default, your phone relies on the network-based date and time. You can also manually set the date and time.

1. On the home screen, touch **Settings** then the **All** tab.
2. Under **SYSTEM**, touch **Date & time**.
3. From the settings screen, you can:

- Clear the **Automatic date & time** check box to stop your phone from automatically obtaining the network date and time.
- Clear the **Automatic time zone** check box to stop your phone from automatically obtaining the network time zone.
- Touch **Set date** and flick up and down to set your phone's date.
- Touch **Set time** and flick up and down to set your phone's time.
- Touch **Select time zone** and select the time zone from the list. Scroll up or down to view more time zones.
- Select or clear the **Use 24-hour format** check box to switch between the 12-hour and 24-hour formats.
- Touch **Select date format** to select how you want the date to be displayed.

Changing the system language

1. On the home screen, touch **Settings** then the **All** tab.
2. Under **PERSONAL**, touch **Language & input**.
3. Touch **Language**.
4. From the list, choose a language.

Modifying location service settings

You can modify your phone's location service settings for more convenient positioning and navigation services.

1. On the home screen, touch **Settings** then the **All** tab.
2. Under **PERSONAL**, touch **Location access**.
3. From the settings screen, you can:
 - Touch **Access my location** to enable your phone to use your location information.
 - Touch **GPS satellites** to have your phone obtain your location information from GPS satellites.

- Touch **Wireless networks** to have your phone obtain your location information from a Wi-Fi network or mobile data connection.

Restoring factory settings

Restoring your phone to its factory settings erases all your personal data from the phone, including your email accounts, system and application settings, and installed applications.

 Back up important data on your phone before you restore factory settings.

1. On the home screen, touch **Settings** then the **All** tab.
2. Under **PERSONAL**, touch **Backup & reset**.
3. Touch **Factory data reset** > **Reset phone** > **Reset phone**.
The phone will restore its factory settings and restart.

Online update

Once in a while, new updates for your phone will be available online. You will receive a notification when updates are available. Before updating, make sure your phone has enough storage space for the update package.

To update your phone manually, go to the home screen, touch **Settings** > **About phone** > **System Update** > **Online update** to check for updates, and follow the onscreen instructions to update your phone online.

 All your personal data may be erased during a system update. It is recommended that you back up important data before updating your phone.

Legal Notice

Copyright © Huawei Technologies Co., Ltd. 2014. All rights reserved.

No part of this manual may be reproduced or transmitted in any form or by any means without prior written consent of Huawei Technologies Co., Ltd. and its affiliates ("Huawei").

The product described in this manual may include copyrighted software of Huawei and possible licensors. Customers shall not in any manner reproduce, distribute, modify, decompile, disassemble, decrypt, extract, reverse engineer, lease, assign, or sublicense the said software, unless such restrictions are prohibited by applicable laws or such actions are approved by respective copyright holders.

Trademarks and Permissions



HUAWEI, HUAWEI,



and are trademarks or registered trademarks of Huawei Technologies Co., Ltd.

Android™ is a trademark of Google Inc.

The *Bluetooth*® word mark and logos are registered trademarks owned by *Bluetooth SIG, Inc.* and any use of such marks by Huawei Technologies Co., Ltd. is under license.

Other trademarks, product, service and company names mentioned may be the property of their respective owners.

Notice

Some features of the product and its accessories described herein rely on the software installed, capacities and settings of local network, and therefore may not be activated or may be limited by local network operators or network service providers.

Thus, the descriptions herein may not exactly match the product or its accessories which you purchase.

Huawei reserves the right to change or modify any information or specifications contained in this manual without prior notice and without any liability.

Third-Party Software Statement

Huawei does not own the intellectual property of the third-party software and applications that are delivered with this product. Therefore, Huawei will not provide any warranty of any kind for third party software and applications. Neither will Huawei provide support to customers who use third-party software and applications, nor be responsible or liable for the functions or performance of third-party software and applications.

Third-party software and applications services may be interrupted or terminated at any time, and Huawei does not guarantee the availability of any content or service. Third-party service providers provide content and services through network or transmission tools outside of the control of Huawei. To the greatest extent permitted by applicable law, it is explicitly stated that Huawei shall not compensate or be liable for services provided by third-party service providers, or the interruption or termination of third-party contents or services.

Huawei shall not be responsible for the legality, quality, or any other aspects of any software installed on this product, or for any uploaded or downloaded third-party works in any form, including but not limited to texts, images, videos, or software etc. Customers shall bear the risk for any and all effects, including incompatibility between the software and this product, which result from installing software or uploading or downloading the third-party works.

This product is based on the open-source Android™ platform. Huawei has made necessary changes to the platform. Therefore, this product may not support all the functions that are supported by the standard Android platform or may be incompatible with third-party software. Huawei does not provide any warranty or representation in connect with any such compatibility and expressly excludes all liability in connection with such matters.

DISCLAIMER

ALL CONTENTS OF THIS MANUAL ARE PROVIDED "AS IS". EXCEPT AS REQUIRED BY APPLICABLE LAWS, NO WARRANTIES OF ANY KIND, EITHER EXPRESS OR IMPLIED, INCLUDING BUT NOT LIMITED TO, THE IMPLIED WARRANTIES OF MERCHANTABILITY AND FITNESS FOR A PARTICULAR PURPOSE, ARE MADE IN RELATION TO THE ACCURACY, RELIABILITY OR CONTENTS OF THIS MANUAL.

TO THE MAXIMUM EXTENT PERMITTED BY APPLICABLE LAW, IN NO EVENT SHALL HUAWEI BE LIABLE FOR ANY SPECIAL, INCIDENTAL, INDIRECT, OR CONSEQUENTIAL DAMAGES, OR LOSS OF PROFITS, BUSINESS, REVENUE, DATA, GOODWILL SAVINGS OR ANTICIPATED SAVINGS REGARDLESS OF WHETHER SUCH LOSSES ARE FORSEEABLE OR NOT.

THE MAXIMUM LIABILITY (THIS LIMITATION SHALL NOT APPLY TO LIABILITY FOR PERSONAL INJURY TO THE EXTENT APPLICABLE LAW PROHIBITS SUCH A LIMITATION) OF HUAWEI ARISING FROM THE USE OF THE PRODUCT DESCRIBED IN THIS MANUAL SHALL BE LIMITED TO THE AMOUNT PAID BY CUSTOMERS FOR THE PURCHASE OF THIS PRODUCT.

Import and Export Regulations

Customers shall comply with all applicable export or import laws and regulations and be responsible to obtain all necessary governmental permits and licenses in order to export, re-export or import the product mentioned in this manual including the software and technical data therein.

Privacy Policy

To better understand how we protect your personal information, please see the privacy policy at <http://consumer.huawei.com/privacy-policy>.

This guide is for reference only. The actual product, including but not limited to the color, size, and screen layout, may vary. All statements, information, and recommendations in this guide do not constitute a warranty of any kind, express or implied.



For DTS patents, see <http://patents.dts.com>. Manufactured under license from DTS Licensing Limited. DTS, the Symbol, & DTS and the Symbol together are registered trademarks, and DTS Sound is a trademark of DTS, Inc. © DTS, Inc. All Rights Reserved.

Please visit <http://consumer.huawei.com/en/support/hotline> for recently updated hotline and email address in your country or region.

Model: HUAWEI G6-U10
HUAWEI G6-U251
HUAWEI G6-U34

V100R001_01