

Setting Up Your Phone

Installing the Battery

Switch off your phone before installing or replacing the battery. The microSD™ card is optional and can be installed and removed while the phone is turned on. Unmount the microSD card before removing it.

- Place your finger in the slot at the bottom of the back cover to lift and remove the cover.
- Insert the battery by aligning the contacts on the battery with the gold contacts in the battery compartment.
- Gently push down on the battery until it clicks into place.

WARNING! Do not handle a damaged or leaking Li-Ion battery as you can be burned.

Installing the microSD Card

You have the option to install a microSD card of up to 32 GB to expand your phone's storage capacity.

- Hold your microSD card with the metal contacts facing down and slide it into the microSD card slot.
- Press the cover gently back into place until you hear a click.

NOTE: Your phone may come with a pre-installed microSD card. Some applications may not function normally after you remove the card, pre-installed or otherwise.

Getting to Know Your Phone



Notifications

The status bar at the top of the screen displays phone and service status with various icons on the right side. Below are some of the icons and their meanings.

Checking Phone Status

	No signal		Signal strength
	3G connected		CDMA connected
	Roaming		Mobile data in use
	Bluetooth on		Wired headset connected
	Ringer off		Connected to a Wi-Fi network
	Vibrate mode		Wi-Fi in use
	Battery low		Speaker on
	Battery partially drained		Phone microphone off
	Battery full		Alarm set
	Battery charging		Flight mode

Managing Notifications

	New SMS		microSD card unmounted
	New MMS		microSD card removed
	New Email		Upcoming event
	New Gmail message		Call on hold
	Updates available		New Wi-Fi network detected
	Problem with SMS/MMS delivery		Downloading/Saving/Download data
	Missed call		Sending data
	Call in progress		GPS on
	USB connected		Song is playing

For Your Safety

Radio Frequency (RF) Energy

This model phone meets the government's requirements for exposure to radio waves. This phone is designed and manufactured not to exceed the emission limits for exposure to radio frequency (RF) energy set by the Federal Communications Commission of the U.S. Government:
The exposure standard for wireless mobile phones employs a unit of measurement known as the Specific Absorption Rate, or SAR. The SAR limit set by the FCC is 1.6W/kg. *Tests for SAR are conducted using standard operating positions accepted by the FCC with the phone transmitting at its highest certified power level in all tested frequency bands. Although the SAR is determined at the highest certified power level, the actual SAR level of the phone while operating can be well below the maximum value. This is because the phone is designed to operate at multiple power levels so as to use only the power required to reach the network. In general, the closer you are to a wireless base station antenna, the lower the power output. The highest SAR values for this model phone as reported to the FCC when tested for use at the ear and on the body are:
Head: 1.04 W/kg, Body: 1.18 W/kg
(Body-worn measurements differ among phone models, depending upon available enhancements and FCC requirements.)
While there may be differences between the SAR levels of various phones and at various positions, they all meet the government requirement.
The FCC has granted an Equipment Authorization for this model phone with all reported SAR levels evaluated as in compliance with the FCC RF exposure guidelines. SAR information on this model phone is on file with the FCC and can be found under the Display Grant section of <http://www.fcc.gov/oet/ea/fccid> after searching on FCC ID: **Q78-Z796C**.
For body-worn operation, this phone has been tested and meets the FCC RF exposure guidelines for use with an accessory that contains no metal and positions the handset a minimum of 0.6 inches (1.5 cm) from the body. Use of other enhancements may not ensure compliance with FCC RF exposure guidelines. If you do not use a body-worn accessory and are not holding the phone at the ear, position the handset a minimum of 0.6 inches (1.5 cm) from your body when the phone is switched on.

FCC Compliance

This device complies with part 15 of the FCC Rules. Operation is subject to the following two conditions: (1) This device may not cause harmful interference, and (2) this device must accept any interference received, including interference that may cause undesired operation.
*In the United States and Canada, the SAR limit for mobile phones used by the public is 1.6 watts/kg (W/kg) averaged over one gram of tissue. The standard incorporates a substantial margin of safety to give additional protection for the public and to account for any variations in measurements.

For Your Safety (continued)

between a mobile phone and a pacemaker to avoid potential interference with the pacemaker. To achieve this, use the phone on the opposite ear to your pacemaker and do not carry it in a breast pocket.

Hearing Aids

People with hearing aids or other cochlear implants may experience interfering noises when using wireless devices or when one is nearby.

The level of interference will depend on the type of hearing device and the distance from the interference source, increasing the separation between them may reduce the interference. You may also consult your hearing aid manufacturer to discuss alternatives.

Medical Devices

Please consult your doctor and the device manufacturer to determine if operation of your phone may interfere with the operation of your medical device.

Hospitals

Switch off your wireless device when requested to do so in hospitals, clinics or health care facilities. These requests are designed to prevent possible interference with sensitive medical equipment.

Aircraft

Switch off your wireless device whenever you are instructed to do so by airport or airline staff. Consult the airline staff about the use of wireless devices on board the aircraft. If your device offers a "flight mode," this must be enabled prior to boarding an aircraft.

Interference in Cars

Please note that because of possible interference to electronic equipment, some vehicle manufacturers forbid the use of mobile phones in their vehicles unless a hands-free kit with an external antenna is included in the installation.

Explosive Environments

Gas Stations and Explosive Atmospheres

In locations with potentially explosive atmospheres, obey all posted signs to turn off wireless devices such as your phone or other radio equipment.

Areas with potentially explosive atmospheres include fueling areas, below decks on boats, fuel or chemical transfer or storage facilities, areas where the air contains chemicals or particles, such as grain, dust, or metal powders.

Blasting Caps and Areas

Power off your mobile phone or wireless device when in a blasting area or in areas posted power off "two-way radios" or "electronic devices" to avoid interfering with blasting operations.

Touch Screen and Navigation Keys

- Power/Lock Key:** Press and hold to power on, select phone modes, turn on/off airplane mode, or power off. Press to turn on/off the screen display.
- Home Key:** Tap to return to the home screen from any application or screen. Tap and hold to see recently used applications.
- Menu Key:** Tap to get the options for the current screen.
- Back Key:** Tap to go to the previous screen.
- Volume Keys:** Press and hold to turn the volume up or down.

Opening Applications

- Press the **Home** key. If the current screen is not the home screen.
- Tap **App Drawer**.
- Slide left or right on the screen and tap an app to open it.

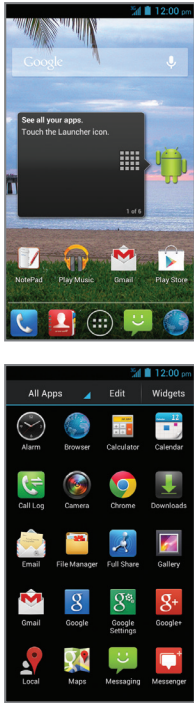

Internet

Connecting via Wi-Fi®

- From the home screen, press **Menu** > **System settings** > **Wi-Fi**.
- Slide the **ON/OFF** switch if Wi-Fi is off. Your phone automatically searches for Wi-Fi networks in range and displays their names and security settings. Your phone also connects to previously linked networks when they are in range.
- Tap a network name to connect to it.
- If the network is secured, enter a password or other credentials. (Ask your network administrator for details.)

Connecting via Mobile Network

- From the home screen, press **Menu** > **System settings** > **Mobile networks**.
- Check **Data enabled**.

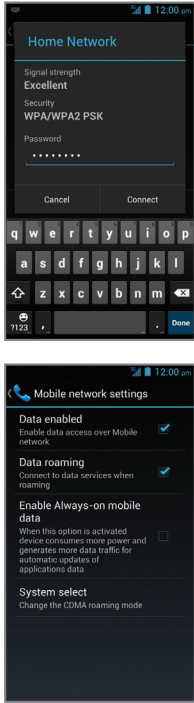

CAUTION: Changes or modifications not expressly approved by the manufacturer could void the user's authority to operate the equipment.

NOTE: This equipment has been tested and found to comply with the limits for a Class B digital device, pursuant to part 15 of the FCC Rules. These limits are designed to provide reasonable protection against harmful interference in a residential installation. This equipment generates, uses and can radiate radio frequency energy and, if not installed and used in accordance with the instructions, may cause harmful interference to radio communications. However, there is no guarantee that interference will not occur in a particular installation. If this equipment does cause harmful interference to radio or television reception, which can be determined by turning the equipment off and on, the user is encouraged to try to correct the interference by one or more of the following measures:

- Reorient or relocate the receiving antenna.
- Increase the separation between the equipment and receiver.
- Connect the equipment into an outlet on a circuit different from that to which the receiver is connected.
- Consult the dealer or an experienced radio/TV technician for help.

Road Safety

Driving

Full attention must be given to driving at all times in order to reduce the risk of an accident. Using a phone while driving (even with a hands-free kit) can cause distraction and lead to an accident. You must comply with local laws and regulations restricting the use of wireless devices while driving.

Operating Machinery

Full attention must be given to operating the machinery in order to reduce the risk of an accident.

Product Handling

General Statement on Handling and Use

You alone are responsible for how you use your phone and any consequences of its use. You must always switch off your phone wherever the use of a phone is prohibited. Use of your phone is subject to safety measures designed to protect users and their environment.
• Always treat your phone and its accessories with care and keep it in a clean and dust-free place.
• Do not expose your phone or its accessories to open flames or lit tobacco products.
• Do not expose your phone or its accessories to liquid, moisture, or high humidity.
• Do not drop, throw, or try to bend your phone or its accessories.
• Do not use harsh chemicals, cleaning solvents, or aerosols to clean the device or its accessories.
• Do not paint your phone or its accessories.
• Do not attempt to disassemble your phone or its accessories; only authorized personnel can do so.

Calling and Voicemail

Making a Call

- From the home screen, tap **Phone**.
- In the dialer, enter the phone number with the on-screen keypad. Tap **Call** to delete incorrect digits.
- Tap **Call** to place the call.

NOTE: To call a contact, press **Menu** > **Contacts** and tap **Call**.

Checking Voicemail

- From the home screen, tap **Phone**.
- In the dialer, tap and hold the **1 Key**. If prompted, enter your voicemail password.
- Follow the voice prompts to listen to and manage your voicemail messages.

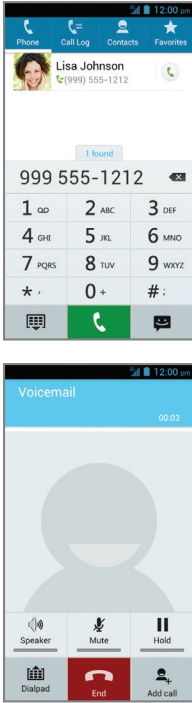

Customizing Home Screens

You can customize your home screen by adding application shortcuts, folders, widgets, and more.

Adding Shortcuts or Widgets

- From the home screen, tap **App Drawer**.
- If you want to add a widget, tap **Widgets**.
- Tap and hold a widget or an app icon and drag it to the home screen.

Removing Shortcuts or Widgets

- Tap and hold a widget or shortcut on the home screen.
- Drag it to **Remove** to remove it.

Organizing Shortcuts With Folders

- Tap and hold a shortcut on the home screen.
- Drag it to **Folder** at the top of the screen. A new folder is created.
- If needed, drag more shortcuts and drop them into the folder.

Applying New Wallpapers

- From the home screen, press **Menu** > **Wallpaper**.
- Tap **Home** or **Lock screen**.
- Select a wallpaper source from **Gallery**, **Live Wallpapers**, or **Wallpapers** and choose an image.
- Tap **OK** at the top of the screen (for Gallery images) or **Set Wallpaper**.

NOTE: Swipe left/right to see additional home screens.

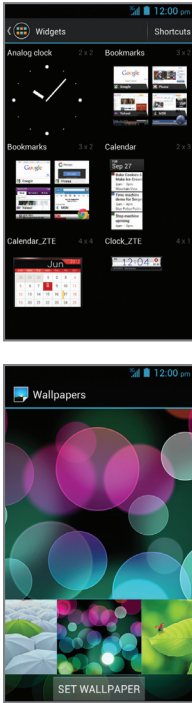

Email

Setting Up Gmail™

- From the home screen, tap **Menu** > **Settings** > **Accounts**.
- If another Gmail account is already set up, press **Menu** > **Settings** > **Add Account**.
- Tap **Existing** to sign in to your existing Google™ account. If you have no Google accounts, tap **New** to create one.
- Follow the instructions on the screen to set up the account.

Setting Up Email

- From the home screen, tap **Menu** > **Settings**.
- If another email account is already set up, press **Menu** > **Settings** > **Add Account**.
- Enter the email address and password.
- Tap **Next** and follow the onscreen instructions.

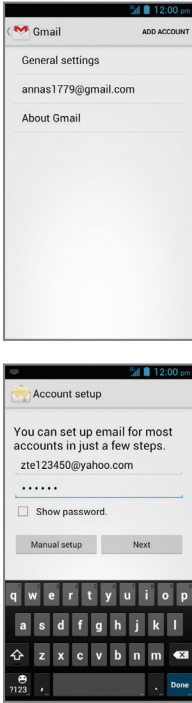

NOTE: Contact your IT administrator to help set up your corporate Microsoft® Exchange account.

- Do not expose your phone or its accessories to extreme temperatures, minimum 23° F and maximum 122° F (minimum -5° C and maximum +50° C).
- Please check local regulations for disposal of electronic products.
- Do not carry your phone in your back pocket as it could break when you sit down.

Small Children

Do not leave your phone and its accessories within the reach of small children or allow them to play with it. They could hurt themselves or others, or could accidentally damage the phone.

Your phone contains small parts with sharp edges that may cause an injury or may become detached and create a choking hazard.

Demagnetization

To avoid the risk of demagnetization, do not allow electronic devices or magnetic media close to your phone for a long time.

Electrostatic Discharge (ESD)

Do not touch the SIM card's metal connectors.

Antenna

Do not touch the antenna unnecessarily.

Normal Use Position

When placing or receiving a phone call, hold your phone to your ear, with the bottom toward your mouth.

Air Bags

Do not place a phone in the area over an air bag or in the air bag deployment area.

Store the phone safely before driving your vehicle.

Seizures/Blackouts

The phone can produce a bright or flashing light.

Repetitive Stress Injuries

To minimize the risk of RSI when texting or playing games with your phone:

Do not grip the phone too tightly.

Press the buttons lightly.

Use the special features which are designed to minimize the times of pressing buttons, such as Message

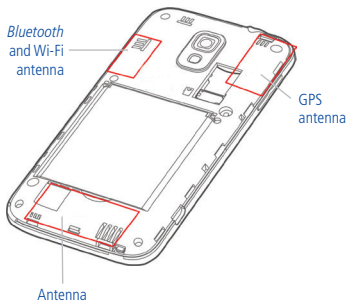

Text Messaging

- From the home screen, tap **Messages**.
- Enter the recipient(s) and message text. If you want to send an MMS, add a subject and attachments.
- Tap **Send** to send the message.

Please don't text and drive.

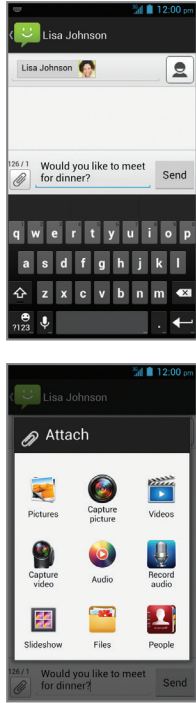

Templates and Predictive Text.

Take lots of breaks to stretch and relax.

Emergency Calls

This phone, like any wireless phone, operates using radio signals, which cannot guarantee connection in all conditions. Therefore, you must never rely solely on any wireless phone for emergency communications.

Loud Noise

This phone is capable of producing loud noises, which may damage your hearing. Turn down the volume before using headphones, Bluetooth stereo headsets or other audio devices.

Phone Heating

Your phone may become warm during charging and during normal use.

Electrical Safety

Accessories

Use only approved accessories.

Do not connect with incompatible products or accessories.

Take care not to touch or allow metal objects, such as coins or key rings, to contact or short-circuit in the battery terminals.

Connection to a Car

Seek professional advice when connecting a phone interface to the vehicle electrical system.

Faulty and Damaged Products

Do not attempt to disassemble the phone or its accessories.

Only qualified personnel can service or repair the phone or its accessories.

If your phone or its accessory has been submerged in water, punctured, or subjected to a severe fall, do not use it until you have taken it to be checked at an authorized service center.

Interference

General Statement on Interference

Care must be taken when using the phone in close proximity to personal medical devices, such as pacemakers and hearing aids.

Pacemakers

Pacemaker manufacturers recommend that a minimum separation of 6 inches (15 cm) be maintained

Playing Music

- From the home screen, tap **Music**.
- Tap a category, such as Artists or Albums, to find the song you want to play.
- Tap the song to play it. When the song is playing, tap the album artwork to display more options.

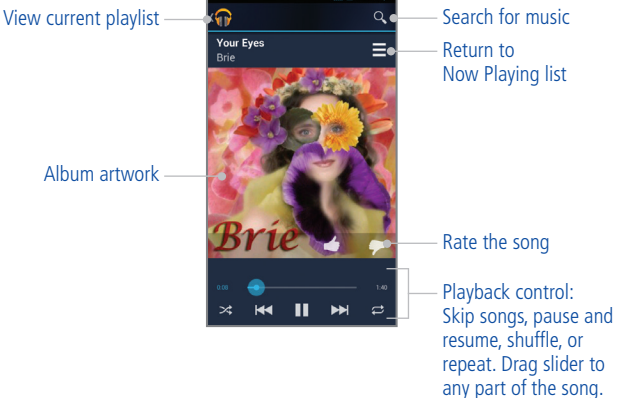

Camera and Video

Taking a Photo

- From the home screen, tap **Menu** > **Camera**.
- Aim the camera at the subject and make any necessary adjustments.
- Lightly tap **Shutter** or press a **Volume Key**.

Recording a Video

- From the home screen, tap **Menu** > **Video**.
- Switch to the camcorder mode.
- Aim the camera at the subject and make any necessary adjustments.
- Tap **Shutter** to start and **Stop** to stop recording.

TIP: While the recording is in progress, you can tap **Shutter** to save the frame as a photo.

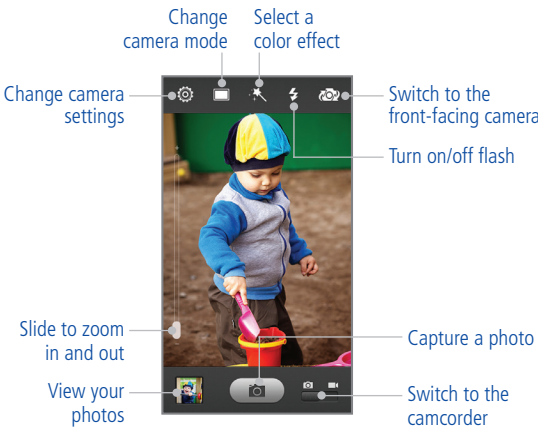

Google Play™

Google Play has tens of thousands of games and applications for you to enjoy. Before you begin, make sure that you are signed in to your Google account.

- From the home screen, tap **Play Store**.
- Find the apps you need either by category or by tapping **Search**.
- Tap the app to see a more detailed description.
- Tap **Install**.
- Read the app permissions and tap **Accept**.
CAUTION: Once installed, some apps can access many functions of a significant amount of your personal data. The Play Store will show you what the app can access.
- For paid apps, tap **Continue** and follow additional on-screen instructions for payment.
- Wait for the app to be downloaded and installed automatically. Payment needs to be authorized before paid apps start downloading.
- The app is successfully installed when the **Get** icon appears in the status bar. You can find the new app after pressing **Menu** > **App Drawer**.

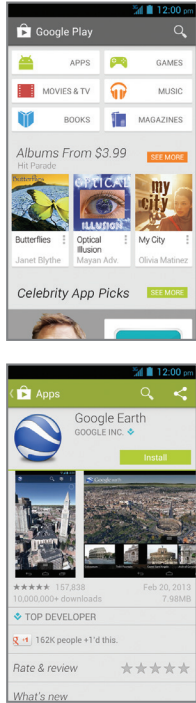

NOTE: The content you can access in the Play Store depends on your region and your service provider.

Connectivity

Connecting With a Bluetooth® Headset

Turn on the **Bluetooth** headset and switch it to pairing mode. Refer to the headset's user guide for more information.

- From the home screen, tap **Menu** > **System settings** > **Bluetooth**.
- Slide the **ON/OFF** switch if **Bluetooth** is off. When **Bluetooth** is on, the **Bluetooth** icon appears in the status bar.
- NOTE:** Your phone automatically scans for and displays the IDs of all available **Bluetooth** devices in range. You could tap **Search For Devices** if you wanted to scan again.
- Tap the ID of the headset, or any other device you want to pair with your phone. Enter a passcode if prompted.

TIP: Tap the ID again to end the connection.

